



Caribbean &
Latin America
COLLECTION
Winter 2020-2021 cruises





Setting sail for the New World

The Virgin Islands, the Sea of Cortez, Machu Picchu, Patagonia... from the Caribbean to Latin America, board one of our ships during our 2020-2021 season and sail towards these New World territories that fired the imagination of so many adventurers.

PONANT meets your desires for new horizons: crossing the Panama Canal, the idyllic beaches of the West Indies, meeting the authentic and welcoming Kuna Indians of the San Blas Islands, the Maya remains of Yucatán, the glaciers of Patagonia, the huge wild expanses of the Andes cordillera, sailing the meanders of the mighty Amazon River... And throughout your cruise, you will enjoy the perfect alchemy of luxury, comfort and adventure, an intimate atmosphere and refinement, on board.

Fascinating itineraries and land-based programmes give prominence to cultural discoveries by letting you access almost thirty UNESCO-listed sites, from the legendary remains of the pre-Colombian civilisations to colonial towns that still seem to bear the footsteps of the conquistadors.

Do you have a thirst for adventure? One of our expedition cruises in the company of our naturalist guides and the experts, in conjunction with our partner National Geographic Expeditions, will provide you with the occasion for unforgettable Zodiac® outings taking you as close as possible to the most unspoiled nature.

If you are feeling sporty, you will also be able to enjoy diving and snorkelling, unless, comfortably ensconced on the outer decks, you would just prefer to admire the charming landscapes... you will find a foretaste of these on the following pages...

We hope to welcome you on board very soon!

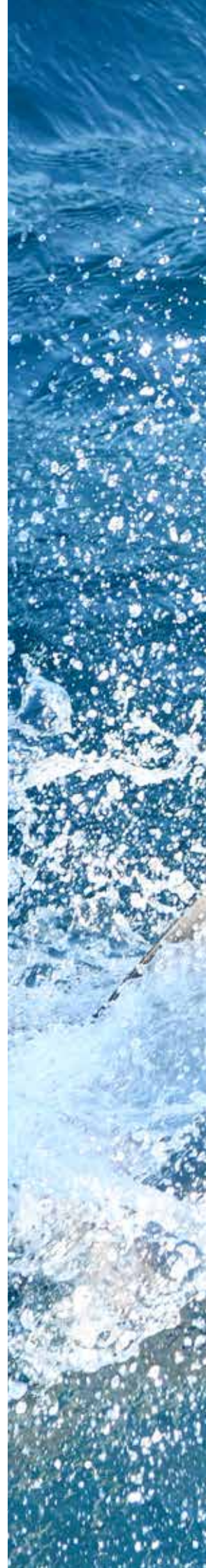

Summary

Itinerary Calendar.....	6
Why Travel to the Caribbean and Latin America with PONANT	8
Luxury Expeditions by PONANT	10
Caribbean & Latin America.....	12
Regions in the Spotlight	14
Longing for the Caribbean & Latin America.....	18
Your Itineraries.....	26
Shore Excursion Highlights	46
Pre-Bookable Excursions	48
Pre & post cruise Programmes	50
The PONANT Fleet.....	52
Price List.....	62
Formalities.....	65
General Terms and Conditions of Sale.....	66
Particular Terms and Conditions of Sale.....	70



Your Cruises in *The Caribbean and Latin America*





POLAR EXPEDITION



TROPICAL EXPEDITION

NATIONAL GEOGRAPHIC | PONANT EXPEDITIONS

	DEPARTURE	SHIP	ITINERARY	NIGHTS	REFERENCE*		PAGE
SEPT.	13th September 2020	<i>Le Soléal</i>	San Diego • Puerto Quetzal	13	S130920	The Sea of Cortez	40
	26th September 2020	<i>Le Soléal</i>	Puerto Quetzal • Guayaquil	13	S260920	Natural Wonders of Central America	38
OCTOBER	7th October 2020	<i>L'Austral</i>	San Diego • Puerto Quetzal	12	A071020	The Sea of Cortez	40
	9th October 2020	<i>Le Soléal</i>	Guayaquil • Talcahuano	13	S091020	Cordillera & Andean Secrets	42
	19th October 2020	<i>L'Austral</i>	Puerto Quetzal • Callao	12	A191020	Jewels of Latin America	43
	22nd October 2020	<i>Le Soléal</i>	Talcahuano • Ushuaia	12	S221020	Adventure in Patagonia	44
NOVEMBER	3rd November 2020	<i>Le Champlain</i>	Puerto Morelos • Puerto Morelos	7	C031120	Natural & Cultural Wonders of the Western Caribbean	34
	10th November 2020	<i>Le Champlain</i>	Puerto Morelos • Puerto Morelos	7	C101120	Maya Treasure of the Yucatan	35
	17th November 2020	<i>Le Champlain</i>	Puerto Morelos • Puerto Morelos	7	C171120	Natural & Cultural Wonders of the Western Caribbean	34
	17th November 2020	<i>Le Dumont-d'Urville</i>	Cayenne • Cayenne	12	U171120	Discover the Amazon	26
	18th November 2020	<i>L'Austral</i>	Talcahuano • Ushuaia	10	A181120	In the heart of Chilean Fjords	45
	24th November 2020	<i>Le Champlain</i>	Puerto Morelos • Puerto Morelos	7	C241120	Maya Treasure of the Yucatán	35
	29th November 2020	<i>Le Dumont-d'Urville</i>	Cayenne • Cayenne	12	U291120	Discover the Amazon	26
DECEMBER	1st December 2020	<i>Le Champlain</i>	Puerto Morelos • Puerto Morelos	7	C011220	Natural & Cultural Wonders of the Western Caribbean	34
	8th December 2020	<i>Le Champlain</i>	Puerto Morelos • Puerto Morelos	7	C081220	Maya Treasure of the Yucatán	35
	11th December 2020	<i>Le Dumont-d'Urville</i>	Cayenne • Fort-de-France	12	U111220	The Caribbean & Amazon River	27
	15th December 2020	<i>Le Champlain</i>	Puerto Morelos • Puerto Morelos	7	C151220	Natural & Cultural Wonders of the Western Caribbean	34
	22th December 2020	<i>Le Champlain</i>	Puerto Morelos • Colón	7	C221220	Christmas between Mexico and Panama	36
	23rd December 2020	<i>Le Dumont-d'Urville</i>	Fort-de-France • Colón	12	U231220	Christmas in the Caribbean	29
29th December 2020	<i>Le Champlain</i>	Colón • Puerto Caldera	7	C291220	Natural & Cultural History of Central America	39	
JANUARY	4th January 2021	<i>Le Dumont-d'Urville</i>	Colón • Puerto Caldera	7	U040121	Natural & Cultural History of Central America	39
	5th January 2021	<i>Le Champlain</i>	Puerto Caldera • Colón	7	C050121	Natural & Cultural History of Central America	39
	12th January 2021	<i>Le Champlain</i>	Colón • Fort-de-France	9	C120121	Between Panama & Martinique	33
	21st January 2021	<i>Le Champlain</i>	Fort-de-France • Fort-de-France	8	C210121	Jewels of the Caribbean	31
	29st January 2021	<i>Le Champlain</i>	Fort-de-France • Fort-de-France	8	C290121	Pearls of the Caribbean	30
FEBRUARY	20th February 2021	<i>Le Champlain</i>	Fort-de-France • Fort-de-France	8	C200221	Pearls of the Caribbean	30
	28th February 2021	<i>Le Champlain</i>	Fort-de-France • Fort-de-France	8	C280221	Jewels of the Caribbean	31
MARCH	1st March 2021	<i>Le Dumont-d'Urville</i>	Colón • Fort-de-France	9	U010321	Between Panama & Martinique	33
	2nd March 2021	<i>Le Boréal</i>	Ushuaia • Talcahuano	12	B020321	Adventure in Patagonia	44
	5th March 2021	<i>Le Soléal</i>	Ushuaia • Talcahuano	12	S050321	Adventure in Patagonia	44
	8th March 2021	<i>Le Champlain</i>	Fort-de-France • Fort-de-France	8	C080321	Pearls of the Caribbean	30
	10th March 2021	<i>Le Dumont-d'Urville</i>	Fort-de-France • Cayenne	10	U100321	The Caribbean & French Guiana	28
	14th March 2021	<i>Le Boréal</i>	Talcahuano • Guayaquil	13	B140321	Cordillera & Andean Secrets	42
	20th March 2021	<i>Le Dumont-d'Urville</i>	Cayenne • Cayenne	12	U200321	Discover the Amazon	26
27th March 2021	<i>Le Boréal</i>	Guayaquil • Colón	13	B270321	Treasures of Central America	37	
APRIL	1st April 2021	<i>Le Dumont-d'Urville</i>	Cayenne • Cayenne	12	U010421	Discover the Amazon	26
	9th April 2021	<i>Le Boréal</i>	Colón • Miami	11	B090421	Treasures of the Caribbean Sea	32
	20th April 2021	<i>Le Boréal</i>	Miami • Lisbon	14	B200421	Transatlantic Voyage from Miami to Lisbon	41

*This reference number allows you to easily find the cruise on our website www.ponant.com

Why Travel to the Caribbean
and Latin America with

PONANT





Is your dream to travel differently, moving from destination to destination, enjoying the discovery of remote locations inaccessible to large ships? Set sail with PONANT for an exceptional cruise to discover Latin America, a land of contrasts that stretches from Mexico to the lower latitudes of the far south, but also to the Caribbean, with its idyllic islands and pristine inlets, ideal places to moor.

Because cruising doesn't mean just seeing the coastline, we offer a different perspective with a range of trips rich in culture and experiences.

So, set sail on one of our cruises, to discover the many vestiges of the mysterious pre-Columbian civilisations, the rich architectural heritage of the colonial period and the picture-postcard beaches of the Caribbean islands.

Or, perhaps you would rather join one of our expedition cruises, in the heart of the Chilean fjords and in the Amazon region, where your ship will have a surprise in store for you every day - something unexpected, a unique encounter, an impromptu trip in a Zodiac®... a starting point for adventure.

These exceptional itineraries are completed by cultural programmes before, during and after your cruise, as well as a varied selection of excursions. During your stopovers, you will meet the fascinating people of Latin America. Originating from different cultures and various blends of these, they form an ethnic mosaic like none other and will share with you the immense richness of their history.

Select your itinerary and set sail aboard one of our modern small ships to discover these wild and fragile, fascinating and welcoming lands of vast open spaces. PONANT has its heart set on protecting this exceptional natural and cultural heritage through its commitment to sustainable development and its close collaboration with local communities.



The "PONANT" signature at the heart of the Caribbean and Latin America

- 38 cruises travelling through 33 countries in the Caribbean and Latin America.
- 16 luxury Expedition cruises, to discover mysterious Chilean Fjords, the great Amazon river and national parks of Central America.
- Exceptional moments of sharing with local populations.
- Diving and snorkelling with an experienced instructor (cruises with the "Diving" logo).
- 27 ports of call listed as UNESCO World Heritage Sites.
- 11 major pre-Columbian era sites.
- "Cleanship" certified ships that are respectful of the environment.
- On all departures, a team of Naturalists and/or Lecturers, selected for their areas of expertise.

Ponant, World Leader of Luxury Expeditions

Choosing a PONANT Expedition cruise means choosing a state of mind: a blend of luxury and experiences, exploration and great comfort, adventure and refinement... even in the heart of the most remote regions.

Polar, or tropical expeditions: from the Chilean fjords to the meanders of the Amazon river, PONANT will take you as close as possible to pristine nature and ancestral cultures, far from the crowded maritime routes. So, whether you join every outing or prefer to admire the spectacle from the ship's deck, surrender to your appetite for discovery, in the heart of the most unspoiled places on our planet.



Luxury amenities...

An expedition with PONANT assures a relaxed on board ambiance for you in some of the most remote places on the planet. The comfort of your ship and your stateroom, personalised and attentive service, refined gastronomy... the unique atmosphere which we go to great lengths to preserve in order to stay true to our philosophy, creating that privileged feeling of being aboard one's own private yacht. In the heart of Latin America, our luxury amenities will make your voyage into an unforgettable experience.



... in the heart of extreme lands

Whether in the mysterious Chilean fjords, the heart of the San Blas Archipelago or the Amazon river, the compact size of our ships and their shallow draught mean you can venture as close as possible to these hard-to-access areas. This proximity offers the privileged discovery of preserved sites. Our expedition teams are always on the lookout for the unexpected and the surprises inherent to these itineraries, and our flexibility enables us to adapt to these. A genuine philosophy of expedition travel.





Zodiac® shore visits and outings

During Expedition voyages, our fleet of Zodiac® make landing ashore in remote, seldom visited destinations safe and enjoyable, and enable guests to get as close as possible to ice and fauna. Our Zodiac® are designed to accommodate small groups of 10 guests. They are easy to step on to from the marina platform at the rear of your ship. Our inclusive Zodiac® excursions are unique, unforgettable experiences, whether you are visiting indigenous villages or viewing the imposing glaciers of southern Chile.



An experienced expedition team

Specialists of extreme regions, these passionate and fascinating professionals will bring a cultural or historical dimension to all your outings and will be sure to keep you informed about nearby flora and fauna, local cultures and natural phenomena. As recognised professionals, they organise safe outings and shore visits, taking advantage of the opportunities that arise during any expedition, whilst aboard the ship the pleasure continues, with a series of cultural, scientific or historical presentations.

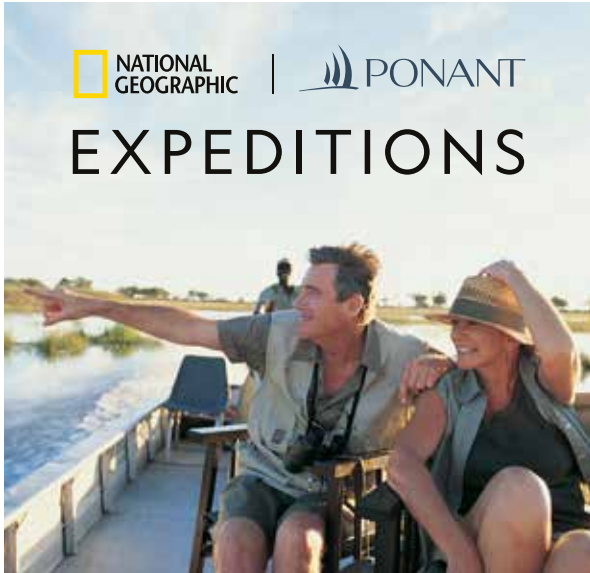

A partnership forged around common values

PONANT, a leader in polar expeditions for almost 20 years, boasts the world's most modern fleet of expedition ships. They are equipped with environmentally responsible devices, which are essential given that we cross fragile areas with unique ecosystems. NATIONAL GEOGRAPHIC, over the past 130 years has sent scientists, storytellers and adventurers across continents and into remote cultures, down to the oceans' depths and up the highest mountains in an effort to better understand our planet. National Geographic Expeditions grew from this legacy to invite others to explore, to encounter the wonders of the world up close. Now National Geographic Expeditions and PONANT have joined forces to offer a selected range of unique expedition cruises to some of the world's most intriguing, remote and pristine destinations, in the very places where the most amazing pages of exploration were written.

All-inclusive expeditions

Once aboard, enjoy the adventure in total peace of mind.

Zodiac® outings and shore visits, excursions, lectures, parkas and boot hire for polar expeditions. Please note that some cruises are not full-expedition cruises, only a few days of expedition are included. Optional additional cost excursions are offered at regular ports of call, available at your own cost.

The Caribbean & Latin America

A surprising mosaic
of landscapes and cultures

Idyllic islands bordered with crystal clear waters, coral reefs sheltering an exceptional underwater world, lush jungle home to a rich biodiversity, volcanos and mountainous terrain sculpted by erosion... In the heart of rich and diverse nature, set off on an exceptional voyage following in the footsteps of the great explorers and conquistadors.







1 - Machu Picchu, Peru
2 - El Brujo Glacier, Chile
2 - *Le Champlain* in the strait of Breves, Amazonia, Brazil





Regions *in the spotlight*

The Andean Cordillera

Running more than 7,000 km along the western coast of South America, from the Caribbean Sea to the Tierra del Fuego, the Andean Cordillera is the longest continental mountain chain in the world and one of the highest. Sailing along these legendary rocky formations will lead you to the gates of the most beautiful sites in Ecuador, Peru and Chile. Between vast desert expanses of the high plateaux, colonial cities lying at the bottom of magnificent valleys and snow-topped summits overlooking sumptuous fjords, the Andes will reveal their countless natural wonders to you. From Coquimbo, venture into the Elqui Valley, an authentic mountainous and winemaking region, with its poetic nickname “Norte Chico” or “the Little North”. Deep in the heart of the Andean mountain chain, the contrast between the arid slopes, the green agricultural plantations and the blue of the sky is remarkable and makes the valley one of the most beautiful of Chile. From Callao, Lima, you will have the opportunity to discover Machu Picchu. The famous “Lost City of the Incas” is perched in the heights of the Andean Cordillera at an altitude of 2 350 m. A literally breathtaking sight.



Patagonia, a land of contrasts

Set off to discover Patagonia: from the arid plains of the Atacama Desert to the vast verdant expanses of the Argentine pampa, via the sheer reliefs of the Andean Cordillera and the magnificent fjords, lakes and glaciers of Tierra del Fuego. A real kaleidoscope of landscapes, the region, which stretches from Chile to Argentina, is reputed for its spectacular panoramas, pristine spaces and authentic charm. Discovered by Ferdinand Magellan in 1525, explored by many adventurers and sparsely populated because of its harsh and extreme climate, this mythical land has never ceased to fascinate. Aboard your ship, you will set off to discover this region on the edge of the world, where nature is at its most grandiose and majestic. During some stopovers, you will have many opportunities to set out aboard our Zodiac® dinghies, piloted by your naturalist guides, to get as close as possible to this untamed natural world, where the presence of human beings is almost imperceptible.

The Amazon rainforest, vegetable and aquatic labyrinth

Despite its image as an impenetrable land, the Amazon can be explored, even when one is not a hardened explorer. Aboard your small luxury expedition PONANT ship, explore the legendary Amazon and journey deep into the heart of this green paradise with the rich exuberance of a wild symphony. It is here, on the outer decks of your ship that you will be able to appreciate this colossal waterway to the full, secret refuge for thousands of animals. Tribes are living here, far from any contact with the city, in harmony with nature. Aboard our Zodiac® dinghies, do not miss the daytime and nocturnal excursions to experience the surrounding environment. You might be able to observe some of the endemic species such as caimans and iguanas or large, easygoing beavers, which will appear at the surface of the water. The boto, or freshwater dolphin is easily identifiable thanks to its magnificent and surprising pink colour. Curious and playful, it may well seek you out, unless its spotlight is stolen by the mischievous capuchins or their cousins. Through the dense branches of the mangroves, keep an eye out for bright colours: macaws, toucans and scarlet ibis live there in their thousands.

The Caribbean, archipelagos sitting atop a turquoise sea

Magical islands, an idyllic setting, and a gentle way of life. . . We invite you to chart a course towards the Caribbean Islands, like scattered pearls showcased against the turquoise water. How can you resist the charm of these picture-postcard islands where the golden beaches lined with coconut trees hug the turquoise sea and where time seems to stretch on to infinity? Here the sea is everywhere. In the south, it outlines the curves of the long sandy beaches that stretch out in the shade of the palm trees, whilst in the north it is topped with white spray to splash at the foot of volcanoes. The Caribbean Sea is truly a paradise for divers, offering an exceptional underwater environment of coral reefs and multicoloured fish for you to admire when enjoying aquatic excursions. During your cruise, discover Dominica, Martinique, or Saint Vincent and the Grenadines, all ports of call offering both natural beauty and an interesting historical heritage.



The Sea of Cortez

In the south of California, a slim desert peninsula advances into the Pacific Ocean, scorched by the sun, a timeless landscape of canyons and cacti... This “Baja California” forms the boundary of the Sea of Cortez, scattered with some 200 hilly islands and islets, formed from red volcanic rock that plunges into the incredibly transparent turquoise sea. Named in honour of the conquistador Hernán Cortés, who was behind several expeditions exploring the region, this vast marine expanse will delight nature lovers with its spectacular panoramas. But it is the breathtaking richness of its aquatic wildlife that earned the Sea of Cortez its listing among the UNESCO World Heritage Sites. From Zodiac® dinghies or on the outer decks of your ship, admire the ballet of the playful sea lions, keep an eye out for sea turtles and the silvery flashes of immense shoals of anchovies. The magic will continue beyond nightfall under the star-filled sky of Mexico.



- 1 - Caribbean Sea Beach
- 2 - Coronado Island, Sea of Cortez, Mexico
- 3 - The emblematic red ara



1



3



2

National Parks of Central America

A natural bridge between the North American continent and Latin America, the Central American isthmus is renowned for sheltering some of the richest biodiversity on the planet. Largely covered in exuberant tropical vegetation, this spit of land is an invitation for escape and exploration. In Panama, Darien National Park is home to an exceptional variety of habitats: sandy beaches, rocky coastlines, mangrove, Marchhes, as well as low - and medium-altitude rainforests providing shelter to a remarkable flora and fauna. Covering some 6,000 km2 and listed as a UNESCO World Heritage Site, this small and isolated corner of paradise hides much unexpected beauty. Aboard our local "cayucas", come and meet the indigenous Emberas community, which still lives cut off from the world, hunting, fishing, cultivating the land and producing colourful crafts. In Costa Rica, Manuel Antonio National Park will reveal its dense fauna composed of birds with multicoloured feathers, monkeys and iguanas.

Longing for *The Caribbean & Latin America*

Longing for...

HEAVENLY BEACHES AND WONDERFUL SEABEDS

Diving in the Caribbean Sea

An incredible feeling of lightness, absolutely silence that is barely broken by the sound of your own breathing, landscapes of almost surreal beauty... this is what you can expect when scuba diving in the warm and crystal-clear waters of the Caribbean Sea. PONANT opens the doors to this fascinating, secret and infinite underwater world that is so close to mankind and yet so mysterious. During your dives, you will be able to admire abundant underwater life: parrotfish, the striped angelfish, graceful sea turtles and stingrays swim elegantly amid gardens of gorgonians and coral reefs. Immersed in this silent world where time seems to stand still, you will discover a wonderful palette of colours and shapes.



Diving with the Experts

All scuba diving excursions of the cruises with the diving logo are accompanied by an experienced instructor. This qualified professional onboard ensures that all activities are conducted smoothly and safely. If local regulations require it, a local guide – in addition to the PONANT instructor – will escort the diving. Beginners will have ideal conditions for their first dive. Moreover, all tropical expedition cruises include snorkelling excursions that are accompanied by your naturalist guides. Equipment is supplied: fins, masks, snorkels for snorkelling, and diving wetsuit, stabilising jackets, regulator with octopus and pressure gauge for scuba diving (diving computers for accredited divers).

Scuba diving is an optional activity that incurs an extra charge.
For more details, please visit our website at www.ponant.com.

Belize - the Blue Hole

Once the lair of pirates and smugglers, nestled between Guatemala and Mexico, Belize is considered to be a veritable Eden. From your port of call at Half Moon Caye, we invite you to set out to discover the mysterious Blue Hole, situated in the middle of the Lighthouse Atoll. This ancient limestone cave submerged by the ocean forms a perfect circle protected by the barrier reef. The Great Blue Hole was made famous by Jacques Cousteau in 1972. Now a UNESCO World Heritage Site, it is considered to be one of the 10 best diving spots in the world. This geological curiosity reveals to you its steep walls where corals and multicoloured fish have taken up residence. Snorkelling through this natural treasure where the marine fauna and flora is intact is an unforgettable experience during a cruise in the Caribbean Sea.

The Grenadines

A stay in the heart of the Grenadines will have you lazing on beaches and flirting with the wind as you hop from island to island. During your cruise, discover Bequia, “the whaler island”, with its unspoiled coastline; Mayreau, the archipelago’s smallest inhabited island; or Tobago Cays: this rosary of uninhabited cays in the southern West Indies the elegant is a marine park that has some outstanding marine fauna in its turquoise lagoons. The long strips of white sand punctuated by coconut trees are an invitation to swim and discover the exceptional seabed. Whether you love to dive or are seeking an escape to peace and quiet, the Grenadines offer myriad isolated bays, protected by a coral reef. A veritable kaleidoscope of colours, inhabited by multicoloured fish and sea turtles.



1 and 2 - Diving in the Caribbean Sea
3 - The Great Blue Hole, Belize
4 - Tobago Cays, the Grenadines

1 - Mérida, Mexico

2 - Santa Catalina Convent, Arequipa, Peru

3 - Antigua, Guatemala

4 - Trujillo, Peru

Longing for... COLONIAL CITIES

Mérida from Progreso

When your ship calls at Progreso, be sure to visit Mérida, capital of the Mexican state of Yucatán. Called “the White City” due to the colour of the limestone used to build its walls and dwellings, this old colonial city, built on the ruins of a Mayan site, offers a pleasant mix of tradition and modernity, colonial architecture and Mayan heritage. Stroll along the magnificent Plaza de la Independencia and visit the beautiful surrounding buildings such as the Cathedral of San Ildefonso, the Bishop’s palace and Casa de los Montejo. The Lucas de Galvez municipal market will provide the opportunity to discover local crafts, in particular hammocks, *huipiles* (tunics embroidered in bright colours) and palm leaf hats.

La Antigua de Guatemala from Puerto Quetzal

From Puerto Quetzal, discover “la Antigua de Guatemala”, located at 1500 m altitude and considered to be one of the most beautiful cities in the country. Famous for its Spanish Baroque and Renaissance style of architecture, it lives to the rhythm of its colonial past. Of its prestigious past, the city has preserved its homes built around vast flower-bedecked courtyards, and its baroque churches. Its cobblestoned streets are edged by houses painted in bright colours and decorated with wrought iron grills, blending the poetic atmosphere and gentle melancholy of the place. A UNESCO World Heritage Site, Antigua is dominated by the silhouettes of its volcanoes and has a unique charm.





Arequipa from Matarani

When we drop anchor in Matarani, discover Arequipa, an old colonial city founded in 1540, Arequipa lies in a fertile valley at the foot of the conical silhouette of the majestic El Misti volcano. The beautiful buildings of the colonial period, built from sillar (a white volcanic rock that sparkles in the sun) have earned the nickname of the "white city". Stroll through the vast maze of flower-bedecked courtyards of the Santa Catalina Convent, its winding streets with their Andalusian names and powder blue walls. Built in the 16th century and a UNESCO World Heritage site, the cloister, which was home to 450 reclusive Carmelites, only recently opened its doors to the public, after four centuries of total isolation. A photographer's paradise, this architectural masterpiece is home to the finest examples of Hispano-American religious art.



Trujillo from Salaverry

Known as the "City of Everlasting Spring" for its particularly mild and sunny climate, Trujillo will charm you with its flamboyant colonial heritage. Founded in 1534 by the conquistadors, the city, now the third-largest town in Peru, is home to magnificent brightly coloured façades, decorated with balconies of sculpted wood. The many civic and religious buildings dating from the Spanish conquest are among the best-preserved colonial architecture in Peru. In the heart of the Historic Centre, surrounded by an impressive wall in the past, the Plaza de Armas will enable you to discover the city's major constructions, such as the Cathedral Basilica of St. Mary, the Municipal Palace and the Archbishop's Palace.

Longing for...

PRE-COLUMBIAN CIVILISATIONS

Chichén Itzá

Jewel of the Yucatán peninsula, in the south of Mexico, the archaeological site of Chichén Itzá is without doubt one of the most beautiful testimonies of Maya civilisation. Founded towards 450 AD by the Mayas, then governed by the Toltecs, this ancient sacred city was discovered in the 19th century. Today a UNESCO World Heritage Site, it is considered to be one of the Seven Wonders of the World. From Progreso, discover the most emblematic buildings, such as the Castillo, a huge stepped pyramid that is considered to be the emblem of the site, the temple of Warriors, the observatory or the ball park.

Cuzco and Machu Picchu

From Callao, the port of Lima, do not miss a visit to Cuzco, the imperial city of the great Inca, Pachacutec. From the Inca fortress of Sacsayhuamán, you will overlook this incredible city, combining Inca ruins and Baroque churches and palaces from colonial times. Then, continue towards the UNESCO World Heritage site of Machu Picchu. This sanctuary, of exceptional cultural and natural value, is encircled by the spectacular Andes Mountains, lying at some 2,400 metres altitude. The mythical “Lost City of the Incas” with its terraced fields and its Sun Temple will not fail to fascinate you, and you will be able to recite the verses composed by Pablo Neruda, the great Chilean poet: *“Machu Picchu is a journey to the serenity of the soul, to eternal merging with the cosmos...another miracle”*.

The Pyramids of Tikal

From Santo Tomás de Castilla or Puerto Quetzal, discover one of the major sites of Mayan civilisation: The Pyramids of Tikal. The imposing vestiges of a vanished culture make a real impression on the traveller; in this very dense jungle, the ruins seem to emerge from the mist. Its ceremonial centre includes superb examples of temples, palaces, steles and sacrificial alters. You will visit the most remarkable buildings such as the Temple of the Great Jaguar, the Temple of the Masks and the Great Plaza. A magical moment combining culture and nature, the Tikal site will allow you to relive some original legends.

Chan Chan and the Pyramids of Moche

When your ship calls at Salaverry in Peru, this is the occasion to discover the vestiges of the Chimú and Mochica civilisations. Chan Chan, the former capital of the Chimú kingdom is the largest adobe citadel in pre-Columbian America, declared a World Heritage Site by UNESCO. Stretching over more than 28 km², the ruins of this immense city reflect the rigorous social and political organisation of a society that had reached its peak; its mastery of irrigation was particularly developed. Further on you will admire the Moche pyramids, the Huaca del Sol and the Huaca de la Luna, decorated with colourful mythological frescoes.



1

- 1 - Chichén Itzá, Mexico
- 2 - Tikal, Guatemala
- 3 - Machu Picchu, Peru
- 4 - Chan Chan, Peru



2



3



4

Longing for...
INTIMATE ENCOUNTERS

Amazonian Indians

Entering Amazonia means discovering a very rich culture, born of the millenary presence of many indigenous tribes. Accompanied by your naturalist guides, set off to meet Amazonian Indians, the last guardians of an ancestral know-how. Not far from Santarem, in a village in the very heart of the tropical forest, you will be welcomed by a family who will show you how they make cassava flour, the staple of the regional diet. You will also be able to observe the original techniques for extracting latex from the rubber tree, and familiarise yourselves with the plants used in traditional pharmacopoeia.

The Embera people

An exceptional chance to journey back in time: discover the Embera Indian tribe, loyal guardians of the forest. This proud people have successfully preserved their traditions and their ancestral way of life which pre-date the colonisation of the region by the Spanish. In Darien National Park, meet this indigenous community. You will take a seat in a traditional dugout boat called piragua and travel upriver. Little by little, huts start to appear, emerging from the vegetation, and the village chief will welcome you to his wild and pristine lands. In order to perfect this magical experience, you will watch traditional ancient dances before learning more about the customs of this very endearing tribe.



- 1 - Young boy and his tamed parrot, Amazonia
- 2 - Embera girl, Darien Park
- 3 - Aymara girl in traditional costume
- 4 - Kunas women exhibiting their *molos*



The peoples of Chile

On Chilean lands, populations with multiple identities mingle. Before the Spanish conquistadors swept the country, it was inhabited by numerous indigenous tribes, some of which – such as the Mapuche and the Aymara people – are still very much present today. This history marked by colonisation but also the integration of waves of immigrants from Europe (French, German and British in particular) has contributed to making modern-day Chile a unique mix of cultures of traditions. Go out and meet these warm, hospitable people; they will introduce you to their many customs and their folklore. The colourful and cheerful local markets provide a means to fully immerse yourself in this society that is both modern and traditional. Alongside culinary specialities of varied influences, you will find countless handcrafted objects, including the famous chamanto, a poncho traditionally worn by the huasos, Chile's horsemen.

The Kuna Indians

In the San Blas Islands, in the heart of the Caribbean Sea, the Kuna Indians will share with you their centuries-old history. The origins of this warrior tribe remain uncertain, although it would seem that their lineage can be traced back to the Mayans and the Amazon Indians. Friendly and proud of its culture, this Amerindian ethnic group still lives from hunting and fishing, and travels by dugouts between the islands scattered with palm trees and mangroves. You'll be able to admire the *molos*, multicoloured fabrics fashioned by the women, depicting motifs which they used to draw directly onto their own bodies, as well as the imposing bracelets covering their arms and legs.

Discover the Amazon

NEW



Alter do Chao

Around thirty kilometres south of Santarem, discover the small village of Alter do Chao whose beaches are reminiscent of the Caribbean. Nestling in a hollow sculpted by the River Tapajós, the charming locality is home to sumptuous stretches of white sand, surrounded by turquoise blue water and lush tropical vegetation: an enchanting setting that, with the river's changing water levels, transforms to make way for a huge flooded forest. Inland, Mount Morro offers sublime views over the river and the jungle, and is an idea spot from which to admire the sunset.



Santarem

Established at the confluence of the Tapajós and Amazon rivers, the city of Santarem flourished for a time during the rubber boom, then sank into oblivion when the "soft gold" boom eventually went bust. Over the last twenty years or so, the economy of Santarem, which is now Amazonia's third biggest city after Manaus and Belem, has regained some momentum thanks to soybean cultivation and tourism. Renowned for its forests, Santarem offers a wonderful opportunity to discover the Amazonian ecosystems.

CAYENNE • CAYENNE

LE DUMONT-D'URVILLE

13 days/12 nights

17th and 29th November 2020,
20th March and 1st April 2021

from € 5,170



DAY ITINERARY

DAY	ITINERARY
1	Cayenne (French Guiana) Embarkation from 16.00 to 17.00 - Departure: 18.00
2	At sea
3	Macapa, Amazonia (Brazil) Mucurui, Amazonia (Brazil)
4	Aquiqui, Amazonia (Brazil) Guajará, Amazonia (Brazil)
5	Santarem, Amazonia (Brazil)
6	Parintins, Amazonia (Brazil)
7	Alter do Chao, Amazonia (Brazil)
8	Lucia, Amazonia (Brazil)
9	Breves, Strait of Breves (Brazil)
10	Belem, Amazonia (Brazil)
11	At sea
12	Salvation Islands (French Guiana)
13	Cayenne (French Guiana) Arrival: 07.00 - Disembarkation

17th November 2020 and 1st April 2021
 departures: cruises in partnership with **NATIONAL GEOGRAPHIC EXPEDITIONS** offering enrichment with a National Geographic Photographer and a destination expert.

HIGHLIGHTS:

- Outings and shore visits in Zodiac® inflatables with a team of experienced naturalist guides.
- Discover the Amazon, the river that holds all records: it is the river that carries the largest volume of water to the sea, it is the longest river in the world and the easiest to navigate, and its basin is fed by over a thousand tributaries...
- Sail along fabulous straits, meanders and river arms.
- An incredibly rich variety of endemic wildlife: toucans, hawks, ibises, parrots, iguanas, lizards, monkeys, buffaloes, river dolphins, fish, and more.
- Alter do Chao and its beautiful white-sand beach that is ideal for swimming.
- The great city of Belem, its market and its fort.
- In the Salvation Islands, the possibility of strolling among the former prisons surrounded by exotic vegetation.
- Cross the Equator between Belem and Cayenne.

More informations on www.ponant.com

The Caribbean & Amazon River



Bequia

With its charming beaches of fine sand, its turquoise waters home to brightly coloured marine life and its many bays surrounded by deep green hills, Bequia is undoubtedly one of the most beautiful islands in the Caribbean. Lying at the heart of the Grenadines, this secret land, known as the “island of clouds” by the Amerindians, will reveal a rich history of traditions, as well as many picturesque and lively small villages. When your ship calls here, do not miss the chance to explore the former base of the famous pirate Blackbeard in the 18th century...

Belem

The historic city of Belem stretches along the Bay of Guajar on the Amazon Delta, at the northernmost tip of Brazil. Its lively waterfront is home to the century-old Ver-o-Peso market and its iconic turreted iron structure, the Mercado de Ferro. Nearby, mango tree-shaded streets lead to the neoclassic Da Paz Theatre, the Baroque cathedral of S and Prespio Fort, whose battlements look out over the old town and the bay. You will be fascinated by this attractive city of baroque colonial architecture, with colourful, fragrant markets, and pretty cobbled streets, some of which lead to the edges of the jungle.



CAYENNE • FORT-DE-FRANCE
LE DUMONT-D'URVILLE
 13 days/12 nights
11th December 2020
 from € 5,170

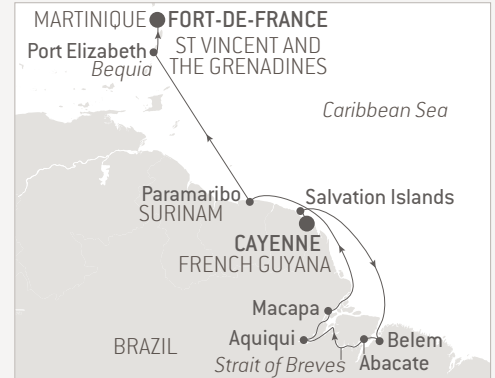

DAY ITINERARY

DAY	ITINERARY
1	Cayenne (French Guiana) Embarkation from 16.00 to 17.00 - Departure: 23.00
2	Cayenne
3	Salvation Islands (French Guiana)
4	<i>At sea</i>
5	Belem, Amazonia (Brazil)
6	Abacate, Strait of Breves (Brazil)
7	Aquiqui, Amazonia (Brazil)
8, 9	<i>At sea</i>
10	Paramaribo (Surinam) <i>Full day and evening</i>
11	<i>At sea</i>
12	Port Elizabeth, Bequia (Saint Vincent and the Grenadines) <i>Afternoon</i>
13	Fort-de-France (Martinique) Arrival: 07.00 - Disembarkation

HIGHLIGHTS:

- Cruise between Amazonia and the Caribbean, to discover picture-postcard landscapes.
- **Outings and shore visits in Zodiac® inflatables** with a team of experienced naturalist guides along the meanders of the Amazon River, in the heart of the rainforest.
- An incredibly rich variety of endemic wildlife: toucans, hawks, ibises, parrots, iguanas, lizards, monkeys, buffaloes, river dolphins, fish, and more.
- Special encounters with the Caboclos tribes.
- The great city of Belem, its market and its fort.
- Cross the Equator between Cayenne and Belem.
- In the Salvation Islands, the possibility of strolling among the former prisons surrounded by exotic vegetation.

More informations on www.ponant.com

The Caribbean & French Guiana



The Salvation Islands

Lying off the coast of Kourou, an essential element of any trip to Guiana, the Islands of Salvation were known as the "Islands of the Devil" because of the strong sea currents that made access to them perilous. Once infamous for being the site of a gaol with very harsh conditions of detention, where Alfred Dreyfus was exiled, today they are a peaceful place where coconut palms cast shade over the crystal-clear waters. During your cruise, we invite you to make a timeless journey to visit the many remains of the prison that are still visible, including cells and the abandoned hospital.



Trinidad and Tobago

Small islands in the South of the Caribbean, Trinidad and Tobago form a tiny republic, a veritable tropical paradise located off the coast of Venezuela. Conquered by Christopher Columbus in 1498, the island was successively ruled by the French, Dutch and British, leaving the islands with a unique culture. In Trinidad, the larger of the two islands, the aromas of mangos, lemon trees and sea spray perfume the air, while the azure water contrasts with the pinky beaches and the tropical rainforest. From Port-of-Spain, don't miss a visit to the Caroni Bird Sanctuary, and try to spot the rare protected Scarlet Ibis, Trinidad's National Bird.



FORT-DE-FRANCE • CAYENNE
LE DUMONT-D'URVILLE
 11 days/10 nights
10th March 2021
 from € 3,740



DAY	ITINERARY	PORT OF CALL DURATION
1	Fort-de-France (Martinique) Embarkation from 16.00 to 17.00 - Departure: 21.00	
2	Les Saintes (Guadeloupe)	Full day
3	Pigeon Point (Saint Lucia) Soufrière (Saint Lucia)	Morning Afternoon and evening
4	Bridgetown (Barbados)	Full day
5	Port Elizabeth, Bequia (Saint Vincent and the Grenadines)	Full day
6	Saint George's, Grenada (Grenada)	Full day
7	Port-of-Spain, Trinidad (Trinidad and Tobago)	Morning
8	<i>At sea</i>	
9	Paramaribo (Surinam)	Full day
10	Salvation Islands (French Guiana)	Afternoon
11	Cayenne (French Guiana) Arrival: 06.00 - Disembarkation	

HIGHLIGHTS:

- Cruise between the Caribbean and French Guiana, to discover picture-postcard landscapes.
- **UNESCO World Heritage Site:** Discovering Saint Lucia and its two rocky peaks.
- Discover the Grenadine Islands, considered one of the world's most stunning archipelagos.
- Exceptional sea bed with possibility to observe turtles, barracudas, spiny lobsters and parrot fish.
- Multiple opportunities to swim in crystal-clear waters.
- In the Salvation Islands, the possibility of strolling through the former prisons surrounded by exotic vegetation.
- Possibility of diving (PADI Open Water Diver or equivalent) with an experienced instructor on board.

More informations on www.ponant.com

Christmas in the Caribbean



Soufrière

A small island shaped like a mango, Saint Lucia offers visitors a luxuriant and wild nature, long fine-sand beaches, not to mention its two rocky peaks listed as UNESCO World Heritage Sites- huge volcanic cones shaped like sugarloaves. Discover La Soufriere. Here, the thick mantle of greenery and the spicy scents of the rainforest give way to a lunar landscape with the smell of sulphur, while the fumaroles and steam jets shooting out of the ground provide proof that this imposing volcano is still very active.



Cartagena

Founded in 1522 at the time of the conquistadors, Cartagena has preserved the traces of its rich colonial past. Its imposing ramparts are further proof of the tumultuous history of this city. As the site for storing the gold looted from the Aztec and Inca empires before it was taken to Spain, the city was also frequently the target of pirates and privateers. Declared a UNESCO World Heritage Site, the romanticism of this city with its narrow streets and colourful façades will not fail to charm you. Set sail in the footsteps of the Spanish sailors who conquered Central America and relive this page of history during your stopover here.

FORT-DE-FRANCE • COLÓN
LE DUMONT-D'URVILLE
13 days/12 nights
23rd December 2020
from € 4,300



DAY	ITINERARY	PORT OF CALL DURATION
1	Fort-de-France (Martinique) Embarkation from 16.00 to 17.00 - Departure:23.30	
2	Portsmouth (Dominica)	Afternoon
3	Port Elizabeth, Bequia (Saint Vincent and the Grenadines)	Full day
4	Soufrière (Saint Lucia)	Full day and evening
5	Bridgetown (Barbados)	Full day and evening
6	Mayreau Island (Saint Vincent and the Grenadines)	Full day
7	Saint George's, Grenada (Grenada)	Full day
8	At sea	
9	Bonaire (Netherlands Antilles)	Full day
10	At sea	
11	Cartagena (Colombia)	Full day
12	San Blas Islands (Panama)	Afternoon
13	Colón (Panama) Arrival: 07.00 - Disembarkation	

HIGHLIGHTS:

- **UNESCO World Heritage Sites:** Saint Lucia's volcanic Pitons, Cartagena de Indias, an old colonial city, historic Bridgetown and its Garrison, Morne Trois Pitons National Park on Dominica.
- Zodiac® landings to discover the stunning San Blas Islands.
- An extraordinary encounter with the Kuna Indians, a warrior tribe of the San Blas archipelago.
- On Dominica, the National Park of Cabrits and Fort Shirley.
- Multiple opportunities to swim in crystal-clear waters.
- Possibility of diving (PADI Open Water Diver or equivalent) with an experienced instructor on board.

More informations on www.ponant.com

Pearls of the Caribbean



Tobago Cays

One of the jewels of the Grenadines Islands, the Tobago Cays Marine Park will reveal to you its harbours protected by the coral reef. Here, the locals say that the beach, the nature reserves and the small villages make the hands of time turn slowly... A dream for explorers who like to gaze at picture- postcard beaches and the limpid waters of the coast, complete with resident sea turtles. Bound together by the most beautiful coral reef in the West Indies, these rocky outcrops will provide the mooring for your ship, allowing you to feast your eyes on the beauty all around



Les Saintes

Made up of 9 small islets and discovered by Christopher Columbus, Les Saintes awaken the imagination of travellers and offer extraordinary panoramas. Proudly ranked as the third most beautiful bay in the world, Les Saintes Bay, which formerly welcomed pirates and privateers, is now a highly desirable anchorage. During your stopover here, do not miss the chance to discover the richness and diversity of the underwater world in these crystal-clear waters during unforgettable dives, and let your gaze wander to the horizon, guided by the entertaining ballet of the saintoises, the small and colourful local fishing boats.



FORT-DE-FRANCE • FORT-DE-FRANCE

LE CHAMPLAIN

9 days/8 nights

29th January, 20th February
and 8th March 2021

from € 2,990

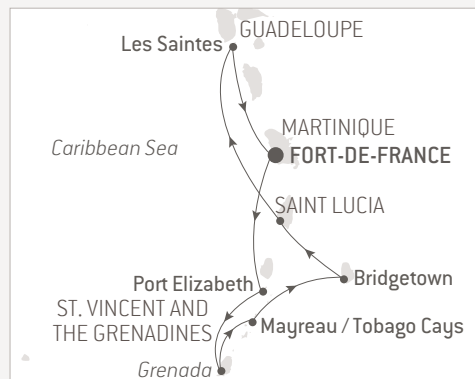

DAY	ITINERARY	PORT OF CALL DURATION
1	Fort-de-France (Martinique) Embarkation from 16.00 to 17.00 - Departure: 21.00	
2	Port Elizabeth, Bequia (Saint Vincent and the Grenadines)	Full day and evening
3	Saint George's, Grenada (Grenada)	Full day
4	Mayreau Island (Saint Vincent and the Grenadines)	Full day and evening
5	Tobago Cays (Saint Vincent and the Grenadines)	Full day
6	Bridgetown (Barbados)	Full day
7	Pigeon Island Beach Soufrière (Saint Lucia)	Morning Afternoon and evening
8	Les Saintes (Guadeloupe)	Full day
9	Fort-de-France (Martinique) Arrival: 05.00 - Disembarkation	

HIGHLIGHTS:

- **UNESCO World Heritage Site:** Discovering Saint Lucia and its two rocky peaks.
- A true picture-postcard of the West Indies: long white-sand beaches, colourful seabeds, and the easy Creole way of life.
- Discover the Grenadine Islands, considered one of the world's most stunning archipelagos.
- Exceptional sea bed with possibility to observe turtles, barracudas, spiny lobsters and parrot fishes.
- Multiple opportunities to swim in crystal-clear waters.
- Possibility of diving (PADI Open Water Diver or equivalent) with an experienced instructor on board.

More informations on www.ponant.com

Jewels of the Caribbean



The British Virgin Islands

We will take you to the heart of the Virgin Islands, where you will find sublime moors with stunning beaches tucked away in small tranquil bays, small houses in soft colours, and welcoming villagers. Discovered and named by Christopher Columbus, these islands, where Caribbean Indians described by Columbus as timid lived for a time, are now mostly uninhabited. During your cruise, discover Virgin Gorda and its stunning natural pools of emerald water. Many claim that these volcanic islands with majestic landscapes inspired the famous novel "Treasure Island".



Dominica

With its mountainous terrain, vast tropical forest, hot springs, rivers and spectacular waterfalls, Dominica is undoubtedly the wildest island in the Caribbean. Protected by several national parks, this little-known land, located in the heart of the Caribbean Sea, between Guadeloupe and Martinique, will inspire adventure and exploration. During your port of call, do not miss out on discovering the enchanting landscapes of the Indian River: navigating through this dense mangrove, in which creepers, ferns, forest trees and giant roots are interweaved, is a magical experience, a fascinating voyage into the heart of an almost mystical natural universe.

FORT-DE-FRANCE • FORT-DE-FRANCE

LE CHAMPLAIN

9 days/8 nights

21st January and 28th February 2021

from € 2,990

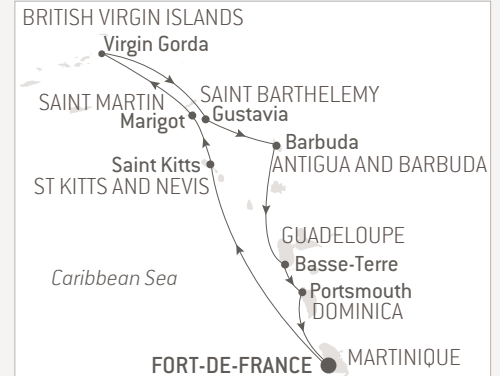

DAY	ITINERARY	PORT OF CALL DURATION
1	Fort-de-France (Martinique) Embarkation from 16.00 to 17.00 - Departure: 21.00	
2	South Friars Bay, Saint Kitts (Saint Kitts and Nevis)	Afternoon
3	Marigot (Saint Martin)	Full day and evening
4	Virgin Gorda (British Virgin Islands)	Full day
5	Gustavia (Saint Barthelemy)	Full day and evening
6	Barbuda (Antigua and Barbuda)	Morning
7	Basse-Terre (Guadeloupe)	Full day and evening
8	Portsmouth (Dominica)	Full day
9	Fort-de-France (Martinique) Arrival: 06.00 - Disembarkation	

HIGHLIGHTS:

- A cruise in the heart of the West Indies.
- Discover 8 islands on the same cruise: Martinique, St. Kitts, Saint Barthelemy, Virgin Gorda, Saint Martin, Barbuda, Dominica, Guadeloupe.
- **UNESCO World Heritage Sites:** Brimstone Hill Fortress National Park in St. Kitts and Nevis, Morne Trois Pitons National Park on Dominica.
- Discover the British Virgin Islands, where each white-sand beach is more stunning than the last.
- On Dominica, the National Park of Cabrits and Fort Shirley.
- Multiple opportunities to swim in crystal-clear waters.
- Possibility of diving (PADI Open Water Diver or equivalent) with an experienced instructor on board.

More informations on www.ponant.com

Treasures of the Caribbean Sea



Miami

The ultimate symbol of Florida if ever there was one, to this day Miami remains a must-see city. This multicultural city, where the sun rules supreme has a lot more to offer than just long beaches and glamour. Miami is also worth visiting for its Art Deco district in South Beach, home to pastel-coloured buildings and to hotels with eccentric shapes. Artists, designers and top couturiers enliven this multifaceted city of skyscrapers, boutiques, frescoes and turquoise water. Not far from there is Everglades National Park, the largest subtropical wilderness reserve in North America, listed with UNESCO.



Progreso

On the Yucatan Peninsula, the charming seaside town of Progreso will delight visitors seeking authenticity. Particularly popular with the inhabitants of the Yucatan capital, located about thirty kilometres away, the town is home to magnificent white sandy beaches and a pleasant promenade along the sea front: an ideal environment to make the most of the area's gentle lifestyle. Lying at the confluence of the Caribbean Sea and the Gulf of Mexico, the spot is also reputed for its shallow and calm waters, perfect for water sports. In addition to this idyllic setting, Progreso offers privileged access to the ancient Mayan cities of Chichén Itzá and Uxmal.



COLÓN • MIAMI
LE BORÉAL
 12 days/11 nights
 9th April 2021
 from € 3,810



DAY	ITINERARY	PORT OF CALL DURATION
1	Colón (Panama) Embarkation from 16.00 to 17.00 - Departure: 18.00	
2	Providencia (Colombia)	Afternoon
3	At sea	
4	Puerto Cortés (Honduras)	Afternoon
5	Santo Tomás de Castilla (Guatemala)	Full day
6	Half Moon Caye (Belize)	Full day
7	At sea	
8,9	Progreso (Mexico)	Full day
10	At sea	
11	Miami (United States)	Late afternoon
12	Miami (United States) Arrival: 07.00 - Disembarkation	

♥ **OVERLANDS:** Tikal by air from Santo Tomás de Castilla (see page 49).

HIGHLIGHTS:

- Visit 7 countries on a single cruise from Panama to the United States.
- An overnight stay in Progreso, with an exceptional visit to the many Mayan sites, including Chichén Itzá and Uxmal, and with the visit of Merida.
- From Santo Tomás de Castilla, an extension is possible to visit the famous Tikal pyramids, incredible vestiges of the ancient Mayan civilisation.
- From Half Moon Cay, possibility of heading out to the mythical Blue Hole.
- From Colón, before your cruise, possibility of visiting the mythical Panama Canal.

More informations on www.ponant.com

Between Panama & Martinique



Bonaire

Surrounded by a barrier reef and a marine sanctuary, Bonaire is a true paradise for divers. This peaceful and preserved little island is renowned all over the world for its coral reefs, which are directly accessible from the beach. Discover magnificent marine fauna and flora while snorkelling or diving in its turquoise waters. The Washington Slagbaai National Park in the north of the island is home to many birds. It is the most important breeding site in the south Caribbean for the pink flamingo, the island's emblematic animal.



Mayreau

Among the string of paradisiac islands with their white sandy beaches that form the Saint Vincent and the Grenadines archipelago, Mayreau is the smallest. Its peaceful and idyllic atmosphere, far from the madding crowd, invites you to relax. The only road leads to Salt Whistle Bay to the north and Saline Bay to the south, via the village nestling at the summit of a hill. Onshore, make the most of a shaded and fully equipped beach, from where you'll be able to set off snorkelling to explore superb coral gardens overflowing with life and colour.

COLÓN • FORT-DE-FRANCE

10 days/9 nights

LE CHAMPLAIN

12th January 2021

LE DUMONT-D'URVILLE

1st March 2021

from € 3,220



DAY	ITINERARY	PORT OF CALL DURATION
1	Colón (Panama) Embarkation from 16.00 to 17.00 - Departure: 18.00	
2	San Blas Islands (Panama)	Morning
3	Cartagena (Colombia)	Full day
4	At sea	
5	Bonaire (Netherlands Antilles)	Full day and evening
6	At sea	
7	Saint George's, Grenada (Grenada)	Full day
8	Mayreau Island (Saint Vincent and the Grenadines)	Full day
9	Soufrière (Saint Lucia)	Full day and evening
10	Fort-de-France (Martinique) Arrival: 07.00 - Disembarkation	

1st March 2021 departure:
an expedition cruise in partnership
with **National Geographic Expeditions** offering enrichment with
a National Geographic Photographer and a destination expert
onboard.



HIGHLIGHTS:

- **UNESCO World Heritage Sites:** Saint Lucia's volcanic Pitons; Cartagena de Indias, an old colonial city.
- Zodiac® landings to discover the stunning San Blas Islands.
- An extraordinary encounter with the Kuna Indians, a warrior tribe of the San Blas archipelago.
- Multiple opportunities to swim in crystal-clear waters.
- Possibility of diving (PADI Open Water Diver or equivalent) with an experienced instructor on board.
- From Colón, before your cruise possibility of visiting the mythical Panama Canal.

More informations on www.ponant.com

Natural & Cultural Wonders of the Western Caribbean

PUERTO MORELOS • PUERTO MORELOS

LE CHAMPLAIN

8 days/7 nights

3rd and 17th November 2020,

1st and 15th December 2020

from € 2,800



Quiriguá National Park

From Santo Tomás de Castilla, set off to discover the famous Mayan archaeological site of Quiriguá. Listed as a UNESCO World Heritage Site since 1981, this place takes you back in time, deep into a décor of ruins and vestiges from the 8th century. Palaces and pyramids, sanctuaries, steles, altars and zoomorphic sculptures are some of the wonders you'll find among the lush vegetation. The site stretches out over some thirty hectares and provides exceptional evidence for the study of this mysterious civilisation, which continues to confound historians and scientists around the world.



DAY	ITINERARY	PORT OF CALL DURATION
1	Puerto Morelos (Mexico) Embarkation from 16.00 to 17.00 - Departure: 22.00	
2	At sea	
3	♥ Puerto Cortés (Honduras)	Full day and evening
4	♥ Santo Tomás de Castilla (Guatemala)	Full day and evening
5	Livingston (Guatemala)	Full day
6	♥ Belize City (Belize)	Full day
7	Half Moon Caye (Belize)	Morning
8	Puerto Morelos (Mexico) Arrival: 08.30 - Disembarkation	

♥ **OVERLANDS:** Discovering the Blue Hole from Belize City, Copán by air from Puerto Cortés, Tikal by air from Santo Tomás de Castilla (see pages 48-49).

Livingston

Livingston is a town unlike any other in Guatemala, an enclave with a Caribbean atmosphere on the edge of the Rio Dulce. *Lanchas*, the motor boats that travel along the river and the Caribbean Sea, are the only way of reaching this small, welcoming town with no overland access to the rest of the country. Here, you are in Garifuna country: the inhabitants, descendent from Jamaican slaves, perpetuate their culture through oral tradition and ceremonies. Garifuna music, which is lively and sounds similar in some respects to reggae, and Garifuna dance, to the beat of drums, have both been classified by UNESCO as "Masterpieces of the Oral and Intangible Heritage of Humanity".



HIGHLIGHTS:

- A cruise to four Central American countries: idyllic beaches, pre-Columbian sites, and discovery of the Garifuna culture.
- **UNESCO World Heritage Sites:** Tikal by plane and the archaeological park and Mayan ruins of Quirigua from Santo Tomás de Castilla; the Mayan site of Copán from Puerto Cortés; the Belize Barrier Reef with Half Moon Caye and the Great Blue Hole.
- Swim, snorkell or scuba dive at the Great Blue Hole in Belize, one of the world's ten most beautiful diving sites according to Captain Cousteau.
- Discover the town of Livingston, which can only be reached by sea.
- Possibility of diving (PADI Open Water Diver or equivalent) with an experienced instructor on board.
- The possibility of visiting Tulum and Muyil before your cruise.

More informations on www.ponant.com

Maya Treasure of the Yucatán



The Cenotes of Yucatán

From the famous white-sand beaches of Progreso, don't miss one of the natural wonders of Yucatán: the cenotes. Strange and mysterious or even mystical, their beauty fascinates travellers. Formed thousands of years ago by meteorite impacts, these spectacular sinkholes filled with fresh water sometimes connect to the sea. The sun is discreet here and reveals the infinite nuances in the colour of the water, shifting from deep cobalt blue to soft turquoise green. Once regarded by the Maya as passageways to the world of the gods and the dead, these majestic cavities were the theatre of many sacred rites.



Palenque

Tucked away amid the lush and dense vegetation of the Chiapas forest, a national park listed as a UNESCO World Heritage Site, the ancient Mayan city of Palenque reveals itself through the mist. A mysterious, almost magical atmosphere reigns over the temples and palaces, vestiges of this ancient city's golden age. The Palenque sanctuary is a remarkable example of Mayan art due to its fine and delicate architecture. It is also one of the best preserved sites in Mexico. There, you will be able to admire magnificent sculptural reliefs depicting Mayan mythology: a unique opportunity to discover some of the myths and rites of these fascinating people, from your call at Dos Bocas.

PUERTO MORELOS • PUERTO MORELOS
LE CHAMPLAIN
 8 days/7 nights
 10th and 24th November and 8th December 2020
 from € 2,800



DAY	ITINERARY	PORT OF CALL DURATION
1	Puerto Morelos (Mexico) Embarkation from 16.00 to 17.00 - Departure: 22.00	
2	At sea	
3	Seybaplaya (Mexico)	Full day
4	Dos Bocas (Mexico)	Full day
5	Progreso (Mexico)	Evening
6	Progreso (Mexico)	Full day
7	Puerto Morelos (Mexico)	Morning
8	Puerto Morelos (Mexico) Arrival: 08.30 - Disembarkation	

24th November 2020 departure:
 a cruise in partnership with
Paris Match.



HIGHLIGHTS:

- A journey to the heart of the authentic Yucatán to discover some of the secrets of the pre-Columbian civilisations.
- **UNESCO World Heritage Sites:** the ancient Mayan city of Chichén Itzá, the pre-Hispanic city and national park of Palenque, the historic fortified town of Campeche, the pre-Columbian city of Uxmal.
- Exceptional architectural heritage, vestige of the colonial era.
- From Progreso, visit Mérida, the capital of the state of Yucatán, renowned for its cultural heritage.
- Visit of cocoa plantations.

More informations on www.ponant.com

Christmas between Mexico and Panama

NEW

PUERTO MORELOS • COLÓN

LE CHAMPLAIN

8 days/7 nights

22nd December 2020

from € 2,800

CHRISTMAS
CRUISE



San Blas Islands

Located on the north-east coast of Panamá, the San Blas archipelago is a string of coral islands that graces the heart of the Caribbean Sea. Over 300 islands and cays covering an area of 300 square kilometres offer travellers a multitude of treasures. Sheltered behind a long coral reef, the San Blas Islands are full of paradisiac anchorages. The long sandy white beaches bounded by crystal clear waters will allow you to relax and enjoy an incredible marine fauna before discovering the Kunas Indian community. Still feeding off hunting and fishing, they will welcome you in their villages of bamboo houses gathered near the beaches.



Colón

At the Caribbean entrance of the Panama Canal, discover Colón, the second largest city in Panama. Founded in 1850 by Americans working on the Panama railroad connecting the Atlantic and Pacific coasts through the isthmus of Panama; the city rapidly overshadowed the older Caribbean ports of Panama when the canal opened. Colón is today an important port, and the free trade zone created in 1953 contributed greatly to the development of the city. It is also a privileged access point for visiting the famous Miraflores Locks and discovering the bustling city of Panama.



DAY	ITINERARY	PORT OF CALL DURATION
1	Puerto Morelos (Mexico) <i>Embarkation from 16.00 to 17.00 - Departure: 18.00</i>	
2	Puerto Morelos (Mexico)	<i>Full day</i>
3,4	<i>At sea</i>	
5	Providencia (Colombia)	<i>Morning</i>
6	Puerto Limón (Costa Rica)	<i>Full day</i>
7	San Blas Islands (Panama)	<i>Afternoon</i>
8	Colón (Panama) <i>Arrival: 06.00 - Disembarkation</i>	

HIGHLIGHTS:

- Spend Christmas in the Caribbean Sea during a brand-new cruise combining idyllic beaches and Pre-Columbian sites.
- **UNESCO World Heritage Sites:** the Mayan archaeological site of Chichen Itzá from Puerto Morelos
- Zodiac® landings to discover the stunning San Blas Islands.
- An extraordinary encounter with the Kuna Indians, a warrior tribe of the San Blas archipelago.
- Multiple opportunities to swim in crystal-clear waters.
- The possibility of visiting Tulum and Muyil before your cruise, and the Panama Canal after your cruise.

More informations on www.ponant.com

Treasures of Central America



Herradura

Herradura takes its name in Spanish from the horseshoe form of its bay, covered in lush tropical vegetation. This small town is surrounded by national parks that are remarkable for the rich variety of fauna and flora they protect. When *Le Boréal* calls here, it will be the moment to take a journey in small covered boats along the Tarcoles River, whose banks are home to crocodiles and iguanas. This mangrove also hosts the loyal and flamboyant Scarlet Macaw, with its red, blue and yellow plumage.



Acajutla

A former indigenous village and the location of the first battle fought by the Pipils during the Spanish conquest, Acajutla is now a favourite entry point for accessing El Salvador's major pre-Columbian sites, such as the Mayan ruins of Tazumal or the Joya de Cerén archaeological site, listed with UNESCO. This pre-Hispanic community buried under ash after a volcanic eruption in the 7th century offers visitors almost intact vestiges of daily life at that time: dwellings, kitchens, public baths, tools...



GUAYAQUIL • COLÓN

LE BORÉAL

14 days/13 nights

27th March 2021

from € 4,450



DAY	ITINERARY	PORT OF CALL DURATION
1	Guayaquil (Ecuador) Embarkation from 16.00 to 17.00 - Departure: 18.00	
2,3	At sea	
4	Casa Orquideas (Costa Rica)	Full day
5	At sea	
6	Acajutla (Salvador)	Full day
7	♥ Puerto Quetzal (Guatemala)	Full day
8	At sea	
9	San Juan del Sur (Nicaragua)	Full day
10	Herradura (Costa Rica)	Full day
11	At sea	
12	Viveros, Pearl Islands (Panama)	Full day
13	Crossing the Panama Canal (Panama) Colón (Panama)	20.00
14	Colón (Panama) Disembarkation: 07.00	

♥ **OVERLAND:**
Tikal by air from Puerto Quetzal (see page 49).

HIGHLIGHTS:

- Discover 6 countries in Central and South America: Ecuador, Costa Rica, El Salvador, Guatemala, Nicaragua, Panama.
- Possibility of visiting some major Pre-Columbian **sites listed with UNESCO**, such as the Tikal pyramids from Puerto Quetzal and the Joya de Cerén archaeological site from Acajutla.
- From Puerto Quetzal, possibility of visiting La Antigua de Guatemala, **listed with Unesco**.
- Exceptional architectural heritage, testimony to the colonial era, alternating Baroque and Andalusian-Moorish styles.
- In Costa Rica, rich and varied tropical plants and wildlife.
- Sail through the Panama Canal, truly a masterpiece of civil engineering.
- Specialist lecturers aboard, to share their passion for their subject and their knowledge with you.

More informations on www.ponant.com

Natural Wonders of Central America

NATIONAL GEOGRAPHIC EXPEDITIONS | PONANT



PUERTO QUETZAL • GUAYAQUIL

LE SOLÉAL

14 days/13 nights

26th September 2020

from € 4,580



Manuel Antonio National Park

Don't miss a visit to Manuel Antonio National Park, a veritable jewel of greenery, the smallest in Costa Rica but undoubtedly the richest. This charming and unspoiled site, combining luxuriant tropical vegetation and strange-looking animals, such as the languorous sloth, the amazing squirrel monkey or the colourful iguana, is bordered by many beaches, some of the most beautiful in the country with their turquoise waters and marvellous coral reefs. Here, the footpaths overlooking the calm sea will lead you to spectacular viewpoints, such as the long strip of golden sand of the Punta cathedral and its remote beaches with their picture-postcard settings.



Cocos Island

Off the coast of Costa Rica, a solitary island emerges from the waves... Cocos Island, covered with dense vegetation in a magnificent palette of greens. From your very first glimpse of the island, travellers are cast into their childhood dreams where pirates and corsairs from adventure tales came to bury their loot and draw their treasure maps. Now a UNESCO national park, its marine and terrestrial plant and wildlife benefit from this protection to grow and prosper. The underwater world surrounding the island is teeming with exceptional pelagic wildlife, and it is not rare to encounter sharks, whales, rays and sea lions patrolling in tight ranks in the transparent waters.

DAY ITINERARY

DAY	ITINERARY
1	Puerto Quetzal (Guatemala) Embarkation from 16.00 to 17.00 - Departure: 18.00
2	At sea
3	Curú Wildlife Refuge Tortuga Island (Costa Rica)
4	Manuel Antonio National Park (Costa Rica)
5	At sea
6	Cocos Island (Costa Rica)
7	At sea
8	Cébaco Island (Panama)
9	Sailing around Pacheca Island Fuerte Amador (Panama)
10	Playa Muerto, Darien National Park - Jaqué (Panama)
11	Utría National Natural Park (Colombia)
12, 13	At sea
14	Guayaquil (Ecuador) Arrival: 07.00 - Disembarkation

HIGHLIGHTS:

- A cruise in partnership with National Geographic Expeditions offering enrichment with a National Geographic Photographer and a destination expert onboard.
- An expedition cruise discovering the nature parks, biodiversity and tribes of Central America.
- **Outings and shore visits in Zodiac® inflatables** with a team of experienced naturalist guides.
- **UNESCO World Heritage sites:** La Antigua de Guatemala from Puerto Quetzal, the national park of Cocos Island, Darien National Park, the historic centre of Quito from Guayaquil.
- An exceptional call at Cocos Island, considered by Jacques-Yves Cousteau to be "the most beautiful island in the world".
- Birdwatching opportunities around Pacheca Island.
- Encounter with the indigenous Emberas tribe in the Darien National Park.
- Before your cruise, you will have the opportunity to discover the famous Tikal pyramid and La Antigua Guatemala.
- After your cruise, you will have the opportunity to visit the historic centre of Quito and the Galapagos

More informations on www.ponant.com

Natural & Cultural History of Central America



Panama Canal

Aboard your ship, experience something unique, that has inspired the imagination of numerous adventurers in the 20th century: sailing the Panama Canal. Its construction started in 1880 under the direction of Ferdinand De Lesseps. Abandoned then resumed, this marvel of engineering was completed by the United States in 1887 and opened in 1914. The canal crosses the Isthmus of Panama and links the Atlantic to the Pacific. Including three levels of locks and by raising ships to the level of Lake Gatun, almost as if the water was a lift, it allows them to avoid having to round Cape Horn.



Curú Wildlife Refuge

On the southern part of the Nicoya Peninsula, the small Curú Wildlife Refuge is the oldest protected park in Costa Rica. This refuge which has been at the heart of an original conservation and sustainable development project, is an exemplary site in terms of ecotourism as well as a research centre. After a short Zodiac® trip, you will discover, via the paths that criss-cross the tropical forest and lead to magnificent beaches, the most emblematic species of Costa Rica: monkeys, iguanas and over 200 bird species. Since their recent reintroduction, the scarlet macaw and the white-headed munia have thrived in this preserved environment.

COLÓN • PUERTO CALDERA
LE CHAMPLAIN, 29th Dec. 2020
LE DUMONT-D'URVILLE
4th January 2021
PUERTO CALDERA • COLÓN
LE CHAMPLAIN
5th January 2021
 8 days/7 nights, **from € 3,050**



DAY ITINERARY

- 1 **Colón (Panama)**
Embarkation from 16.00 to 17.00 - Departure: 23.00
- 2 **San Blas Islands (Panama)**
- 3 **Crossing the Panama Canal (Panama)**
- 4 **Playa Muerto, Darien National Park (Panama)**
- 5 **At sea**
- 6 **Manuel Antonio National Park (Costa Rica)**
- 7 **Curú Wildlife Refuge**
- 8 **Puerto Caldera (Costa Rica)**
Arrival: 06.00 - Disembarkation

This itinerary operates in both directions.

4th January 2021 departure:
 a cruise in partnership with
National Geographic Expeditions offering enrichment with a National Geographic Photographer and a destination expert onboard. Your ship will make an additional stopover at Tortuga Island on January 10th.



HIGHLIGHTS:

- Discover the fabulous National Parks of Central America, biodiversity and tribes.
- **Outings and shore visits in Zodiac® inflatables** with a team of experienced naturalist guides.
- **UNESCO site:** the Darien National Park from Playa Muerto, and its magnificent jungle.
- In Costa Rica, outings in the Manuel Antonio National Park and the Curú Wildlife Refuge, sanctuaries of unspoiled nature.
- Discover the magnificent islets of the San Blas Islands.
- Sail through the Panama Canal, truly a masterpiece of civil engineering.
- Encounters with the indigenous Emberas tribe in the Darien National Park and with the Kuna Indians of the San Blas archipelago.

More informations on www.ponant.com

The Sea of Cortez



The wildlife of the sea of Cortez

Set sail for an exceptional cruise in the Sea of Cortez, a magical region which Captain Jacques Cousteau called "the world's aquarium". Here in the warm, calm waters, a teeming underwater world awaits you. The wealth of the species represented here is incredible: 39% of all marine mammal species on Earth, nearly 900 species of fish and 33 cetacean species including the bottlenose dolphin and grey and blue whales, who come here to reproduce during the winter period. A marvellous immersion into the greatest aquarium in the world!



San Diego

To the south of California, San Diego enjoys a privileged natural environment. One of the largest fleets of US Navy vessels is stationed in this strategic port. The sunny climate and the beautiful sandy beaches compete for visitors' attention with the picturesque historic districts such as the Gaslamp Quarter, always lit up at dusk by gas lamps, a real journey back in time. Do not miss Balboa Park and its museums as well as San Diego Zoo, one of the most beautiful zoos in the world. But the show also continues on the surrounding beaches where it is not uncommon to come across sea lions!



SAN DIEGO • PUERTO QUETZAL

L' AUSTRAL, 13 days/12 nights
7th October 2020
from € 4,550

LE SOLÉAL, 14 days/13 nights
13th September 2020
from € 5,640



DAY ITINERARY

DAY	ITINERARY
1	San Diego (United States) Embarkation from 16.00 to 17.00 - Departure: 18.00
2,3	At sea
4	Cabo San Lucas (Mexico)
5	Monserrat Island / Puerto Agua Verde (Mexico)
6	Punta Colorada / Bahía Amortajada, San Jose Island (Mexico)
7	Los Islotes / Isla Partida / Espíritu Santo Island (Mexico)
8	Cerralvo Island (Mexico)
9,10	At sea
11	Huatulco (Santa María Huatulco) (Mexico)
12	At sea
13	Puerto Quetzal (Guatemala) Arrival: 07.00 - Disembarkation

13th September 2020 departure
(14 days/13 nights): a cruise in
partnership with National Geographic Expeditions, offering
enrichment with a National Geographic Photographer and a
destination expert onboard. This departure includes an additional
stopover in Coronado and Danzante Islands.



HIGHLIGHTS:

- An expedition cruise, to discover the fabulous biodiversity of the Sea of Cortez.
- **Outings and shore visits in Zodiac® inflatables.**
- **UNESCO World Heritage sites:** the islands and protected zones of the Gulf of California (also known as the Sea of Cortez), La Antigua de Guatemala and its colonial architecture from Puerto Quetzal in Guatemala.
- The landscapes: red volcanic rock plunging into the turquoise water with the desert as the backdrop in the Sea of Cortez, dazzling white sandy beaches in Huatulco (optional shore excursion available).
- The wildlife: California sea lions, dolphins, sea turtles, tuna, barracuda, rays, pelicans, countless species of fish and sea birds.
- Bath and swim with sea lions at Los Islotes.
- Possibility of diving (PADI Advanced Open Water Diver or equivalent) with an experienced instructor on board and of snorkelling with your expedition team.

More informations on www.ponant.com

Transatlantic Voyage from Miami to Lisbon



Lisbon

Sitting proudly on the right bank of the Tagus estuary, Lisbon has stood the test of time remarkably well. Unconcerned with fashion or time, 'Lisa', as the locals like to call their city, is firmly rooted in reality and today it is a symbol of culture and modernity for the entire country. The city is home to incomparable landmarks listed as UNESCO World Heritage Sites, such as the Jerónimos Monastery and its stone that is delicately sculpted like lace, or the Belem Tower, an emblem of Portugal's naval power in the 16th century. Discover Lisbon's districts whose charms are as intoxicating as the sound of the Fado, as well as its paved streets and its houses decorated with blue tiles called 'azulejos'.



The Azores

A true garden of Eden lost in the middle of the North Atlantic, the Azores archipelago holds the promise of a timeless voyage. Windswept volcanic lands, these nine Portuguese islands offer incredibly diverse wild landscapes. Hills covered in lush vegetation, black-sand beaches, waterfalls cascading down vertiginous cliffs, natural pools carved out of rock, crater lakes and bubbling hot springs are just some of the natural wonders waiting to be explored. Considered one of the largest cetacean sanctuaries in the world, the surrounding waters are renowned for welcoming a large number of migrating and resident whale species. In the middle of this pristine natural setting, do not miss the chance to discover the small towns with a rich colonial past.

MIAMI • LISBON
LE BORÉAL
 15 days/14 nights
 20th April 2021
 from € 3,850



DAY	ITINERARY	PORT OF CALL DURATION
1	Miami (United States) Embarkation from 18.00 to 19.00 - Departure: 20.00	
2	Nassau (Bahamas)	Evening
3, 4	At sea	
5	Saint George's (Bermuda)	Full day
6 to 10	At sea	
11	Horta, Azores (Portugal)	Full day
12	Ponta Delgada, Azores (Portugal)	Full day
13, 14	At sea	
15	Lisbon (Portugal) Disembarkation : 07.00	

HIGHLIGHTS:

- A transatlantic cruise discovering the Bahamas, Bermuda and Azores archipelagos.
- **UNESCO World Heritage Sites:** the tower of Belem and the monastery of Jerónimos in Lisbon (embarkation port), the town of St George's and its fortifications.
- Visit Ponta Delgada, capital of the Azores: old town, churches, and the famous Portas da Cidade (city gates).
- Beautiful and diverse landscapes: white sandy beaches bordered with crystal clear waters in the Bahamas, idyllic coves and natural swimming pools in Bermuda, volcanoes, mountain peaks, green hills, lakes and cliffs in the Azores.

More informations on www.ponant.com

Cordillera & Andean Secrets



The Nazca Lines

From Pisco, we offer you the possibility to take a flight over the enigmatic and mysterious Nazca Lines, geometric tracers of gigantic size. The 450 km² of archaeological enigmas will surprise you with their size, content and sheer quantity and remain the World's greatest enigma. The drawings can represent living creatures such as lizards, monkeys, spiders and whales as well as geometric figures, they were discovered in 1926 and can only be seen in their true splendor from a certain altitude. Many scientists have puzzled over this enigma and, to date, no truly satisfactory answer has been found.



Arica

Located at the gateway to the Atacama desert, Arica, the Northernmost town in Chile, is very popular for its beautiful beaches and its rich historical sites. On the border between Peru and Chile, the city was the theatre for one of the most famous episodes of the War of the Pacific. It was at this time that Chile took possession of this paradise to make this port town an unmissable destination. Between long white sandy beaches edging the Pacific, millennial geoglyphs, arid valleys of the cordillera foothills, fertile altiplano and dormant volcanoes, do not miss the opportunity to discover this amazing city once inhabited by the Chinchorro people and then by the Incas.

GUAYAQUIL • TALCAHUANO

LE SOLÉAL, 9th October 2020

TALCAHUANO • GUAYAQUIL

LE BORÉAL, 14th March 2021

14 days/13 nights

from € 3,910



DAY	ITINERARY	PORT OF CALL DURATION
1	Guayaquil (Ecuador) Embarkation from 16.00 to 17.00 - Departure: 18.00	
2	At sea	
3	Salaverry (Peru)	Morning
4, 5	Callao (Peru)	Full day and evening
6	Pisco (Peru)	Full day
7	At sea	
8	Matarani (Peru)	Full day
9	Arica (Chile)	Full day
10	Iquique (Chile)	Morning
11	At sea	
12	Coquimbo (Chile)	Morning
13	At sea	
14	Talcahuano (Chile) Arrival: 07.00 - Disembarkation and transfer to the airport. Flight Concepción / Santiago.	

This itinerary operates in both directions.

OVERLANDS:
Flight over the Nazca Lines from Pisco and Cuzco and Machu Picchu from Callao (see page 48).

HIGHLIGHTS:

- **Many UNESCO World Heritage Sites:** the saltpeter mining towns of Iquique, the historic centre of Arequipa from Matarani, the historic centre of Lima, Cuzco, the site of Machu Picchu, the archeological zone of Chan Chan from Salaverry.
- Discover the major pre-Columbian sites and the mysterious geoglyphs.
- Exceptional architectural heritage, testimony to the colonial era.
- Discover Arequipa and the Santa Catalina Convent from Matarani.
- Specialist lecturers aboard to share their passion for their subject and their knowledge with you.

More informations on www.ponant.com

Jewels of Latin America



San Juan del Sur

Considered Nicaragua's surfing capital, the attractive seaside resort of San Juan del Sur is an idyllic location for chilling in the waves. You're guaranteed to fall in love with this former fishing town on the shores of the Pacific Ocean, now a popular seaside holiday spot. Less than a two-hour drive away is the city of Granada, founded in 1524 at the foot of the Mombacho volcano. Clinging to the shores of Lake Nicaragua, the town is a stunning example of colonial architecture, with its narrow streets and Al-Andalus houses painted in bright colours. Don't miss out on a tour of its La Merced church, wander around the main square and explore the San Francisco convent.



Puerto Caldera

The port of Puerto Caldera lies on the Pacific coast in the Gulf of Nicoya. Further inland, step into the midst of a lush tropical forest. Among the countless natural wonders to be found here, the Poas volcano towers up in all its majestic glory. Venture deeper into the luxuriant canopy and enjoy a unique experience as you slide from one tree to the next in total safety. Back on firm ground, an untouched cove offers up glimpses of osprey, tireless fishing birds that circle the surf to catch their next meal.

PUERTO QUETZAL • CALLAO

L'AUSTRAL

13 days/12 nights

19th October 2020

from € 3,740



DAY	ITINERARY	PORT OF CALL DURATION
1	Puerto Quetzal (Guatemala) Embarkation from 16.00 to 17.00 - Departure: 19.00	
2	At sea	
3	San Juan del Sur (Nicaragua)	Full day
4	Puerto Caldera (Costa Rica)	Full day
5	Quepos (Costa Rica)	Full day
6	Casa Orquideas (Costa Rica)	Morning
7, 8	At sea	
9	Guayaquil (Ecuador)	Full day
10	At sea	
11	Salaverry (Peru)	Full day
12	Callao (Peru)	Afternoon
13	Callao (Peru) Disembarkation : 07.00	

OVERLAND:
Quito by air from Guayaquil (see page 49).

HIGHLIGHTS:

- Before your cruise, you will have the opportunity to discover the famous Tikal pyramid, one of the major sites in pre-Columbian Maya culture.
- **UNESCO sites:** the archaeological site of Chan Chan from Salaverry; the historic centres of Quito and Cuenca from Guayaquil; Lima and Machu Picchu from Callao; La Antigua Guatemala from Puerto Quetzal.
- Discover an exceptional architectural heritage, between Granada and its many Andalusian-Moorish constructions (from San Juan del Sur), Lima and Trujillo and their rich colonial heritage.
- Visit one of the national parks of Costa Rica, pristine natural sanctuaries that cover almost a quarter of the country.
- After your cruise, the chance to discover the mythical site of Machu Picchu from Callao.

More informations on www.ponant.com

Adventure in Patagonia



The Strait of Magellan

This mythical strait situated in the South of Chile and separating South America from Tierra del Fuego, awakens our imagination, stirring up a longing for adventure. Follow in the footsteps of the famous Portuguese explorer Ferdinand Magellan, known for having organised the first circumnavigation of the globe in the 16th century. Aboard your ship, cruise along the 600 km separating the Atlantic Ocean from the Pacific, observe the tides and the currents and discover the many wild birds such as oystercatchers and steamer ducks that populate this remarkable zone.



Cape Horn

Discover the crucial passage sailors call “the Horn”. This legendary cliff stands some 425 metres tall and is the most southerly point of the lands attached to South America. Your ship will sail around the characteristic silhouette discovered in January 1616 by two Dutch sailors who named it after their hometown. Weather conditions permitting, you will disembark at the foot of the cape and climb up wooden steps to the imposing memorial dedicated to all the sailors who lost their lives rounding the cape. The sculpture depicts the slender silhouette of an albatross in flight. A solemn atmosphere reigns over this intensely wild land surrounded by a fierce and powerful ocean.

TALCAHUANO • USHUAIA
LE SOLÉAL, 22nd October 2020
USHUAIA • TALCAHUANO
LE BORÉAL, 2nd March 2021
LE SOLÉAL, 5th March 2021
13 days/12 nights
from € 5,130



DAY ITINERARY

- One-night stay at the hotel on the eve of embarkation.*
- Flight Buenos-Aires/Ushuaia (Argentina)**
Meet and greet and transfer to the port. Embarkation from 16.00 to 17.00 - Departure: 18.00
 - Sailing around Cape Horn**
 - Puerto Williams (Chile)**
 - Glacier Garibaldi (Chile)**
 - Glacier Agostini (Chile)**
 - Sailing the Strait of Magellan**
 - El Brujo Glacier (Chile)**
 - Pie XI Glacier/ English Passage**
 - Tortel (Chile)**
 - At sea**
 - Quemchi, Chiloe Island (Chile)**
 - At sea**
 - Talcahuano (Chile). Arrival: 07.00**
Disembarkation and transfer to the airport.
 - Flight Concepción / Santiago.**

This itinerary operates in both directions.

22nd October 2020 departure:
a cruise in partnership with **GEO**.



2nd March 2021 departure:
a cruise in partnership with



National Geographic Expeditions offering enrichment with a National Geographic Photographer and a destination expert onboard.

HIGHLIGHTS:

- **Outings and shore visits in Zodiac® inflatables** with a team of experienced naturalist guides.
- Observe glaciers, channels and fjords, and navigate along narrow passages.
- If weather conditions allow it, disembarking at Cape Horn.
- The stop in Tortel, a picturesque village with wooden pontoons and footbridges, listed as a **UNESCO World Heritage Site**.
- Depending on opportunities, observe Magellanic penguins, guanacos, caracaras, dolphins, humpback whales, fur seals, sea lions, alpacas, condors and cormorants.
- Landscapes: fjords dominated by the snowcapped peaks of the Andes and iridescent glaciers.

More informations on www.ponant.com

In the Heart of the Chilean Fjords



Quemchi, Chiloe Island

In southern Chile, in the Lake District, discover the small fishing port of Quemchi on the east coast of Chiloe Island. With its authentic charm, its pretty wooden houses, its narrow streets lined with small shops, and its fish market, this faraway village is sure to win you over. Be sure to visit the museum dedicated to Francisco Coloane, the famous Chilean author and adventurer born on this southern land. Not far from there, the small island called Isla Aucar, accessible via a wooden footbridge, will be a chance to observe a wide variety of birds and discover a magnificent botanical garden, home to many of the region's endemic plants.



Beagle Channel

At the extreme south of the continent, the Beagle Channel separates Isla Grande de Tierra del Fuego from a multitude of smaller islands, the last of which forms the majestic promontory of Cape Horn. The north-west branch of the canal is known as Glacier Alley: it is a succession of high walls of ice that finish their journey in the salty seawater. Each glacier has its own personality and name - the Dutch, the Italian, the French, the German... The combination of the forces of nature on display, the colours ranging from white to blue, the cracks as the sheets of ice collapse into the sea form a captivating spectacle.



TALCAHUANO • USHUAIA
L'AUSTRAL
 11 days/10 nights
 18th November 2020
 from € 4,650



DAY ITINERARY

DAY	ITINERARY
1	Flight Santiago / Concepción (Chile) Welcome and transfer to the port. Talcahuano (Chile) Embarkation from 16.00 to 17.00 - Departure: 18.00
2	At sea
3	Quemchi, Chiloe Island (Chile)
4	Sailing the Pulluche Canal (Chile)
5	Tortel (Chile)
6	English Passage / Pie XI Glacier (Chile)
7	El Brujo Glacier (Chile)
8	Agostini Glacier (Chile)
9	Garibaldi Glacier/ Fjord Pia (Chile)
10	Sailing around Cape Horn Puerto Williams (Chile)
11	Ushuaia (Argentina) Arrival: 07.00 - Disembarkation and transfer to the airport. Flight Ushuaia / Buenos Aires International (Pistarini).

HIGHLIGHTS:

- **Outings and shore visits in Zodiac® inflatables** with a team of experienced naturalist guides.
- Observe glaciers, channels and fjords, and navigating along narrow passages.
- If weather conditions allow it, disembark at Cape Horn and discover its albatross sculpture created by the Chilean artist José Balcells Eyquem.
- The stop in Tortel, a picturesque village with wooden pontoons and footbridges, listed as a **UNESCO World Heritage Site**.
- Sail along the Strait of Magellan (on the edge of Tierra del Fuego), and the Beagle Channel (with its so-called "Glacier Avenue").
- Depending on opportunities, observe Magellanic penguins, caracaras, dolphins, humpback whales, fur seals, sea lions, condors and cormorants.
- Landscapes: fjords dominated by the snow-capped peaks of the Andes, iridescent glaciers, and mountain lakes with crystal-clear water.

More informations on www.ponant.com

Shore Excursion Highlights

On the majority of your ports of call, we invite you to enhance your trip with specially designed, high-quality optional excursions. Whether cultural (visits of sites, monuments and museums that are emblematic of the region) or active (hikes, excursions on bikes or kayaks), you will certainly find something to suit you among the wide range we offer. The full tour programme is available on our website www.ponant.com 12 months prior to your cruise departure. You can also pre-book your PONANT shore-excursions up to 2 months before your cruise, and have them billed onboard. The final programme will be sent with your cruise documents.

Below you will find some examples of the key excursions available in the Caribbean and Latin America for the Winter 2020-2021 season.

In the Caribbean

Gustavia, Saint Barthelemy

Discover the marine life (2h)

€ € *

Embark a catamaran and start sailing to the best snorkelling spot, depending on the weather conditions. The snorkelling equipment (flippers, mask and snorkel) is provided for your convenience to enable discovery of the marine life in the crystal-clear waters, unless you chose to just relax on the catamaran!



Soufrière, Saint Lucia

Soufrière by sea and land (7h)

€ € € *

Discover the tropical natural wonders of Saint Lucia. The programme of this excursion includes a catamaran cruise along the lush green coastline and a swim in the turquoise water of a cove, the Soufrière volcano and its sulphurous emanations, a former plantation and the botanical gardens and waterfalls of Diamant.



Cartagena, Colombia

Mangroves in a traditional canoe (3h)

€ *

Onboard a traditional canoe, you will discover with local fishermen the mangroves, a protected eco-system teeming with birdlife. As you glide through the swampy waters, keep an eye out in the sky and you may be able to see kingfishers, white herons and pelicans.

Les Saintes, Guadeloupe

Discover Les Saintes aboard a sailing boat (3h)

€ € *

Board your sailing boat and start your scenic journey around the isles of Les Saintes. You will start your discovery by sailing in one of the most beautiful bays in the world, then you will reach the small uninhabited island of Grand Ilet, a paradise for tortoises and seabirds. Bathing and snorkelling are of course included!

Saint George's, Grenada

The secrets of the Spice island (7h 30)

€ € € *

Discover the many hidden treasures of the island of Grenada during this full day of excursion: picturesque coastlines shaped by volcanic relief, isolated beaches and estates sheltering cocoa and nutmeg plantations. Spices have pride of place here, hence the nickname "Spice Island".

Bonaire, Netherland Antilles

Marine park sail & snorkel tour (3h)

€ € *

Onboard a sailing ship, you will join the Bonaire National Marine Park, world famous for its active management of the island's marine resources. The park is a hotspot of Caribbean biodiversity and is home to an astonishing array of marine life. During a one-hour-an-a-half snorkel tour, you will swim above Bonaire's coral reefs, extending seaward for up to 984 feet.



Portsmouth, Dominica

Indian River by rowboat (2 h 30) €*

The Indian River is like a mini Amazon teeming with life. Experienced boatmen in hand-oared wooden rowboats will take you up the slow-moving river at a leisurely pace, so that you can appreciate the many types of wildlife and plant life along the swampy river banks.

South Friars Bay, Saint Kitts and Nevis

Essential St Kitts (4 h 45) €€*

This half-day of excursion offers a comprehensive overview of St Kitts. Your visits will include Brimstone Hill Fortress National Park, listed as World Heritage by UNESCO, the stunning Romney Manor Botanical Gardens, Caribelle Batik Studios and lastly Fairview House, a beautiful, 300-year-old property which stands as a perfect example of a colonial house.

In Latin America

Dos Bocas, Mexico

Palenque archaeological site (10h) €€€€€*

Immerse yourself in the mysterious atmosphere of the former Mayan city of Palenque, at the heart of the misty Chiapas jungle. Temples and palaces typical of the classical period of the Mayan era are proof of the creative genius of this civilisation, whilst the fine sculpted bas-reliefs superbly illustrate Mayan mythology.



Belize City, Belize

Xunantunich archaeological site (7h) €€€*

Discover Xunantunich Mayan archaeological site, a major ceremonial centre during the Classic Period. It is composed of six major plazas, surrounded by more than 25 temples and palaces. Located on a natural limestone ridge, the site provides panoramic views of the hilly Cayo District.



Callao, Peru

Larco Herrera Museum & Indian market (4 h 45) €€€*

Don't miss a visit to the Larco Herrera Museum, housed in an elegant vice-royal colonial mansion of the 18th century. The museum has an extensive private collection of pre-Inca ceramics – probably the largest collection of its kind in the world. Then, stop at the Indian market, offering handicrafts from all over Peru.

Casa Orquideas, Costa Rica

Botanical garden & beach escape (2 h 30) INCLUDED

A Zodiac® will transport you for a wet landing on a beach close to Casa Orquideas, a beautiful botanical garden project that holds an amazing tropical flora collection of both native and species from around the world. A place to let our senses go wild, touching, tasting and smelling some of the most incredible plants and flowers of all shapes and colours!

Progreso, Mexico

Chichén Itzá (7 h 30) €€€€€*

Visit Mexico's most famous archaeological site, Chichen Itza! Follow your guide and see the most famous structures including the pyramid shaped "El Castillo" that was built in accordance with the Mayan calendar and with their extensive knowledge of astronomy, the Temple of the Warriors with hundreds of carved columns and the great Ball Court.

Coquimbo, Chile

Petroglyphs & Tabali winery (4 h 45) €€€€*

Head inland from the arid coastal landscape to reach the Enchanted Valley! Excavations in this valley have shown a true open air museum of great scientific and cultural interest, with many pictographs and petroglyphs built by the Indians of the El Molle Culture. Then you will visit the Tabali Winery before tasting its most representative and award-winning wines.

Acajutla, El Salvador

Maya Route & Santa Ana (10 h 15) €€€€€*

Take the chance to visit two major archaeological sites in el Salvador! First Joya de Ceren, the "Pompeii of the Americas", listed as a UNESCO World Heritage Site, then the Mayan ruins at Tazumal National Park, an impressive array of tombs and pyramids. This tour is followed with a stop in the town of Santa Ana, where you will attend a private folkloric dance show.

Paramaribo, Surinam

Paramaribo city tour (3h) €€€*

The 17th-century capital of Suriname is graced with attractive Dutch, French, Spanish and British colonial architecture and placed on the UNESCO World Heritage List. You will visit the Hindu Temple - one of the largest in the Caribbean, then Fort Zeelandia and its museum, and also the Saint Peter & Paul Cathedral, completely built in wood.

*Price per person: € = less than € 50, €€ = from € 50 to € 100, €€€ = from € 100 to € 150, €€€€ = more than € 150.

Pre-Bookable Excursions

Reservation and payment must be made when booking your cruise or at least 60 days prior to departure date.

Full tour programme and prices are available on our website, www.ponant.com 12 months prior to your cruise, or from your travel agent. A minimum of participants is required to confirm.



From Callao (Peru)

Cuzco and Machu Picchu (3 days/2 nights)

From Callao, you will take a flight to Cuzco, the ancient capital of the Inca Empire, with its architecture made up of huge and perfectly aligned dry stone walls. The day after, you will set out towards the legendary site of Machu Picchu. A UNESCO World Heritage Site, it is not only a jewel of Inca architecture but also the ultimate expression of man working in harmony with the environment. Since it was discovered, this granite city built on tiered terraces has remained shrouded in deep mystery.

Guayaquil • Talcahuano - 9th October 2020 aboard *Le Soléal*
Talcahuano • Guayaquil - 14th March 2021 aboard *Le Boréal*



From Puerto Cortés, Honduras

Copán by air (10 h)

From Puerto Cortés, you will fly to the archaeological site of Copán, a UNESCO World Heritage Site located in the middle of the jungle. With your guide, you will discover this major testimony to Mayan civilisation, with a commented tour of its main monumental achievements such as the Acropolis and its huge plazas and many temples, then the remarkable Hieroglyphic Stairway. The risers of this imposing staircase feature more than 1,800 hieroglyphic symbols; these form the longest known Mayan text and are therefore of significant historic importance.

Overland available on all departures for « **Natural and Cultural Wonders of the western Caribbean** » aboard *Le Champlain*.



From Pisco (Peru)

Flight over the Nazca Lines (4 h)

Drawing gigantic geometric shapes, the enigmatic Nazca Lines cover 450 km² of archaeological mysteries. Monkey, spider, lizard, whale and other plant figures are cut and interlaced in the earth, and only observable from the air. You will board small planes at Nazca airport for an unforgettable 30-minute flight over these mysterious lines. You will grasp their greatness from the air and thus, you may be able to answer the question: how and why were these lines drawn so many centuries ago?

Guayaquil • Talcahuano - 9th October 2020 aboard *Le Soléal*
Talcahuano • Guayaquil - 14th March 2021 aboard *Le Boréal*

From Santo Tomás de Castilla and Puerto Quetzal (Guatemala)

Tikal by air (10 h)

Fly to Tikal, one of the greatest Maya cities known and studied to date, declared a World Heritage Site by UNESCO. From the entrance of the National Park, stroll along dirt roads and pathways leading back in time. A mysterious realm unfolds upon entering the forested surroundings that now involve the ruins. You will visit the most impressive structures, including the Pyramid of the Great Jaguar, and your guide will explain the theories about life in the time of the Mayas.

Overland available on all departures for « **Natural and Cultural Wonders of the western Caribbean**» aboard *Le Champlain*.

Colón • Miami - 9th April 2021 aboard *Le Boréal*
Guayaquil • Colón - 27th March 2021 aboard *Le Boréal*



From Guayaquil (Ecuador)

Quito by air (13 h)

From Guayaquil, you will have the opportunity to discover Quito and its best-preserved, least altered historic centre in Latin America, listed in UNESCO's World Heritage Sites. You will discover the cultural heritage of Quito, with the famous "Compañía" dubbed as the most beautiful church in Latin America, or the beautiful Plaza San Francisco and its convent. After lunch, drive to El Panecillo, the landmark hill rising at the Southern edge of the historic centre.

Puerto Quetzal • Callao - 19th October 2020 aboard *L'Austral*



From Belize City (Belize)

Discovering the Blue Hole (2 h)

Take your seat aboard a private charter plane and fly southward over the barrier reef to reach St George's Caye. Then, head east toward the Turneffe and Lighthouse Reef atolls, then on to Half Moon Caye to reach the Great Blue Hole. Your plane will linger over this wonder of the world, making several passes to give you the best view of the Blue Hole. Return will be via Northern Two Cayes and north Ambergris, near Rocky Point, then over the town of San Pedro and back to the airport after a one-hour-and-15-minute flight.

Overland available on all departures for « **Natural and Cultural Wonders of the western Caribbean**» aboard *Le Champlain*.



Pre & post cruise programmes

We invite you to enhance your cruise and extend your trip with carefully designed, high-quality programmes organised to tie in with the flights selected by PONANT. These are group excursions and are available either immediately before or after your cruise; they must be booked before departure. Please find below samples of the programmes available in the Caribbean and Latin America for Winter 2020-2021 season. Full tour programme and prices are available on our website www.ponant.com 12 months prior to your cruise departure, or from your travel agent.

Colón, Panama

Panama City, its Canal and its cultural heritage (3 days/2 nights)

Take advantage of 2 days to discover the historical wealth of Casco Antiguo, the old centre of Panama City. Discover the beautiful buildings inspired by colonial and Baroque architecture, and visit the Biomuseo, its famous museum designed by Gehry and dedicated to Panama's biodiversity. Don't miss the famous Miraflores Locks, permitting huge ships to sail from one ocean to the other, and a cruise aboard local boats along the islands of Lake Gatun.

Your pre-cruise programme:

Colón • Puerto Caldera - 29th December 2020 aboard *Le Champlain*
Colón • Puerto Caldera - 4th January 2021 aboard *Le Dumont-d'Urville*
Colón • Fort-de-France - 12th January 2021 aboard *Le Champlain*
Colón • Fort-de-France - 1st March 2021 aboard *Le Dumont-d'Urville*
Colón • Miami - 9th April 2021 aboard *Le Boréal*



Guayaquil, Ecuador

The Galapagos, natural Paradise (4 days/4 nights)

Enjoy four unforgettable days to discover an earthly paradise with flora and fauna unique in the world. From the island of Santa Cruz, explore the nearby islands for giant turtles, iguanas, frigate birds and sea lions, and dive into turquoise waters with penguins.

Your pre-cruise programme:

Guayaquil • Talcahuano - 9th October 2020 aboard *Le Soléal*
Guayaquil • Colón - 27th March 2021 aboard *Le Boréal*

Your post-cruise programme (3 nights) :

Puerto Quetzal • Guayaquil - 26th September 2020 aboard *Le Soléal*
Talcahuano • Guayaquil - 14th March 2021 aboard *Le Boréal*



Puerto Morelos, Mexico

Treasures of the Maya Riviera (2 days/2 nights)

Discover the Mayan sites of Tulum and Muyil with your guide. The archaeological site of Tulum sits on a rocky headland and overlooks the turquoise waters of the Caribbean Sea. It includes still-painted vestiges and interesting stucco decorations. As for the Muyil ruins, they are nestled in the heart of the tropical rainforest in the Sian Ka'an Biosphere Reserve, not far from a lagoon... You will reach them by boat, along one of the ancient waterways once used by the Maya for trade and bartering. A fascinating glimpse into a lost civilisation!

Your pre-cruise programme:

Overland available on all departures « Belize & Mayan Treasures » aboard *Le Champlain*.



Puerto Quetzal, Guatemala

Maya site of Tikal and Colonial La Antigua

(2 days/2 nights)

This programme enables you to discover two major sites listed with UNESCO: the Mayan pyramids of Tikal and the colonial city of Antigua Guatemala. After spending the night in Guatemala City, a morning flight will take you to Tikal National Park. Standing in the heart of the jungle, the temples, palaces and other vestiges bear witness to the importance of this Pre Columbian site. You will spend the second day visiting the colonial city and its stunning monuments inspired by the Italian Renaissance.

Your pre-cruise programme:

Puerto Quetzal • Guayaquil - 26 September 2020 aboard *Le Soléal*
Puerto Quetzal • Callao - 19th October 2020 aboard *L'Austral*



Puerto Caldera, Costa Rica

Natural Wonders of Costa Rica

(3 days/3 nights)

Take advantage of three days to discover the natural wonders of Costa Rica's national parks. Take a hike to get as close as possible to the craters of active volcanoes, such as the Poás Volcano or the Arenal volcano and its near perfect cone shape. Travel down the Peñas Blancas River by boat through a lush forest and observe the rich diversity of its tropical fauna.

Your pre-cruise programme:

Puerto Caldera • Colón - 5th January 2021 aboard *Le Champlain*



Talcahuano, Chile

The Atacama Desert (4 days/3 nights)

After a visit to the historic centre of Santiago and a domestic flight to Calama, you will discover the world's most arid desert, its Inca ruins and fortresses and its vast expanses between the Pacific Ocean and the Andes cordillera. The Atacama Salt Flats, the largest in Chile, are scattered with lakes and lagoons that are home to birds including Chilean flamingos. A few kilometres from there, the Valley of the Moon, sculpted by the wind and the sun, will reveal its most beautiful lights and colours at dusk.

Your pre-cruise programme:

Talcahuano • Ushuaia - 22nd October 2020 aboard *Le Soléal*
Talcahuano • Ushuaia - 18th November 2020 aboard *L'Austral*
Talcahuano • Guayaquil - 14th March 2021 aboard *Le Boréal*



Your post-cruise programme:

Guayaquil • Talcahuano - 9th October 2020 aboard *Le Soléal*
Ushuaia • Talcahuano - 2nd March 2021 aboard *Le Boréal*
Ushuaia • Talcahuano - 5th March 2021 aboard *Le Soléal*

Ushuaia, Argentina

Patagonia, land of contrasts (5 days/4 nights)

With this rich and varied programme, discover the highlights of the attractive and pulsating capital of Argentina, then explore the spectacular glacier of Perito Moreno, and its huge deep blue ice walls. Admire the wilderness of Patagonia in the nature reserve of Torres del Paine, with lakes, glaciers, ancient forests, and a rich fauna including guanacos, foxes, pumas and a diverse array of birds.

Your pre-cruise programme:

Ushuaia • Talcahuano - 2nd March 2021 aboard *Le Boréal*
Ushuaia • Talcahuano - 5th March 2021 aboard *Le Soléal*

Cayenne, French Guiana

Kaw marshes by dug-out canoe (1 day/1 night)

Upon arrival at Kaw, you will board a motorised pirogue boat and will visit this magnificent reserve, the largest wetland and the third largest French nature reserve with a surface area of 234,000 acres (94,700 ha). A naturalist guide will accompany you during this discovery of the rich and varied wildlife, particularly the bird life of this biotope: herons, ospreys, kingfishers, sandpipers... You will sail along part of the Wapou Creek which gradually heads deeper into the primary, flooded forest. There you will find remarkable plant varieties and will be serenaded by the sounds of the forest.

Your pre-cruise programme:

Cayenne • Cayenne - 17th and 29th November 2020, 20th March and 1st April 2021 aboard *Le Dumont-d'Urville*

The PONANT Fleet *in The Caribbean and Latin America*

Fluid lines, streamlined bow: the exterior lines of our ships reflect the spirit of a subtly revisited nautical theme.

Aboard, our guests truly enjoy the relaxed elegance of the atmosphere, luxury amenities and service, experiencing a different and exclusive type of cruise.

A concept of travel that is both intimate and luxurious.

Welcome aboard!





Luxury Cruising, PONANT Style

With PONANT, access the world's treasures by sea, aboard luxurious limited-capacity small ships. French crew, expertise, attentive service, gastronomy: the promise of rare and special moments in a luxurious environment, for an immersive and refined travel experience.



Limited-capacity ships, personalised service

Our ships are designed to accommodate a limited number of guests, with just 92 staterooms and suites on our PONANT EXPLORERS series, 132 on *L'Austral*, *Le Boréal* and *Le Soléal*. This focus on a smaller number of staterooms is a far cry from the current industry trend towards gigantism and guarantees an aura of exclusivity for our guests. Because our ships are smaller, they can easily access original and less crowded ports of call.

Just like on a private yacht, our crew are determined to give each guest attentive and personalised service. And for even more comfort and peace of mind, our guests travelling in some of these suites have a butler at their disposal.





The French Touch

PONANT is currently the only cruise line to sail under the French flag and as such is subject to some of the world's strictest safety standards. Our officers are French and our highly approachable crew mainly bi-lingual. All announcements and presentations are made in both French and English.

PONANT extends this French Touch to the design, decor, service and gastronomy. Our carefully selected partners represent and perpetuate the French standard of excellence. Enjoy relaxed elegance in a luxurious environment, whatever your destination.



A journey to the land of flavours

Whether you are having breakfast among friends with the horizon as special guest, a sun-kissed lunch on one of our exterior decks, or a delicious dinner prepared by our talented chefs in the elegant setting of our gastronomic restaurants, you will enjoy our refined and varied cuisine, served with a selection of wines presented by our expert sommeliers.

To continue its route to excellence aboard its ships, PONANT joined forces with Ducasse Conseil, a catering centre of excellence run by Alain Ducasse Entreprise.



Spa & wellbeing between sea and sky

Your cruise is the ideal moment for treating yourself, and that is why PONANT has joined forces with the leading French cosmetic house, SOTHYS™ to offer you a series of expert, top-of-the-range treatments. The spa, the gym with large plate glass windows, the heated saltwater pool and the hair salon are an invitation to total relaxation on board.



1 - L'Austral
2 - Le Soléal Swimming Pool
3 - Blue Eye underwater lounge
4 - Owner's Suite on board Le Champlain





Our Ships

Fluid lines, streamlined bow, and an appearance enhanced by two glass arches which let in light and provide water views: the exterior lines of our ships reflect the spirit of a subtly revisited nautical theme. Aboard, our passengers truly enjoy the relaxed elegance of the atmosphere and experience a different and exclusive type of cruise, a concept of travel that is intimate, luxurious and memorable...

Le Boréal, L'Austral and Le Soléal

Fitted with only with 132 carefully designed cabins and suites, 95% with private balcony and all with sea views, *Le Boréal*, *L'Austral* and *Le Soléal* are perfectly in harmony with PONANT's policy of offering all passengers exacting levels of service and real contact with the crew, and by virtue of their compact size have the advantage of being able to sail close to the Latin America and Caribbean coasts. These limited capacity ships are perfectly suited to island and city-hopping. They boast large windows and exterior decks so guests can enjoy breath-taking views to the horizon. On board, great food takes centre stage, paying tribute to the French culinary tradition in a setting that is worthy of the finest restaurants.

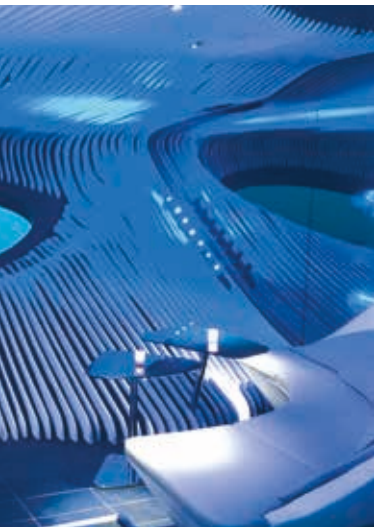

Le Champlain and Le Dumont-d'Urville

128 metres long, and just 88 cabins, each with a private balcony, 4 suites, each with a plate glass window and private terrace... Aboard the PONANT EXPLORERS, the newest ships of the company, passengers find all of the special touches that have forged the reputation of PONANT. The smaller capacity creates an intimate atmosphere, while the 110 crew members provide professional and attentive service. These ships of the PONANT EXPLORERS series are equipped with an exclusive underwater lounge, called *Blue Eye*. This lounge enables PONANT guests to become sub-aquatic explorers, in the heart of an underwater universe where all of their senses will be stimulated. These new stars of the PONANT fleet are fitted with a movable marina platform, enabling guests to swim and engage in other activities directly from the ship. A submersible mini-port provides easy access to a number of nautical activities (including kayaking and paddle boarding).



Because we believe that a responsible approach is required in our quest for excellence, PONANT chose to equip our sisterships with ecologically efficient equipment. As a result, *Le Boréal*, *L'Austral* and *Le Soléal* as *Le Champlain* and *Le Dumont-d'Urville* have been awarded the international "Clean Ship" certification.

Le Boréal, Le Soléal & L'Austral Deck Plans

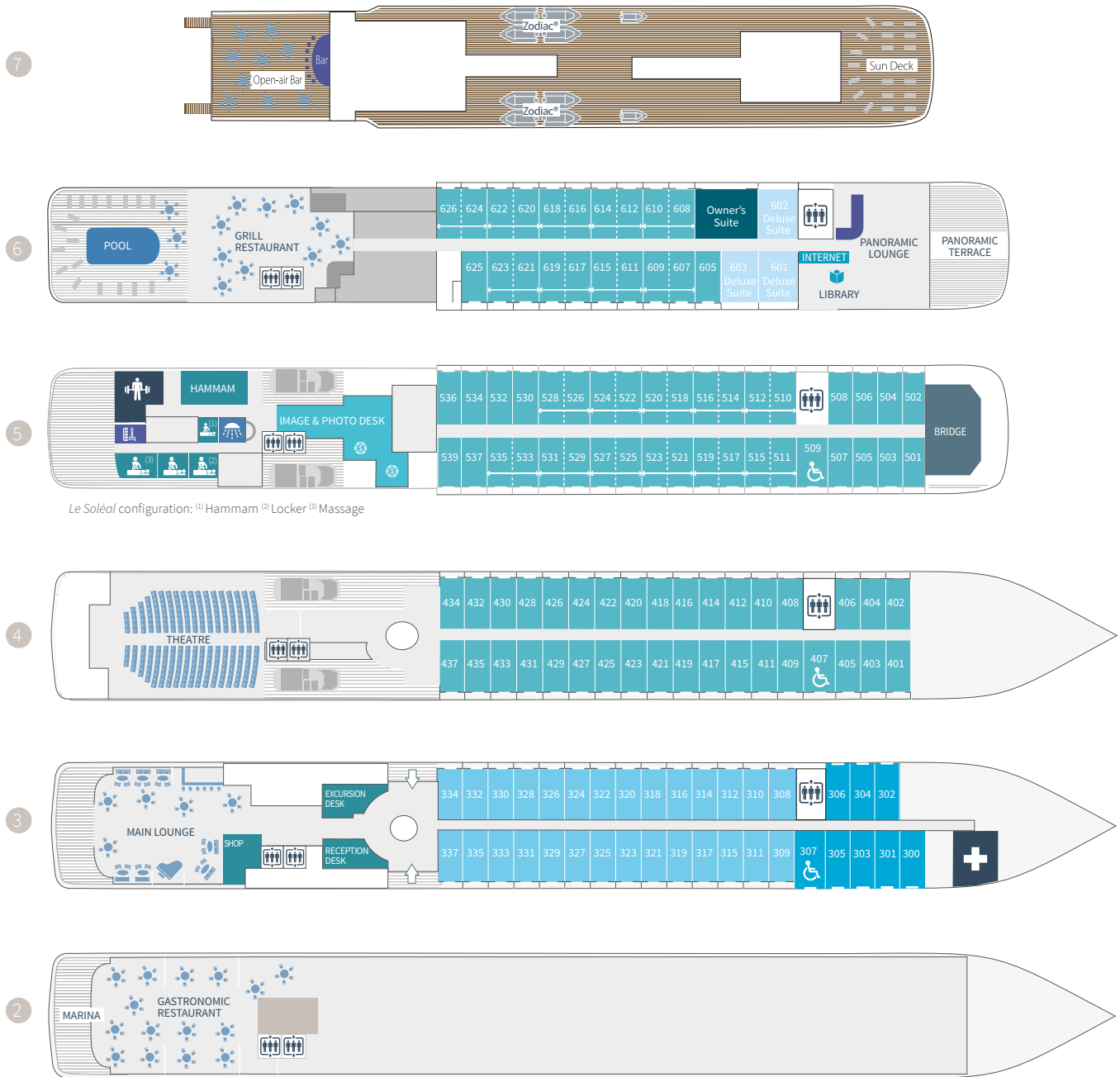

Le Soléal configuration: ⁽¹⁾ Hammam ⁽²⁾ Locker ⁽³⁾ Massage

- 2 Gastronomic Restaurant - Marina
- 3 28 Deluxe Staterooms with private balcony
8 Superior Staterooms (Staterooms 300 & 301 have a porthole) - Main Lounge - Shop - Reception desk - Excursion desk - Medical centre
- 4 35 Prestige Staterooms with private balcony - Theatre
- 5 37 Prestige Staterooms with private balcony (with 22 Prestige Staterooms convertible into 11 Prestige Suites) - Fitness - Beauty Corner Sothys™: Hammam, Massage, Hairdresser (Le Boréal and L'Austral)- Image & photo desk - Bridge
- 6 **Le Boréal, L'Austral, Le Soléal:** Owner's Suite - 3 Deluxe Suites with private balcony - 20 Prestige Staterooms with private balcony (with 18 Prestige Staterooms convertible into 9 Prestige Suites) - Pool - Grill Restaurant - Internet space - Library - Panoramic lounge - Panoramic terrace
- 7 Open-air bar - Sun deck

Owner's Suite Deck 6	Deluxe Suites Deck 6	Deluxe Staterooms Deck 3
Prestige Suites Deck 6 - 5	Prestige Staterooms Deck 4 - 5 - 6	Superior Staterooms Deck 3

Discover Your Stateroom

*Elegant and flexible Suites and Staterooms,
decorated by French interior designers, all with sea view.*

Accommodation

OWNER'S SUITE (45 sq.m + 9 sq.m. private balcony / 484 sq.ft. + 97 sq.ft. private balcony)

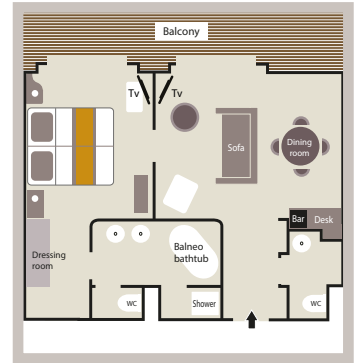

20 PRESTIGE SUITES (36 sq.m. + 8 sq.m. private balcony / 398 sq.ft. + 86 sq.ft. private balcony)

92 PRESTIGE STATEROOMS (18 sq.m. + 4 sq.m. private balcony / 200 sq.ft. + 43 sq.ft. private balcony)

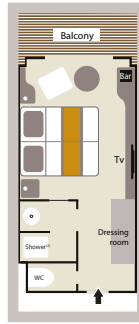
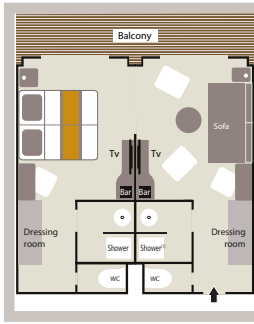

3 DELUXE SUITES (27 sq.m. + 6 sq.m. private balcony / 290 sq.ft. + 54 sq.ft. private balcony)

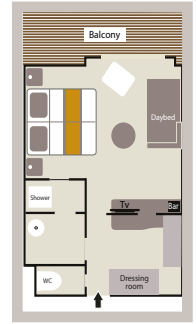

⁽¹⁾ Prestige Suites aboard *Le Boréal & Le Soléal*: 1 shower and 1 bathtub.

⁽²⁾ Prestige Staterooms aboard *Le Boréal & Le Soléal*, decks 5 & 6: 1 shower or bathtub depends on staterooms.

Deluxe Suites aboard *Le Boréal*: 1 shower and 1 bathtub.

28 DELUXE STATEROOMS

(18 sq.m. + 4 sq.m. private balcony / 200 sq.ft. + 43 sq.ft. private balcony)

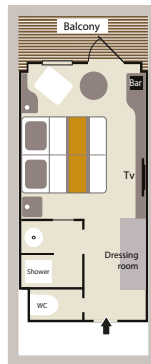

8 SUPERIOR STATEROOMS

(21 sq.m. / 226 sq.ft.)

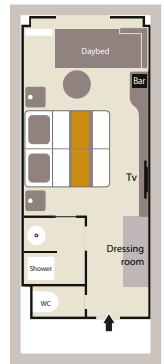

Amenities

- Individually-controlled airconditioning
- Stateroom layout: king-size bed, or twin beds, interconnecting Staterooms available (Children welcome)
- Minibar
- Flat screen satellite TV
- iPod™ docks
- Desk with stationery
- Safe

- Hermes bath products
- Dressing table, bath robes, hairdryer
- Direct line telephone
- 110V American (two flat pins) / 220V European (round sockets with two round pins)
- 24hr room service
- Free and Unlimited Internet Wifi access

Le Champlain & Le Dumont-d'Urville Deck Plans

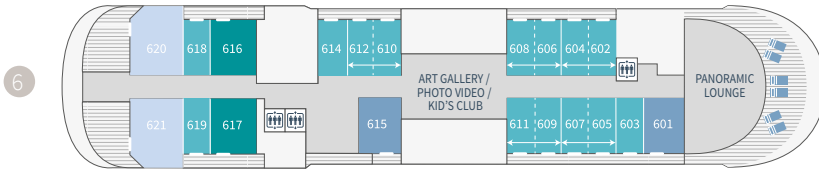
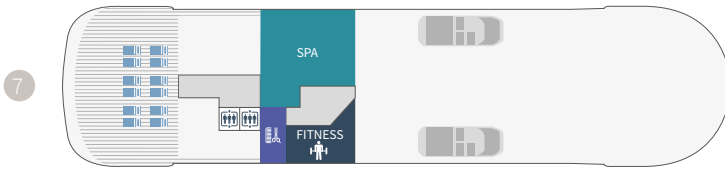

Aboard *Le Champlain*, the Owner's Suite is located on deck 6 (Suite 621).



Aboard *Le Champlain*, the Suite 535 located on deck 5 is a Grand Deluxe Suite.

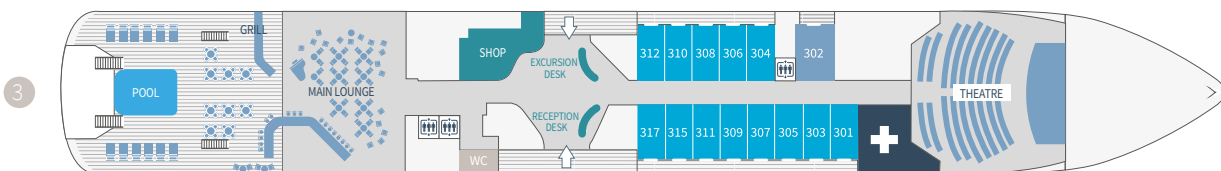

- 7 Fitness - Ponant Yacht Spa - Sundeck
- 6 Panoramical lounge - 14 Prestige Staterooms (including 10 Prestige Staterooms convertible into 5 Luxury Suites) - 2 Deluxe Suites - 2 Privilege Suites - 1 Grand Deluxe Suite - 1 Owner's Suite
- 5 Bridge - 29 Prestige Staterooms (including 1 for person of reduced mobility and 26 Prestige Staterooms convertible into 13 Prestige Suites) - 1 Deluxe Suite - 2 Privilege Suites - 2 Grand Deluxe Suites
- 4 Restaurant - 23 Prestige Staterooms (including 1 for person of reduced mobility) - 1 Deluxe Suite
- 3 Reception Desk - Excursion Desk - Main Lounge - Pool Deck - Shop - Medical Centre - Theatre - 13 Deluxe Staterooms - 1 Deluxe Suite
- 2 Marina
- 0 DECK 0: Blue Eye underwater lounge

■ Owner's Suite Deck 5 (Deck 6 aboard <i>Le Champlain</i>)	■ Grand Deluxe Suites Deck 5 - 6	■ Deluxe Suites Deck 3 - 4 - 5 - 6	■ Deluxe Staterooms Deck 3
■ Privilege Suites Deck 5 - 6	↔ Prestige Suites Deck 5 - 6	■ Prestige Staterooms Deck 4 - 5 - 6	

Discover Your Stateroom

*Elegant and flexible Suites and Staterooms,
decorated by French interior designers, all with sea view.*

Accommodation

OWNER'S SUITE

45 sq.m + 30 sq.m. private terrace with hot tub and sliding bay windows
484 sq.ft + 328 sq.ft. private terrace with hot tub and sliding bay windows



3 GRAND DELUXE SUITES

45 sq.m + 30 sq.m. private terrace and sliding bay windows
484 sq.ft + 328 sq.ft. private terrace and sliding bay windows

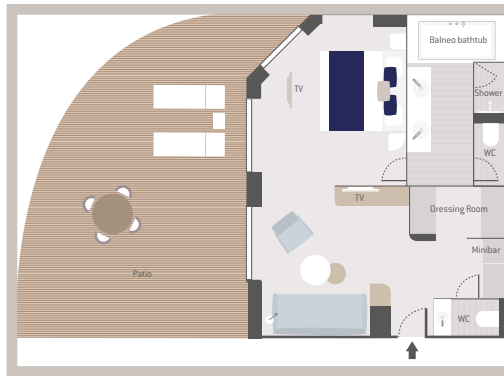

4 PRIVILEGE SUITES

32 sq.m + 8 sq.m. private balcony with sliding bay window
344 sq.ft + 86 sq.ft. private balcony with sliding bay window

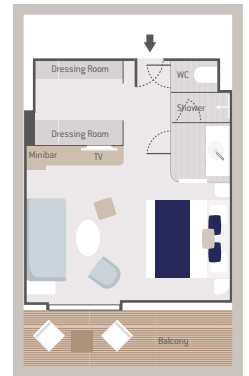

18 PRESTIGE SUITES

38 sq.m + 8 sq.m. private balcony with sliding bay window
409 sq.ft + 86 sq.ft. private balcony with sliding bay window

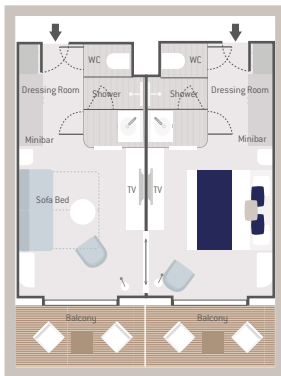

66 PRESTIGE STATEROOMS

19 sq.m + 4 sq.m. private balcony with sliding bay window
204 sq.ft + 43 sq.ft. private balcony with sliding bay window

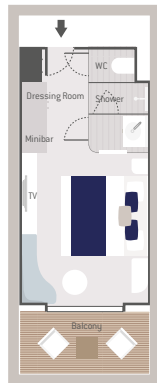

5 DELUXE SUITES

27,5 sq.m + 6 sq.m. private balcony with sliding bay window
291 sq.ft + 65 sq.ft. private balcony with sliding bay window

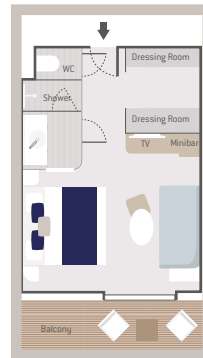

13 DELUXE STATEROOMS

19 sq.m + 4 sq.m. private balcony with French window
204 sq.ft + 43 sq.ft. private balcony with French window

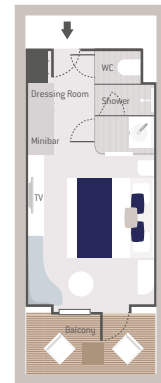

Amenities

- Individually-controlled airconditioning
- Stateroom layout: king-size bed, or twin beds, interconnecting Staterooms available (Children welcome)
- Minibar
- Flat screen satellite TV
- Video on demand
- iPod™ docks
- Desk with stationery
- Safe
- Hermes bath products
- Dressing table, bath robes, Hairdryer
- Direct line telephone
- 110V American (two flat pins) /220V European (round sockets with two round pins)
- 24hr room service
- Free and unlimited Internet Wifi access

Price List

The rates of our cruises are per person, based on double-occupancy and including taxes.

For single-occupancy rates, please contact us.

For details, please refer to General and Particular Terms and Conditions of Sale, see pages 68 to 72.

L' Austral

SAN DIEGO - PUERTO QUETZAL on 07th Oct. 2020; 12 nights The Sea of Cortez		
		
Superior Stateroom	€ 6,250	€ 4,550
Deluxe Stateroom	€ 6,750	€ 4,900
Prestige Stateroom - Deck 4	€ 7,560	€ 5,470
Prestige Stateroom - Deck 5	€ 7,940	€ 5,730
Prestige Stateroom - Deck 6	€ 8,340	€ 6,010
Deluxe Suite	€ 11,670	€ 8,340
Prestige Suite - Deck 5	€ 15,880	€ 11,290
Prestige Suite - Deck 6	€ 16,680	€ 11,850
Owner's Suite	€ 19,180	€ 19,180
Safety and port taxes (included)	€ 600	

PUERTO QUETZAL - CALLAO on 19th Oct. 2020; 12 nights Jewels of Latin America		
		
Superior Stateroom	€ 5,090	€ 3,740
Deluxe Stateroom	€ 5,500	€ 4,030
Prestige Stateroom - Deck 4	€ 5,830	€ 4,260
Prestige Stateroom - Deck 5	€ 6,000	€ 4,370
Prestige Stateroom - Deck 6	€ 6,180	€ 4,500
Deluxe Suite	€ 8,350	€ 6,020
Prestige Suite - Deck 5	€ 9,000	€ 6,480
Prestige Suite - Deck 6	€ 9,270	€ 6,660
Owner's Suite	€ 9,740	€ 9,740
Safety and port taxes (included)	€ 600	

TALCAHUANO - USHUAIA on 18th Nov. 2020; 10 nights In the heart of Chilean Fjords		
		
Superior Stateroom	€ 6,110	€ 4,650
Deluxe Stateroom	€ 6,540	€ 4,950
Prestige Stateroom - Deck 4	€ 7,230	€ 5,430
Prestige Stateroom - Deck 5	€ 7,560	€ 5,660
Prestige Stateroom - Deck 6	€ 7,900	€ 5,900
Deluxe Suite	€ 10,760	€ 7,900
Prestige Suite - Deck 5	€ 14,370	€ 10,430
Prestige Suite - Deck 6	€ 15,050	€ 10,910
Owner's Suite	€ 17,190	€ 17,190
Safety and port taxes (included)	€ 500	
Flights and transfers (included)	€ 720	
Airport taxes (included)	€ 30	

Le Boréal

USHUAIA - TALCAHUANO on 02nd March 2021; 12 nights Adventure in Patagonia		
		
Superior Stateroom	€ 8,280	€ 6,330
Deluxe Stateroom	€ 8,840	€ 6,720
Prestige Stateroom - Deck 4	€ 9,760	€ 7,370
Prestige Stateroom - Deck 5	€ 10,190	€ 7,670
Prestige Stateroom - Deck 6	€ 10,640	€ 7,980
Deluxe Suite	€ 14,410	€ 10,620
Prestige Suite - Deck 5	€ 19,180	€ 13,960
Prestige Suite - Deck 6	€ 20,070	€ 14,580
Owner's Suite	€ 22,910	€ 22,910
Safety and port taxes (included)	€ 600	
Flights and transfers (included)	€ 1,170	
Airport taxes (included)	€ 30	

TALCAHUANO - GUAYAQUIL on 14th March 2021; 13 nights Cordillera & Andean Secrets		
		
Superior Stateroom	€ 5,220	€ 3,910
Deluxe Stateroom	€ 5,620	€ 4,190
Prestige Stateroom - Deck 4	€ 5,950	€ 4,420
Prestige Stateroom - Deck 5	€ 6,120	€ 4,540
Prestige Stateroom - Deck 6	€ 6,300	€ 4,660
Deluxe Suite	€ 8,430	€ 6,150
Prestige Suite - Deck 5	€ 9,070	€ 6,600
Prestige Suite - Deck 6	€ 9,340	€ 6,790
Owner's Suite	€ 9,790	€ 9,790
Safety and port taxes (included)	€ 650	
Flight and transfer (included)	€ 200	
Airport taxes (included)	€ 10	

GUAYAQUIL - COLÓN on 27th March 2021; 13 nights Treasures of Central America		
		
Superior Stateroom	€ 6,090	€ 4,450
Deluxe Stateroom	€ 6,570	€ 4,790
Prestige Stateroom - Deck 4	€ 6,970	€ 5,070
Prestige Stateroom - Deck 5	€ 7,180	€ 5,220
Prestige Stateroom - Deck 6	€ 7,390	€ 5,360
Deluxe Suite	€ 9,980	€ 7,180
Prestige Suite - Deck 5	€ 10,770	€ 7,730
Prestige Suite - Deck 6	€ 11,090	€ 7,950
Owner's Suite	€ 11,650	€ 11,650
Safety and port taxes (included)	€ 650	

Le Soléal

COLÓN - MIAMI on 09th April 2021; 11 nights Treasures of the Caribbean Sea		
		
Superior Stateroom	€ 5,210	€ 3,810
Deluxe Stateroom	€ 5,630	€ 4,100
Prestige Stateroom - Deck 4	€ 5,960	€ 4,330
Prestige Stateroom - Deck 5	€ 6,140	€ 4,460
Prestige Stateroom - Deck 6	€ 6,330	€ 4,590
Deluxe Suite	€ 8,540	€ 6,140
Prestige Suite - Deck 5	€ 9,220	€ 6,610
Prestige Suite - Deck 6	€ 9,490	€ 6,800
Owner's Suite	€ 9,970	€ 9,970
Safety and port taxes (included)	€ 550	

MIAMI - LISBON on 20th April 2021; 14 nights Transatlantic Voyage from Miami to Lisbon		
		
Superior Stateroom	€ 5,210	€ 3,850
Deluxe Stateroom	€ 5,620	€ 4,140
Prestige Stateroom - Deck 4	€ 5,960	€ 4,380
Prestige Stateroom - Deck 5	€ 6,140	€ 4,500
Prestige Stateroom - Deck 6	€ 6,320	€ 4,630
Deluxe Suite	€ 8,540	€ 6,180
Prestige Suite - Deck 5	€ 9,210	€ 6,650
Prestige Suite - Deck 6	€ 9,480	€ 6,840
Owner's Suite	€ 9,960	€ 9,960
Safety and port taxes (included)	€ 700	

SAN DIEGO - PUERTO QUETZAL du 13th Sept. 2020; 13 nights The Sea of Cortez		
		
Superior Stateroom	€ 7,790	€ 5,640
Deluxe Stateroom	€ 8,410	€ 6,080
Prestige Stateroom - Deck 4	€ 9,420	€ 6,780
Prestige Stateroom - Deck 5	€ 9,890	€ 7,110
Prestige Stateroom - Deck 6	€ 10,390	€ 7,460
Deluxe Suite	€ 14,540	€ 10,370
Prestige Suite - Deck 5	€ 19,790	€ 14,040
Prestige Suite - Deck 6	€ 20,780	€ 14,740
Owner's Suite	€ 23,890	€ 23,890
Safety and port taxes (included)	€ 650	



PUERTO QUETZAL - GUAYAQUIL
on 26th Sept. 2020; 13 nights
Natural Wonders of Central America

NATIONAL GEOGRAPHIC
 PONANT BONUS
 Up to -30%

Superior Stateroom	€ 6,290	€ 4,580
Deluxe Stateroom	€ 6,800	€ 4,940
Prestige Stateroom - Deck 4	€ 7,210	€ 5,220
Prestige Stateroom - Deck 5	€ 7,430	€ 5,380
Prestige Stateroom - Deck 6	€ 7,650	€ 5,530
Deluxe Suite	€ 10,350	€ 7,420
Prestige Suite - Deck 5	€ 11,170	€ 7,990
Prestige Suite - Deck 6	€ 11,500	€ 8,220
Owner's Suite	€ 12,080	€ 12,080
Safety and port taxes (included)	€ 600	

GUAYAQUIL - TALCAHUANO
on 09th Oct 2020; 13 nights
Cordillera & Andean Secrets

PONANT BONUS
 Up to -30%

Superior Stateroom	€ 5,220	€ 3,910
Deluxe Stateroom	€ 5,620	€ 4,190
Prestige Stateroom - Deck 4	€ 5,950	€ 4,420
Prestige Stateroom - Deck 5	€ 6,120	€ 4,540
Prestige Stateroom - Deck 6	€ 6,300	€ 4,660
Deluxe Suite	€ 8,430	€ 6,150
Prestige Suite - Deck 5	€ 9,070	€ 6,600
Prestige Suite - Deck 6	€ 9,340	€ 6,790
Owner's Suite	€ 9,790	€ 9,790
Safety and port taxes (included)	€ 650	
Flight and transfer (included)	€ 200	
Airport taxes (included)	€ 10	

TALCAHUANO - USHUAIA
on 22nd Oct 2020; 12 nights
USHUAIA - TALCAHUANO
on 05th March 2021; 12 nights
Adventure in Patagonia

PONANT BONUS
 Up to -30%

Superior Stateroom	€ 7,180	€ 5,430
Deluxe Stateroom	€ 7,700	€ 5,790
Prestige Stateroom - Deck 4	€ 8,530	€ 6,370
Prestige Stateroom - Deck 5	€ 8,920	€ 6,640
Prestige Stateroom - Deck 6	€ 9,330	€ 6,930
Deluxe Suite	€ 12,760	€ 9,330
Prestige Suite - Deck 5	€ 17,090	€ 12,360
Prestige Suite - Deck 6	€ 17,910	€ 12,940
Owner's Suite	€ 20,480	€ 20,480
Safety and port taxes (included)	€ 600	
Flights and transfers (included)	€ 720	
Airport taxes (included)	€ 30	

Le Champlain

PUERTO MORELOS - PUERTO MORELOS
on 03rd & 17th Nov. 2020,
01st & 15th Dec. 2020; 7 nights
Natural & Cultural Wonders of the Western Caribbean

PONANT BONUS
 Up to -30%

Deluxe Stateroom	€ 3,860	€ 2,800
Prestige Stateroom - Deck 4	€ 4,100	€ 2,970
Prestige Stateroom - Deck 5	€ 4,220	€ 3,050
Prestige Stateroom - Deck 6	€ 4,350	€ 3,150
Deluxe Suite	€ 5,870	€ 4,210
Prestige Suite - Deck 5	€ 6,330	€ 4,530
Prestige Suite - Deck 6	€ 6,520	€ 4,660
Privilege Suite	€ 6,710	€ 4,800
Grand Deluxe Suite	€ 6,910	€ 4,940
Owner's Suite	€ 7,120	€ 7,120
Safety and port taxes (included)	€ 350	

PUERTO MORELOS - PUERTO MORELOS
on 10th & 24th Nov. 2020,
08th Dec. 2020; 7 nights
Maya Treasure of the Yucatán

PONANT BONUS
 Up to -30%

Deluxe Stateroom	€ 3,860	€ 2,800
Prestige Stateroom - Deck 4	€ 4,100	€ 2,970
Prestige Stateroom - Deck 5	€ 4,220	€ 3,050
Prestige Stateroom - Deck 6	€ 4,350	€ 3,150
Deluxe Suite	€ 5,870	€ 4,210
Prestige Suite - Deck 5	€ 6,330	€ 4,530
Prestige Suite - Deck 6	€ 6,520	€ 4,660
Privilege Suite	€ 6,710	€ 4,800
Grand Deluxe Suite	€ 6,910	€ 4,940
Owner's Suite	€ 7,120	€ 7,120
Safety and port taxes (included)	€ 350	

PUERTO MORELOS - COLÓN
on 22nd Dec. 2020; 7 nights
Christmas between Mexico and Panama

PONANT BONUS
 Up to -30%

Deluxe Stateroom	€ 3,860	€ 2,800
Prestige Stateroom - Deck 4	€ 4,100	€ 2,970
Prestige Stateroom - Deck 5	€ 4,220	€ 3,050
Prestige Stateroom - Deck 6	€ 4,350	€ 3,150
Deluxe Suite	€ 5,870	€ 4,210
Prestige Suite - Deck 5	€ 6,330	€ 4,530
Prestige Suite - Deck 6	€ 6,520	€ 4,660
Privilege Suite	€ 6,710	€ 4,800
Grand Deluxe Suite	€ 6,910	€ 4,940
Owner's Suite	€ 7,120	€ 7,120
Safety and port taxes (included)	€ 350	

COLÓN - PUERTO CALDERA
on 29th Dec. 2020; 7 nights
Natural & Cultural History of Central America

PONANT BONUS
 Up to -30%

Deluxe Stateroom	€ 4,850	€ 3,500
Prestige Stateroom - Deck 4	€ 5,140	€ 3,700
Prestige Stateroom - Deck 5	€ 5,290	€ 3,800
Prestige Stateroom - Deck 6	€ 5,450	€ 3,920
Deluxe Suite	€ 7,360	€ 5,250
Prestige Suite - Deck 5	€ 7,940	€ 5,660
Prestige Suite - Deck 6	€ 8,180	€ 5,830
Privilege Suite	€ 8,420	€ 5,990
Grand Deluxe Suite	€ 8,680	€ 6,180
Owner's Suite	€ 8,940	€ 8,940
Safety and port taxes (included)	€ 350	

PUERTO CALDERA - COLÓN
on 05th Jan. 2021; 7 nights
Natural & Cultural History of Central America

PONANT BONUS
 Up to -30%

Deluxe Stateroom	€ 4,220	€ 3,050
Prestige Stateroom - Deck 4	€ 4,470	€ 3,230
Prestige Stateroom - Deck 5	€ 4,600	€ 3,320
Prestige Stateroom - Deck 6	€ 4,740	€ 3,420
Deluxe Suite	€ 6,400	€ 4,580
Prestige Suite - Deck 5	€ 6,900	€ 4,930
Prestige Suite - Deck 6	€ 7,110	€ 5,080
Privilege Suite	€ 7,320	€ 5,220
Grand Deluxe Suite	€ 7,540	€ 5,380
Owner's Suite	€ 7,770	€ 7,770
Safety and port taxes (included)	€ 350	

COLÓN - FORT-DE-FRANCE
on 12th Jan. 2021; 9 nights
Between Panama & Martinique

PONANT BONUS
 Up to -30%

Deluxe Stateroom	€ 4,420	€ 3,220
Prestige Stateroom - Deck 4	€ 4,680	€ 3,410
Prestige Stateroom - Deck 5	€ 4,830	€ 3,510
Prestige Stateroom - Deck 6	€ 4,970	€ 3,610
Deluxe Suite	€ 6,710	€ 4,830
Prestige Suite - Deck 5	€ 7,240	€ 5,200
Prestige Suite - Deck 6	€ 7,450	€ 5,350
Privilege Suite	€ 7,680	€ 5,510
Grand Deluxe Suite	€ 7,910	€ 5,670
Owner's Suite	€ 8,150	€ 8,150
Safety and port taxes (included)	€ 450	



Le Dumont-d'Urville

FORT-DE-FRANCE - FORT-DE-FRANCE on 21st Jan. 2021 & 28th February 2021; 8 nights Jewels of the Caribbean



Deluxe Stateroom	€ 4,100	€ 2,990
Prestige Stateroom - Deck 4	€ 4,350	€ 3,160
Prestige Stateroom - Deck 5	€ 4,480	€ 3,250
Prestige Stateroom - Deck 6	€ 4,610	€ 3,340
Deluxe Suite	€ 6,230	€ 4,480
Prestige Suite - Deck 5	€ 6,720	€ 4,820
Prestige Suite - Deck 6	€ 6,920	€ 4,960
Privilege Suite	€ 7,130	€ 5,110
Grand Deluxe Suite	€ 7,340	€ 5,250
Owner's Suite	€ 7,560	€ 7,560
Safety and port taxes (included)	€ 400	

FORT-DE-FRANCE - FORT-DE-FRANCE on 29th Jan. 2021, 20th Feb. 2021 & 08th March 2021; 8 nights Pearls of the Caribbean



Deluxe Stateroom	€ 4,100	€ 2,990
Prestige Stateroom - Deck 4	€ 4,350	€ 3,160
Prestige Stateroom - Deck 5	€ 4,480	€ 3,250
Prestige Stateroom - Deck 6	€ 4,610	€ 3,340
Deluxe Suite	€ 6,230	€ 4,480
Prestige Suite - Deck 5	€ 6,720	€ 4,820
Prestige Suite - Deck 6	€ 6,920	€ 4,960
Privilege Suite	€ 7,130	€ 5,110
Grand Deluxe Suite	€ 7,340	€ 5,250
Owner's Suite	€ 7,560	€ 7,560
Safety and port taxes (included)	€ 400	

CAYENNE - CAYENNE on 17th Nov. 2020 & 01st April 2021; 12 nights Discover the Amazon



Deluxe Stateroom	€ 8,200	€ 5,920
Prestige Stateroom - Deck 4	€ 8,690	€ 6,260
Prestige Stateroom - Deck 5	€ 8,950	€ 6,440
Prestige Stateroom - Deck 6	€ 9,220	€ 6,630
Deluxe Suite	€ 12,450	€ 8,890
Prestige Suite - Deck 5	€ 13,430	€ 9,580
Prestige Suite - Deck 6	€ 13,830	€ 9,860
Privilege Suite	€ 14,240	€ 10,140
Grand Deluxe Suite	€ 14,670	€ 10,440
Owner's Suite	€ 15,110	€ 15,110
Safety and port taxes (included)	€ 600	

CAYENNE - CAYENNE on 29th Nov. 2020 & 20th March 2021; 12 nights Discover the Amazon



Deluxe Stateroom	€ 7,130	€ 5,170
Prestige Stateroom - Deck 4	€ 7,560	€ 5,470
Prestige Stateroom - Deck 5	€ 7,780	€ 5,620
Prestige Stateroom - Deck 6	€ 8,020	€ 5,790
Deluxe Suite	€ 10,820	€ 7,750
Prestige Suite - Deck 5	€ 11,680	€ 8,350
Prestige Suite - Deck 6	€ 12,030	€ 8,600
Privilege Suite	€ 12,390	€ 8,850
Grand Deluxe Suite	€ 12,760	€ 9,110
Owner's Suite	€ 13,140	€ 13,140
Safety and port taxes (included)	€ 600	

CAYENNE - FORT-DE-FRANCE on 11th Dec. 2020; 12 nights The Caribbean & Amazon River



Deluxe Stateroom	€ 7,130	€ 5,170
Prestige Stateroom - Deck 4	€ 7,560	€ 5,470
Prestige Stateroom - Deck 5	€ 7,780	€ 5,620
Prestige Stateroom - Deck 6	€ 8,020	€ 5,790
Deluxe Suite	€ 10,820	€ 7,750
Prestige Suite - Deck 5	€ 11,680	€ 8,350
Prestige Suite - Deck 6	€ 12,030	€ 8,600
Privilege Suite	€ 12,390	€ 8,850
Grand Deluxe Suite	€ 12,760	€ 9,110
Owner's Suite	€ 13,140	€ 13,140
Safety and port taxes (included)	€ 600	

FORT-DE-FRANCE - COLÓN on 23rd Dec. 2020; 12 nights Christmas in the Caribbean



Deluxe Stateroom	€ 5 890	€ 4 300
Prestige Stateroom - Deck 4	€ 6 250	€ 4 550
Prestige Stateroom - Deck 5	€ 6 430	€ 4 680
Prestige Stateroom - Deck 6	€ 6 630	€ 4 820
Deluxe Suite	€ 8 950	€ 6 440
Prestige Suite - Deck 5	€ 9 650	€ 6 930
Prestige Suite - Deck 6	€ 9 940	€ 7 130
Privilege Suite	€ 10 240	€ 7 340
Grand Deluxe Suite	€ 10 550	€ 7 560
Owner's Suite	€ 10 860	€ 10 860
Safety and port taxes (included)	€ 600	

COLÓN - PUERTO CALDERA on 04th Jan. 2021; 7 nights Natural & Cultural History of Central America



Deluxe Stateroom	€ 4,850	€ 3,500
Prestige Stateroom - Deck 4	€ 5,140	€ 3,700
Prestige Stateroom - Deck 5	€ 5,290	€ 3,800
Prestige Stateroom - Deck 6	€ 5,450	€ 3,920
Deluxe Suite	€ 7,360	€ 5,250
Prestige Suite - Deck 5	€ 7,940	€ 5,660
Prestige Suite - Deck 6	€ 8,180	€ 5,830
Privilege Suite	€ 8,420	€ 5,990
Grand Deluxe Suite	€ 8,680	€ 6,180
Owner's Suite	€ 8,940	€ 8,940
Safety and port taxes (included)	€ 350	

COLÓN - FORT-DE-FRANCE on 01st March 2021; 9 nights Between Panama & Martinique



Deluxe Stateroom	€ 5,080	€ 3,690
Prestige Stateroom - Deck 4	€ 5,390	€ 3,900
Prestige Stateroom - Deck 5	€ 5,550	€ 4,020
Prestige Stateroom - Deck 6	€ 5,720	€ 4,130
Deluxe Suite	€ 7,720	€ 5,530
Prestige Suite - Deck 5	€ 8,320	€ 5,950
Prestige Suite - Deck 6	€ 8,570	€ 6,130
Privilege Suite	€ 8,830	€ 6,310
Grand Deluxe Suite	€ 9,100	€ 6,500
Owner's Suite	€ 9,370	€ 9,370
Safety and port taxes (included)	€ 450	

FORT-DE-FRANCE - CAYENNE on 10th March 2021; 10 nights The Caribbean & French Guiana



Deluxe Stateroom	€ 5,130	€ 3,740
Prestige Stateroom - Deck 4	€ 5,430	€ 3,950
Prestige Stateroom - Deck 5	€ 5,600	€ 4,070
Prestige Stateroom - Deck 6	€ 5,770	€ 4,180
Deluxe Suite	€ 7,780	€ 5,590
Prestige Suite - Deck 5	€ 8,400	€ 6,030
Prestige Suite - Deck 6	€ 8,650	€ 6,200
Privilege Suite	€ 8,910	€ 6,380
Grand Deluxe Suite	€ 9,170	€ 6,560
Owner's Suite	€ 9,450	€ 9,450
Safety and port taxes (included)	€ 500	

Formalities

FOR ALL CRUISES

The information below is current but subject to change at any time without advance notice from government authorities. For all other nationalities, please consult your respective government agencies for visa and health information.

Passport valid for at least six (6) months beyond the completion of your trip. Passport must contain at least two completely clear, blank, unused visa pages for each visa required, not including any amendment pages. Visa pages with stains or ink from other pages in the passport are not usable. Guests who deviate from the scheduled embarkation or disembarkation port should research the foreign entry requirements for the port country. Due to government regulations, regrettably, PONANT will have to deny boarding to any guest who fails to obtain the appropriate travel documentation for this trip.

SPECIFIC FORMALITIES

LE BORÉAL : COLÓN • MIAMI 9th APRIL 2021 ⁽¹⁾

LE BORÉAL : MIAMI • LISBONNE 20th APRIL 2021 ⁽¹⁾

LE SOLÉAL : SAN DIEGO • PUERTO QUETZAL 13th SEPTEMBER 2020 ⁽¹⁾

L'AUSSTRAL : SAN DIEGO • PUERTO QUETZAL 7th OCTOBER 2020 ⁽¹⁾

LE DUMONT-D'URVILLE : CAYENNE • CAYENNE 17th AND 29th NOVEMBER 2020 AND 20th MARCH AND 1st APRIL 2021 ⁽²⁾

LE DUMONT-D'URVILLE : CAYENNE • FORT-DE-FRANCE 11th DECEMBER 2020 ^{(2) (3)}

LE DUMONT-D'URVILLE : FORT-DE-FRANCE • CAYENNE 10th MARCH 2021 ^{(2) (3)}

- (1) **USA:** Depending on your nationality, an ESTA or Visa may be required. Please contact USA consulate website for details. In case the ESTA is sufficient to enter the USA, kindly print out a copy of your ESTA and keep it with your passport. Please, send a copy to PONANT at least 45 days before departure.
- (2) **French Guiana, Suriname and Brazil:** The yellow fever vaccination is mandatory, bring along the original certificate. Anti-malarial treatment is highly recommended (check with your doctor).
- (3) **Surinam:** A transit visa will be issued and charged onboard (15€ subject to change).

IMPORTANT INFORMATION

Visas: Before departure, please check carefully that your visas are valid for the right date and time spent in the countries in order to avoid unpleasant situations.

Warning about the use of drones: The use of drones aboard PONANT ships, whether they are sailing at sea, at a port of call or anchored, is strictly forbidden. The use of drones on land in the Arctic and Antarctic regions is also strictly forbidden by international polar regulations. In other regions, it may be possible to use drones on land if permission has been obtained from the relevant authorities of each country and each region travelled through, as well as a pilot's licence that should be obtained from your home country. Passengers are responsible for obtaining these permits; they should be able to present them at all times. Passengers who do not obtain these authorizations expose themselves to the risk of legal proceeding.

Medication: If you have a medical treatment, do not forget your prescription.

Machu Picchu programme: A medical certificate is compulsory. The city of Cuzco's altitude is around 3,350 metres.

Ecuador programme: A medical certificate is recommended for people with breathing or heart problems. In Ecuador, the city of Quito is at an altitude of around 2,850 metres.

Galapagos programme: The average temperature in the Galapagos Islands at the time of our visit is around 30° C with scattered showers. Because you may have to wet your feet to go ashore, suitable shoes must be worn. Snorkelling equipment is available for hire on site, however if you have a prescription mask, please do bring your own. Remember to bring your binoculars and a camera (preferably waterproof) to immortalize your swims. During this program you will be required on volcanic soil, which can sometimes be slippery. This program is not suitable for the mobility impaired. We strongly advise seeking your doctor's opinion before joining this programme.

Panama Canal programme: The schedules depend on several factors and despite our best efforts, crossing the Panama Canal during the day is not guaranteed.

POLAR EXPEDITION CRUISES



Complimentary polar parka: For all cruises marked with the logo «parka gift», a PONANT polar water-resistant parka is offered (adult sizes only - in case of consecutive cruises, only one parka per person). When packing your suitcases, we recommend you to follow clothing instructions and advice provided with your travel documents. Do not hesitate to contact us if in doubt.

Complimentary boots hire: Save space and lighten your luggage by reserving your boots up to 7 days prior departure, on our dedicated website boots.ponant.com. Upon embarkation then, your boots will be delivered to your stateroom. For more information, please contact us.

By choosing an expedition cruise, passengers agree to follow the rules of good conduct presented by the expedition team during the cruise.

DIVING CRUISES



Dives when authorised by local authorities and feasible with ship equipment and Zodiac® dinghies. Rates: €70 per standard dive; €80 per dive when local equipment or staff must be used, €80 for a “discover scuba dive” course. In order to participate in diving sessions, guests must have with them a medical certificate less than 1-year-old and their up to date dive book.

General Terms and Conditions of Sale

Important notice

These General Terms and Conditions of Sale (GTCS) form an integral part of the Contract entered into by CDP and the Traveller. The Particular Terms and Conditions of Sale (PTCS) – which are specific to each Cruise season, summer or winter – may create an exception to these General Terms and Conditions of Sale. In any event, the specifications of the Cruise Ticket and of the Passenger Ticket shall prevail over the General and Particular Terms and Conditions of Sale. All these contractual documents make up the Contract entered into by CDP and the Traveller. In the event that a provision in these General Terms and Conditions of Sale and/or in the Contract breaches a mandatory legal provision, and/or is considered as invalid, this invalidity shall not affect the validity of the other clauses.

In compliance with the General Data Protection Regulation (EU) 2016/679 of the European Parliament and of the Council on the protection of the processing of personal data, Travellers have the right of access by the data subject, right to rectification, right to erasure, right to data portability, right to object, right to restriction of processing, or right to refused automated individual decision-making, including profiling, any personal information that concerns them, and that Compagnie du Ponant, the controller, may be required to gather for the purposes of its business activities and the implementation of the travels it provides. To know or exercise the rights on their personal data, Travellers could contact the Data Protection Officer at vieprivée@ponant.com or consult Compagnie du Ponant's personal data protection policy online available at www.ponant.com.

1. Definitions:

- 1.1 "Tickets": refers interchangeably to Transportation, Cruise, and/or Airline Tickets.
- 1.2 "Airline Ticket": A document that contains the specifications of the air transportation contract via which the Airline undertakes to carry the Traveller between the airports mentioned therein.
- 1.3 "Cruise Ticket": a document that contains the specifications of the cruise contract via which the Organiser of the Cruise undertakes to have the Traveller carried by the Sea Carrier, and to provide them with the amenities and services that are mentioned on the Cruise Ticket. The Cruise Ticket delivered to the Traveller is governed by the general terms and conditions of the Cruise Ticket.
- 1.4 "Passenger Ticket": a document that contains the specifications of the passenger transportation agreement via which the Sea Carrier undertakes to carry the Traveller between the ports mentioned therein. The Passenger Ticket delivered to the Traveller is governed by the general terms and conditions of the Passenger Ticket.
- 1.5 "CDP": Compagnie du Ponant, a simplified joint stock company, which has its registered office at 408, avenue du Prado 13008 Marseille, with share capital of €3,644,607. The company is registered on the Marseille Trade and Companies Register under No. 344 497 011, holds Government Licence No. 013.06.0005, is a member of SNAV (French National Travel Agents' Association) and is registered with ATOUT France under No. IMO13120040. The company's financial cover is provided by APST, 15 avenue Carnot, 75017 Paris. Compagnie du Ponant has subscribed to an insurance policy covering its Professional Civil Liability under No. AA714708 with Generali Assurance IARD – 7 boulevard Haussmann – 75456 Paris Cedex 09.
- 1.6 "Signing of the Contract": refers to the point when the contract is entered into between the Traveller(s) and CDP, i.e. when the latter confirms their booking to the Traveller.
- 1.7 "General Terms and Conditions of Sale" or "GTCS": the clauses in this document.
- 1.8 "Particular Terms and Conditions of Sale" or "PTCS": the contractual clauses applicable to the Contract, which are specific to each Cruise season – summer or winter.
- 1.9 "Contract": all the respective obligations incumbent upon CDP and the Traveller, as specified on the invoice and the Tickets, as well as in the GTCS and PTCS.
- 1.10 "Cruise": a round-trip by sea as described in the CDP Sales Brochure and/or on the CDP website, and on the Cruise Ticket.
- 1.11 "Expedition Cruise": cruise during which exploration excursions are planned in inflatable boats, accompanied by nature guides.
- 1.12 "Pre-Booked excursion and/or extension": Services including Transfers, sight-seeing trips and ground services before, during and/or after the Cruise.
- 1.13 "Fixed-Rate Package": refers to the combination of a Cruise with a flight and/or a Transfer and/or Pre- and Post-Cruise Services, and/or Pre-Booked Excursions and/or Extensions, and/or any other tourism service booked when Signing the Contract. The Fixed-Rate Package does not include land excursions that have not been booked at the same time as the Cruise, and the services offered on board the ship.
- 1.14 "Organiser of the Cruise": a private individual or a company that undertakes to have the Travellers carried by the Sea Carrier, and to provide them with the amenities and services that are mentioned on the Cruise Ticket, and whose letterhead appears on the Cruise Ticket.
- 1.15 "Disabled Person" or "Person with Reduced Mobility": any person affected by a restriction on their movements or a restriction preventing them from enjoying the Services agreed due to a significant alteration of one or several of their physical, sensory, mental, cognitive, or psychological functions, to multiple handicaps, or to a debilitating health problem.
- 1.16 "Service": refers to any Cruise, Fixed-Rate Package, flight, Transfer, Pre- and Post-Cruise Service, Pre-Booked Excursion and/or Extension, and any other tourism service booked when Signing the Contract.
- 1.17 "Price": total cost of the Services booked by the Traveller.
- 1.18 "Pre- and Post-Cruise Services": Services including Transfers, sight-seeing trips and ground services before and/or after the Cruise, as mentioned in the Contract.
- 1.19 "Transfer": an operation that consists in carrying Travellers between the port of embarkation and/or disembarkation and a meeting point determined by CDP (airport, hotel, or railway station, etc.).
- 1.20 "Sea Carrier": a private individual or company that operates the ship that carries the Travellers, and whose letterhead is shown on the Passenger Ticket.
- 1.21 "Air Carrier": a company that undertakes to carry the Travellers by air, and whose letterhead is shown on the Airline Ticket.
- 1.22 "Vendor": a private individual or legal entity that has sold the Services included in the Contract directly to the Travellers.
- 1.23 "Travellers": any person named at the time of the booking and/or Signing of the Contract, and whose name is shown on an invoice and/or on the Tickets issued by CDP or by the Vendor.

2. Acceptance and application of the General Terms and Conditions

2.1 The Signing of the Contract implies acceptance of all these GTCS and PTCS by the Traveller, with no reservations, together with the clauses and conditions in the Passenger Ticket and the Cruise Ticket.

3. Applicable legislation

- 3.1 Where CDP acts in the capacity of a Sea Carrier, the contractual relations between CDP and the Traveller shall be governed by the Passenger Ticket and by the provisions of the French Transport Code, and specifically Articles L. 5420-1 to L. 5421-12, by the Application Decree of 31 December 1966, and by the provisions of the London International Convention of 19 November 1976, as well as by the provisions of Regulation 392/2009 issued by the European Parliament and Council on 23 April 2009, where applicable, which form an integral part of the Passenger Ticket.
- 3.2 Where CDP is the Organiser of the Cruise, the contractual relations between CDP and the Traveller shall be governed by the Contract, which includes the Cruise Ticket, as well as by Articles 47 to 49 of Law No. 66-420 of 18 June 1966 regarding chartering and sea carriage contracts, and its application decree of 31 December 1966.
- 3.3 Where CDP is the Vendor of a tourism package within the meaning of Article L. 211-2 of the French Tourism Code, the contractual relations between CDP and the Traveller shall be governed by the Contract, and by Articles L. 211-1 et seq. and R. 211-1 et seq. of the French Tourism Code.

4. Payment of the Price

- 4.1 The Signing of the Contract implies payment of 25% of the Price of this Service as an advance, while the balance must be paid within 60 business days at most prior to the beginning of the first Service featured in the Contract.
- 4.2 As an exemption to Article 4.1, the balance must be paid within 90 days at most before the beginning of the first Service featured in the Contract in the case of Expedition Cruises.

4.3 Once the Service has been paid for in full, the Traveller shall receive the Ticket(s) and the exchange vouchers, where applicable, together with the insurance policy, if that policy has been subscribed directly with CDP.

5. Rates and reductions per person and per cruise

- 5.1: Public rates are the reference rates of the cruise applicable for the validity period of the brochure. Public rates are per person and based on double occupancy.
- 5.2 **Ponant Bonus Fares** is a special savings program offered on published cruise only rates for selected voyages. Ponant Bonus is the guaranteed best price you can obtain on the day you make your reservation. It can save you up to 30% off the public rates (rate port to port only, exclusive of port taxes, security and airline fare and possible ground services). Ponant Bonus fares are capacity controlled, subject to availability and may change at any time without notice.
- 5.3 **Single Supplement**. The single supplement shall apply to any person who occupies a cabin on their own. The Supplement shall apply to the port-to-port section (excluding port taxes) of the Ponant Bonus rate in effect. This supplement may change depending on the occupancy rate of the cruises concerned. It may therefore change for certain categories of cabins and/or suites only, or for an entire cruise at any time with no notice. The single supplement shall be offered in certain cabin categories for a selection of cruises. This selection shall be updated in accordance with the occupancy rate, and can be viewed on our website at www.ponant.com.
- 5.4 Depending on the occupancy of the ship (with the exception of the Le Ponant yacht) at the time of reservation, a "guaranteed" Deluxe Stateroom Deck 3 may be offered. This means that the booking has been made in the Deluxe Stateroom Deck 3 category without a cabin number being assigned, and that the cabin shall be assigned at the Company's discretion, and may change at any time until embarkation. Once the cabin number has been assigned, no request for a change may be accepted. This formula offers the advantage of potentially benefiting from a cabin in a higher category without a price surcharge. The minimum category selected at the time of booking shall be guaranteed in any event.
- 5.5 **Other Savings**
These offers are not combinable with any other discounts or special offers. If you could obtain more discounts, the amount of the second discount is calculated from the price obtained after deducting the 1st and so on.
 - 5.5.1 **Combination of cruises** (Discount only applies to port/port cruise fare does not include port charges and subject to availability at time of booking). Both offers below are not cumulative.
 - On all our cruises: 10% off on any combined cruise
 - On a particular selection of cruises accessible on our website: 20% off the 2nd cruise, 30% off the 3rd cruise, 40% off the 4th cruise.
 - 5.5.2 **Ponant Yacht Club Members**
Commodores: -12.5% off the cruise-only rate, port taxes excluded.
Grand Admirals: -10% off the cruise-only rate, port taxes excluded.
Admirals: -7.5% off the cruise only rate, port taxes excluded.
Majors: -5% off the cruise only rate, port taxes excluded.
 - 5.5.3 **Honeymoon Offer**
For any cruise taken within the 12 months after the wedding or civil union, you can enjoy the following advantages:
 - 5% off the cruise-only rate, port taxes excluded
 - Bottle of champagne on arrival
 - A photography session and your 5 favourite photos for free (except on board Le Ponant)
 - 2 spa treatments (maximum value: €120 per treatment), (except on board Le Ponant)
 - Surprise aboard.Offer valid on presentation of proof. Offer not cumulative with another discount.
 - 5.5.4 **Wedding Anniversary**
If you are celebrating any multiple of five years of marriage or civil union (1), enjoy a €200 / AUD 300 / US\$ 260 / £ 175 reduction per stateroom /suite for a cruise taken during the calendar year of your anniversary. (1) Offer valid on presentation of proof. Reduction applies only once per year of anniversary.
 - 5.5.5 **Family & Friends**
 - Any group booking that includes at least 5 paying persons will receive an unconditional 5% reduction on that cruise port/port (port taxes not included).
 - Preferential rate for 3 to 17 year-olds sharing a stateroom or Suite with 1 or 2 adults. Please contact us.
 - 5.5.6 **Referral Program**
Introduce PONANT to your relatives and friends and take advantage of the Sponsorship offer. As a sponsor, you receive a 500 € reduction per stateroom on your next cruise, after your referee's booking: they in turn enjoy a reduction of 500 € on their first cruise. In case of cancellation from his/her booking, your savings becomes null and void. You will be able to claim this offer again for his/her next booking. Savings for the referrer and the person(s) referred cannot be taken as a payment or cash refund. The referred person's savings apply immediately and is limited to one use per stateroom and per referred customer. The referee's saving is valid for their next cruise, after the person they refer booked. The referrer's savings must be applied to one cruise. The referrer should give his/her PONANT Yacht Club number to the person(s) they wish to refer for identification purposes. The person being referred cannot have previously sailed on a PONANT ship. The referrer must have already sailed on a PONANT ship. The referrer and person referred cannot be a current or a former employee of PONANT or a travel agency. A referrer can refer any number of people, but only one per household. The referrer and the person he/she refers may not share the same stateroom. The sponsoring request will be rejected if the person referred or any member of his/her household has already been referred. The other advantages of PONANT, such as Ponant Bonus, are combinable with the "Referral Program".
 - 5.5.7 **Booking on board**
-5% off the cruise only (excluding port charges and security) for each new cruise booked with our onboard staff.
Except the Privilege Single Offer and the PONANT Bonus, the offers described above are not combinable.

6. Passports, Visas and Vaccination Certificates

- 6.1 Every Traveller who is a French national shall be responsible for performing the administrative and/or health formalities required by the countries concerned by the Services, including those formalities disclosed by CDP and viewable on the www.ponant.com website as well as in the brochure, prior to Signing the Contract.
- 6.2 Travellers who are foreign nationals must contact the relevant embassies and/or consulates and perform the administrative and/or health formalities required by the countries concerned by the Services prior to Signing the Contract.
- 6.3 CDP shall not be held responsible for the consequences of a Traveller failing to comply with police, customs, or health formalities prior to or during the length of the Services under any circumstances. A Traveller who is unable to board a flight or a ship because they cannot present the documents required may not claim any refund or compensation.
- 6.4 In any event, Travellers are advised to check all the information with the authorities concerned prior to the departure date. CDP advises Travellers to consult the country factsheets relating to the chosen destinations prepared by the French Ministry of Foreign Affairs on the <http://www.diplomatie.gouv.fr/fr/consils-aux-voyageurs> website, or to make enquiries by telephone (+33 1 43 17 53 53, French Ministry of Foreign Affairs). CDP specifically draws Travellers' attention to the fact that the information provided may change up until the departure date, and they are advised to consult that information up until the time of departure.
CDP invites Travellers to adjust their behavior to the visited country, to exercise vigilance and to avoid carrying valuable objects during their travel.

7. Embarkation and sea carriage conditions

- 7.1 The Traveller must present themselves for embarkation under the conditions determined by the Passenger Ticket, and at least two hours before the ship's scheduled departure time. The Passenger Ticket and/or the Cruise Ticket issued by CDP shall only be valid for the Cruise and the ship mentioned on the ticket.

7.2 The purpose of the Passenger Ticket is to transport the Travellers and their luggage from the time when they embark at the port of departure to the time when they disembark at their destination.

7.3 All Travellers must hold a valid passport, or an identity card, where applicable, that are valid for six months following the date of their return, together with the visas and vaccination certificates likely to be required in the ports where the ship calls and the port of destination. Every Traveller shall be personally responsible for complying with the legal and regulatory provisions required prior to departure. The Carrier, the Organiser of the Cruise, and/or CDP, and/or the Captain may refuse to allow a Traveller who does not show the documents enabling them to disembark at the port of destination port and at the scheduled ports of call to embark or disembark.

7.4 If a Traveller who has reserved a Cruise solely on a port-to-port basis organises their own air or ground transport to the port of embarkation and/or to their home address, they are strongly advised to purchase changeable and refundable transportation tickets, and to allow for reasonable transfer times between the station, the airport, and the port. In the event of a delay, cancellation or change, CDP shall not be responsible for the transport and Transfer expenses and/or for any other kind of amenities and services not included in the Cruise Ticket that were not directly purchased from CDP. CDP shall not be responsible for any incidents or accidental damage to equipment and/or bodily injury that may occur during travel to and/or from the ship.

7.4.1 Ocean Voyages: To secure the boarding on departure day, we strongly recommend that you spend the night before in the city that your ship leaves from. Similarly, on the day you disembark we advise you just as strongly to reserve a flight that leaves at the end of the day or the day after your arrival. Indeed, these "Ocean Voyages" long trips are more than any other type of travel subject to climatic hazards, including winds and currents, which may require anticipating the departure of the ship, and / or delay the arrival of the ship.

7.5 Every Traveller shall guarantee that they are fit to travel by sea, and that their state of health or behaviour shall not harm the other Travellers or the proper performance of the Services agreed and/or proposed. If a Traveller's state of health is likely to limit their ability to enjoy the Services agreed, or to disrupt the proper provision of those Services, they must inform CDP, and must provide a medical certificate certifying their fitness on request. Any health problem, if known, must be mentioned to CDP's Medical Department in writing when Signing the Contract or before the departure of the ship (or prior to the beginning of the Services) at the latest.

7.6 Travellers shall be responsible for Doctor's appointments, medical care, and medication on land or on board the ships. All Travellers must ensure that they are covered by an appropriate medical insurance policy.

7.7 In the event of the threat of an epidemic, the Carrier, the Organiser of the Cruise, CDP, the Captain of the ship, or any other local health authority may demand that the Traveller fill in a health questionnaire and take a screening test, where applicable, before or at the time of embarkation or disembarkation, including during port calls.

7.8 In the specific case of Expedition Cruises, where you are reminded that any medical facilities are several days away by sea, a mandatory full medical questionnaire (a document provided on Signing the Contract) must be filled in by the Traveller's referring attendant physician between 90 and 45 days prior to the beginning of the Services, and must be returned to CDP's Medical Department (medical@ponant.com) by mail or e-mail within 40 days prior to the beginning of the Services at the latest. Any medical certificate issued prior to the determined period shall not be valid. Any Traveller who has not returned their duly completed mandatory medical certificate shall not be allowed to embark, and shall not benefit from any refund.

7.9 Travellers must comply with the rules on board throughout the journey. Travellers are required to attend any safety demonstrations and explanations that are organised on board, and to follow the crew's instructions at all times.

7.10 If they consider it necessary, the Carrier, the Organiser of the Cruise, CDP and/or the Captain of the ship may terminate the contract and refuse to carry any Traveller who does not comply with the conditions for entering into the destination ports, or whose presence on board could be harmful to the comfort, health, and safety of the other Travellers and the crew, breach the laws and rules of the ports where the ship calls, or render the Carrier, the Organiser of the Cruise, and/or CDP liable for the Traveller's legal defence or repatriation. Accordingly, the Organiser of the Cruise, the Carrier, and/or CDP, and/or the Captain of the ship may decide to take the following appropriate measures: Refuse to allow the Traveller(s) to embark or disembark in any port that the ship calls at; 2) Disembark the Traveller(s) at any port that the ship calls at; 3) Transfer the Traveller(s) to another ship; 4) Confine the Traveller(s) on board, in their cabin, or in a cabin managed by the on-board medical team; 5) Have the doctor and their team administer any drugs, medications, or other permissible substances, and/or confine the Traveller in hospital or in any other similar facility at the port of destination if the on-board doctor considers it necessary.

• Disabled Persons and Persons with Reduced Mobility

7.11 Due to safety requirements, every Traveller must be independent, or travel with a person who is capable of providing them with all the assistance required during the performance of the Services.

7.12 Travellers whose mobility is restricted due to a physical disability or to a condition that requires special treatment and/or special assistance, including people who use wheelchairs, must inform CDP in writing at the time when they make the booking request, or as soon as the Traveller becomes aware of their disability if that disability occurs following the booking, but in any event at least 30 days prior to the beginning of the Services, in order to enable CDP to confirm to the Traveller that they will be physically able to enjoy the Cruise on board the ship and/or the Services agreed, inter alia.

7.13 The Organiser of the Cruise, the Carrier, and/or CDP, and/or the Captain reserve the right to refuse access to Travellers who have failed to inform CDP or the Vendor about a disability or their need for assistance, if such disability and need are not compatible with the applicable safety rules and the specific regulations for the navigation area, or require care that CDP and/or the Carrier would not be in a position to provide, or if the design of the passenger ship, and the port infrastructure and facilities, including port terminals, make the embarkation, disembarkation, or transportation of the person concerned under satisfactory safety conditions impossible.

7.14 Going ashore may be difficult or even impossible for Travellers with Restricted Mobility, or Disabled Travellers, especially in the event of disembarkation in launches or/and excursions in inflatable boats.

7.15 Once they have received CDP's written agreement, Travellers who use a wheelchair must embark with their own wheelchair, and must absolutely be accompanied by a person who is capable of assisting them at all times. Every disembarkation shall nonetheless be subject to the approval of the Captain.

7.16 Le Boréal, L'Austral, Le Soléal and Le Lyrial and Le Commandant-Charcot all have three cabins that are specially equipped to receive Disabled Persons, or Persons with Restricted Mobility (two cabins on board the PONANT EXPLORERS ships). Please note that the Le Ponant yacht specifically does not allow access to Persons with Restricted Mobility or Disabled Persons due to a different design.

• Children and Pregnancy

7.17 Children under 3 years of age shall not be authorised to embark on the ships. Children under 6 years of age shall not be authorised to embark on the ships for Polar Expedition cruises.

7.18 In the case of all the Expedition Cruises, children must be fully independent during all the outside activities organised and during disembarkation in rubber boats, be sufficiently tall to sit on the inflatable sides of the boats, and old enough to understand, and immediately respond to the orders given by the persons in charge. As a result, children's participation in any activity in an inflatable boat shall be subject to the agreement of the Captain and of the Expedition Head, depending on the sea conditions, and the difficulty of disembarking at each location visited. The ships do not carry Parka's in children's sizes. Parents must arrange to bring a suitable Parka for children.

7.19 Minor children shall remain under their parents or guardians' full and entire responsibility when on board and/or during excursions.

7.20 PONANT reserves the right to limit the number of children less than 8 years of age aboard its ships.

7.21 As the ships do not have any facilities to enable women to give birth on board, women who are over six months pregnant shall not be allowed to embark on the ships. In any event, pregnant women travelling on board the ship are advised to consult a doctor prior to embarkation, in order to ensure that their state of health is compatible with the planned cruise.

• Authorised luggage

7.21 Every Traveller must label each luggage item correctly, and indicate their full name, the name of the ship, their destination, and their cabin number in a highly legible manner. The markings must be visible and permanent.

7.22 Goods, property, and items where the contents may threaten the health and safety of the other

Travellers and their Luggage, of persons or of property, and may damage or pollute the ship, inflammable, explosive, corrosive, hazardous, or odorous materials, or materials that are likely to leak, items where importation is prohibited or that do not comply with customs or police regulations, and generally speaking property and items other than those intended for the Traveller's personal use are prohibited on board and in their luggage (hereinafter the "Prohibited Items"). In any event, the Traveller shall be liable for any injury, loss, or damage suffered as a result of the presence of Prohibited Items in their luggage or in their cabin, and shall hold the Organiser of the Cruise, the Carrier, and/or CDP harmless against any proceedings that may be initiated against them as a result of the presence of these Prohibited Items on board or at the time of embarkation or disembarkation. These Prohibited Items may be disembarked, destroyed, thrown into the sea, or rendered harmless at any time and any place by the Organiser of the Cruise, the Carrier, the crew, and/or CDP, without compensation, and notwithstanding payment of any destruction costs by the Traveller.

7.23 Travellers must keep an eye on their luggage and personal effects throughout the length of the Services, including their stay on board and during embarkation, transfer, and disembarkation operations. The Organiser of the Cruise, the Carrier, and/or CDP shall decline any liability for luggage that is left unsupervised by the Traveller, and where the latter has not taken all necessary precautions to avoid theft, loss, or damage. The Organiser of the Cruise, the Carrier and/or CDP shall not be liable for fragile items, jewellery, watches, money, cash, computers and other electronic appliances, mobile 'phones, or any other valuable items that the Traveller has not declared as valuables, and entrusted for custody on board with a descriptive inventory and an estimate, and for which they have not paid the corresponding proportional custody fees.

7.24 Travellers shall be liable under civil and criminal law for any direct or indirect damage that they cause to the Organiser of the Cruise, the Carrier, and/or CDP, and to the other Travellers or third parties. They shall be solely liable for any fine or penalty inflicted by the relevant authorities on their account.

7.25 Travellers shall agree to allow the Organiser of the Cruise, the Carrier, the officers of the crew and/or CDP, together with the customs, health and/or administrative authorities in port of call countries or the State where the ship is registered free access to their cabin, luggage, and personal effects on request and without delay.

7.26 The Organiser of the Cruise, the Carrier, and/or CDP shall not be liable for the damage caused to photographic, telephone, and electronic equipment and cameras that are lost or damaged during the performance of the Services, whether on board the ship or in ancillary facilities, or during embarkation and disembarkation operations, or for any damage caused to items that have fallen into the water.

• Pets

7.27 Pets, including service or medical assistance animals are prohibited on board the ships, and are not admitted for embarkation.

• Smoking policies

7.28 The ships are non-smoking except for the specifically designated areas on the outside decks (the policy also applies to electronic cigarettes).

8. Air carriage

8.1 The full Airline Tickets shall be presented in the form of electronic tickets. The surnames and given names must strictly be those indicated on the Traveller's valid passport. Any error or request for alteration shall result in the purchase of a new Airline Ticket.

8.2 In accordance with French Decree No. 2007-669 of 2 May 2007 regarding the obligation to inform Travellers of the identity of the Airline Carrier, CDP shall inform Travellers of the identity of the known Airline Carrier(s) likely to provide air transportation as at the date when they register. In the event of a change subsequent to the signing of the Contract, CDP undertakes to disclose any changes in the identity of the Airline Carrier(s) prior to departure as soon as it becomes aware of them.

8.3 Airline companies may enter into so-called mutual code-sharing agreements, which consist in marketing a flight under their own name even though it may be operated by an aircraft belonging to another airline.

8.4 The term "direct flight" means that there shall be no change of aircraft, but does not exclude the possibility of one or several stop-overs. The term "non-stop direct flight" means a flight with no change of aircraft and no stop-overs.

8.5 The timetables and types of transport mentioned by CDP shall be those disclosed by the Airline Carriers. They shall therefore be indicative up until the time of departure, and subject to alterations for all kinds of reasons (additional stop-overs, weather conditions, air traffic control authorisations, and strikes, etc.). In accordance with the Warsaw and Montréal Conventions, the timetables and itineraries, and the departure and destination airports shall never be a contractual feature of the Transportation Ticket; under these conditions, CDP cannot be held liable for any changes beyond its control.

8.6 CDP cannot be held responsible for any technical, climate-related or political incident, delay, cancellation or strike, additional stop-over, or change of aircraft or routing, etc. that may arise during the air transportation, and no compensation may result on any grounds whatsoever. If a Traveller wishes to waive their right to benefit from a Service, they shall be liable for the cancellation fees set out below.

8.7 The Airline Carrier's responsibility shall be limited in the event of damage, complaints, or claims of any kind, in accordance with the conditions set out on the Airline Tickets. CDP shall not refund any expenses (taxi, meals and hotels, etc.) if the Traveller is under the responsibility of the Airline Carrier. The consequences of any accidents and/or incidents that may arise during the performance of the air transportation shall be governed by the Warsaw and Montréal Conventions, and by the local regulations governing domestic transport systems in the country concerned.

8.8 Depending on the Airline Carrier, the usual baggage allowance on regular international flights (excluding the benefits granted to members of loyalty programmes) is strictly limited to a maximum of 23 kg in the hold and 8 kg in the cabin per Traveller. On regular domestic flights, the allowance usually ranges between a maximum of 15 and 20 kg in the hold. On charter flights operated by CDP, the maximum hold luggage allowance is 23 kg (subject to confirmation by the selected Airline Carrier) and 5 kg for each item of luggage in the cabin. Travellers are advised to pay close attention to this restriction. Airline Carriers do not hesitate to charge additional fees for excess baggage, and sometimes refuse to check luggage that is too heavy or too bulky due to strict security rules. The liability of CDP and of the Airline Carrier cannot be engaged in the event of refusal to check in a Traveller due to the fact that their luggage exceeds the allowance.

9. Transfer of the Contract

9.1 A Traveller may transfer their Contract to a third party who fulfils the same conditions as them for the performance of all the Services, as long as those Services have not begun, in accordance with Article R. 211-7 of the French Tourism Code, and only where this Code applies to CDP.

9.2 The transfer and/or the transferee shall be required to pay the resulting fees. They must inform CDP of this decision by any means that enables them to obtain an acknowledgement of receipt (registered letter with acknowledgement of receipt, e-mail, or fax, etc.) within 60 business days at the latest prior to the beginning of the Services.

9.3 In the event that a Traveller transfers their Contract without informing CDP in accordance with the procedures provided for above, this transfer shall not be valid, and the Services provided for in the Contract shall be cancelled with no possible refund.

10. Cancellation or alteration of the Contract by the Traveller

10.1 Pursuant to Article L. 121-21 of the French Consumer Code, Travellers are informed of the fact that they do not benefit from the right of withdrawal provided for in Article L. 121-17 of said Code.

10.2 Travellers cannot alter the Services provided for in the Contract without CDP's prior agreement.

10.3 If a Traveller alters or cancels a portion or all of the Services provided for in the Contract, shall need to inform CDP via any means that enables them to obtain an acknowledgement of receipt (fax, email, or registered letter with acknowledgement of receipt) as soon as the event resulting in this alteration or cancellation occurs. The date on which the document was sent shall be the date on which the alteration and/or cancellation fees are invoiced.

Requests to alter a cruise shall only be accepted subject to Compagnie du Ponant being informed within a timeframe of at least 90 days before the departure of the cruise, via the means set out above. This timeframe shall be increased to 150 days for Expedition Cruise programmes.

Beyond that deadline, alteration requests shall be considered as cancellation requests, and shall therefore be managed according to Paragraph 10.5, which governs cancellation fees.

The alteration terms and conditions exclusively involve the option for the traveller to replace a port-to-port cruise with another port-to-port cruise with Compagnie du Ponant.

10.4 Alteration fees:

In the event of an alteration involving a higher-value travel package, and subject to compliance with the terms and conditions set out in Points 10.4.a to 10.4.d, no alteration fee shall be applied to the cruise service, or to the other services, (e.g. air travel). The rebooking fees shall amount to the expenses already incurred by Compagnie du Ponant:

- 10.4. a: The passenger may alter their cruise subject to replacing it with a more expensive cruise than the one that is being replaced;
- 10.4. b: The departure date of the cruise booked as a replacement must fall within a maximum timeframe of 12 months as from the date when the alteration request was made;
- 10.4. c: The reservation and payment of the deposit for the replacement cruise must be made at the same time as the alteration request;
- 10.4. d: The replacement cruise selected shall become non-exchangeable and non-refundable from that point; the passenger may only cancel it.

In the event that the Contract is switched to a Service of a lower value than the initial value, alteration fees shall apply, and shall be equal to those in the cancellation terms and conditions set out in Article 10.5 below. The fee percentage shall then apply to the difference between the price of the initial Service and/or of the new Service.

Specific terms and conditions for an alteration request from Ponant Yacht Club High Admirals

In the event of the 1st alteration of a tourism package: no fees shall be applied to the cruise service, as long as the request is made within a timeframe of at least 90 days before the departure of the cruise. This timeframe shall be extended to 150 days for Expedition Cruise programmes. New departure within 12 months after the date of departure initially scheduled. Only one alteration without penalty charges per calendar year and per person entitled to Grand Admiral status, regardless of the cruise.

Any alteration request aside from the alteration of the 1st cruise shall be subject to the general sales condition applicable by default.

In the case of other services (e.g. air travel), the alteration fees shall amount to the expenses already incurred by Compagnie du Ponant:

10.5 Cancellation fees:

For the Expedition Cruises:

- From the registration confirmation date up to 365 days prior to the departure of the Cruise: €250 per passenger on the cruise only rate;
- Between 364 days and 91 days prior to the departure of the Cruise: 25% of the total amount of the Services;
- Between 90 days and 76 days before the departure of the Cruise: 25% of the total amount of the Services;
- Between 75 days and 61 days prior to the departure of the Cruise: 75 % of the total amount of the Services;
- Less than 61 days prior to the departure of the Cruise: 100 % of the total amount of the Services.

For other cruise programmes:

- From the registration confirmation date up to 365 days prior to the departure of the Cruise: €250 per passenger on the cruise only rate;
- Between 364 days and 91 days prior to the departure of the Cruise: 10% of the total amount of the Services;
- Between 90 days and 61 days before the departure of the Cruise: 25% of the total amount of the Services;
- Between 60 days and 46 days prior to the departure of the Cruise: 50 % of the total amount of the Services;
- Between 45 days and 31 days prior to the departure of the Cruise: 75% of the total amount of the Services;
- Less than 30 days prior to the departure of the Cruise: 100 % of the total amount of the Services.

For the other Services:

No refund shall be granted for any cancellation or waiver of an airline or ground Service included in the contract, or of any service that forms part of the Cruise, for any reason whatsoever.

10.6 In the event that a Traveller is prevented from taking the Cruise by a force majeure event, or due to their death, the Contract shall be terminated via the notice provided by the Traveller or their beneficiaries prior to the execution of the Contract. One quarter of the price of the Contract shall then be payable to CDP. The same conditions shall apply to the family members of a Traveller who was prevented from taking the Cruise by a force majeure event or who has died, and who were meant to be travelling with them.

10.7 A Traveller who does not present themselves at the departure of a Service, or who finds themselves unable to depart, or decides not to depart for any reason whatsoever, including due to a connection delay, cannot claim any refund.

10.8 Once the Services have begun, the Traveller shall be required to pay the full price of the Contract, regardless of the reason that may lead them to decide to waive it.

11. Cancellation, interruption, or alteration of the Contract by CDP

11.1 The arrival and departure times are provided for information purposes and are not definitive. In its capacity as the Organiser of the Cruise, and/or the Carrier, and/or the Vendor of a Package, CDP cannot guarantee that the times will fit in with (air plane and train, etc.) connection timetables.

11.2 CDP may assign travellers different cabins than those initially provided for.

11.3 CDP reserves the right to interrupt a Cruise or to change its itinerary for any reason that it shall consider valid; in this case, CDP cannot be held liable for any loss or harm.

11.4 Specifically in the event of adverse weather conditions, or due to the political or social situation in a part of call country, or due to any other event that may endanger the safety of the Travellers, property, or the ship, or in the event of orders imposed by public authorities, the Organiser of the Cruise, and/or the Carrier, and/or CDP shall have the option to change the itinerary or the ports of call or destination, to delay the trip or to end it, to divert the ship, to tow another ship or to be towed, to transfer the Travellers and their luggage to any other means of transport, even if such transfer results in extending or shortening the length of the programme.

11.5 The ship may provide assistance to any person or property at sea under all circumstances, and cannot be held liable for the consequences of a change to the Cruise programme for that reason.

11.6 Where CDP is required to alter the Cruise after the Travellers have embarked for reasons beyond its control, the Travellers cannot claim any compensation other than the refund of the Services that were not provided and not replaced, or of the unused portion of the Tickets less any expenses incurred, from either CDP, the Carrier, or the Organiser of the Cruise. Conversely, CDP may ask the Travellers to pay a price supplement corresponding to the additional services provided to the Travellers due to an extension of the trip.

11.7 In the case of external events beyond the control of the Organiser of the Cruise, and/or the Carrier, and/or CDP, or for any reason relating to the safety of the Travellers, or of the ship, or due to an insufficient number of participants, CDP may cancel the Cruise, and must inform the Travellers and/or the Organiser of the Cruise, where applicable, by registered letter with acknowledgement of receipt, or via e-mail, or via a press release.

11.8 CDP's Cruises and other Services are subject to a minimum number of participants.

11.8.1 CDP reserves the right to cancel a Cruise up to 21 days prior to departure if the minimum number of Travellers registered is less than or equal to 50% of the ship's "passenger capacity" (200 Passengers for the Expedition Cruise programs, 244 passengers for the other Cruises on board L'Austral, Le Boréal, Le Lyril and Le Soléal, 172 passengers on board the PONANT EXPLORERS ships, 55 passengers for the Le Ponant Yacht and 270 passengers for Le Commandant-Charcot).

11.8.2 CDP reserves the right to cancel any other service other than the Cruise if the number of Passengers is less than 20 participants (unless specified otherwise).

11.9 Where CDP is the Organiser of the Cruise, and regardless of the reason for the cancellation, no compensation shall be payable to the Traveller, who shall have a choice between the following solutions: (i) The full refund of the price of the Contract, (ii) another Service at an identical price, (iii) a Service at a lower price, and the refund of the difference in price between the two Services on the basis of the published prices. Travellers must inform CDP of their choice as soon as possible, and in any event prior to the cut-off date mentioned in the cancellation documents.

11.10 The means of transport that are the subject of the Services shall be reserved by CDP in accordance with the terms and conditions of each operator who provides these services. CDP reserves the right to substitute one means of transport for another, or one hotel for another in the same category. In the second case, if the hotel is in a lower category, the excess amount paid shall be refunded to the Travellers.

11.11 All the Services shall be offered within the limit of the places available. If there is no more room in the category proposed, CDP may offer additional places in exchange for a price supplement, depending on availability.

12. Liability

12.1 Where it acts in the capacity of a Sea Carrier, CDP shall be liable for any harm caused to Travellers in accordance with the provisions and compensation limits provided for in the following legislation, depending on their respective scopes of application, namely Articles L. 5421-1 to 5421-8 of the French Transport Code, and (EC) Regulation 392/2009 issued by the European Parliament and Council on 23 April 2009. Where this Regulation is applicable, the compensation limits assigned to the Carrier in the event of death or bodily harm amount to 400,000 drawing rights per Traveller and per event.

12.2 Where it acts in the capacity of a Sea Carrier, CDP shall be liable for any damage caused to luggage in accordance with the provisions and compensation limits provided for in the following legislation, depending on their respective scopes of application, namely Articles L. 5421-9 to 5421-12 of the French Transport Code, Decree No. 67-268 of 23 March 1967, as amended by Decree No. 86-1065 24 September 1986, and (EC) Regulation 392/2009 issued by the European Parliament and Council on 23 April 2009. Where this Regulation is applicable, the compensation limits assigned to the Carrier in the event of loss of or damage to luggage shall be 2,250 special drawing rights for each passenger and trip, while an excess of 149 special drawing rights per Traveller shall be applied in any event. Where (EC) Regulation 392/2009 does not apply, the maximum compensation for loss of or damage to luggage payable by the Carrier shall be €1,520 per Traveller and per trip.

12.3 In any event, where it acts in the capacity of a Sea Carrier, CDP shall benefit from the compensation limits included in the London International Convention of 19 November 1976, as amended by the 1996 Protocol; these limits shall prevail over any other limits determined by legislation where the application is not mandatory.

12.4 Where it operates as the Organiser of the Cruise, CDP shall be liable for any bodily harm or damage to property that occurs on board the ship or in its ancillary facilities or vessels during embarkation or disembarkation, or that occurs during carriage at sea within the same limits and under the same conditions as the Carrier. Where this damage or injury occurs outside such circumstances, but between the beginning and the end of the cruise, the compensation potentially payable to the Traveller by the Organiser of the Cruise and/or CDP shall be capped at 50% of the price of the Cruise.

12.5 Where it is involved in the capacity of the vendor of a fixed-price travel package within the meaning of the French Tourism Code, CDP shall be responsible for any harm or damage caused to Travellers or their luggage within the limits and conditions specified in Article L. 211-16 of said Code.

CDP's liability may specifically not be engaged in relation to the consequences of the following events:

- a) Loss or theft of the Tickets, failure to present the correct documents, or presentation of identity or health documents that are out of date or where the validity period is insufficient (identity card, passport, visas, and vaccination certificates, etc.), or that do not comply with the instructions mentioned in the documents delivered to the Traveller;
- b) unforeseeable and unavoidable incidents or events that affect a third party to the travel contract (force majeure events). Where a cancellation is required by circumstances that have the nature of a force majeure event and/or for reasons relating to the security of Travellers, and/or as the result of an injunction issued by a French or foreign administrative authority.

12.6 CDP's liability in its capacity as the Organiser of the Cruise, and/or the Carrier, and/or the Vendor of a Package shall be expressly excluded in the case of non-pecuniary losses, loss of enjoyment and so-called punitive and/or similar damages.

12.7 Where a Traveller is not allowed to embark on the ship – including after of during a port call – under the conditions mentioned in Articles 6, neither CDP, in its capacity as Organiser of the Cruise, and/or the Carrier, and/or the Vendor of a Package, nor the Captain of the ship, nor the crew shall be held liable on any grounds whatsoever.

12.8 CDP shall not be held liable for bodily harm, or damage to property or non-physical damage caused by wars, blockades, riots, strikes, social conflicts, acts of piracy or terrorism, epidemics or periods of quarantine, natural disasters and catastrophes, nuclear fusion, fission, pollution or explosion or its consequences, the closure of the port of departure, of call, or destination, the impounding, requisition, or seizure of the ship for whatever reason, the use of the ship for special Government purposes, or due simply to the threat of the above events. Moreover, it shall not be held liable for any harm caused by the Traveller's deliberate involvement in an affray or in a hazardous activity or action that was not rendered necessary in order to safeguard human life.

12.9 CDP shall not be held liable under any circumstances for any damage caused by the interruption and/or the alteration of the trip as the result of a force majeure event, including, wars, blockades, riots, strikes, social conflicts, acts of piracy or terrorism, epidemics or periods of quarantine, natural disasters and catastrophes, nuclear fusion, fission, pollution or explosion or its consequences, the closure of the port of departure, of call, or destination, the impounding, requisition, or seizure of the ship for whatever reason, the use of the ship for special Government purposes, or due simply to the threat of the above events.

12.10 In the event that CDP is responsible for transporting luggage during a period prior or subsequent to the disembarkation of the ship in its capacity as the Organiser of the Cruise, and/or the Carrier, and/or the Vendor of a Package, it shall act as a representative on the Traveller's behalf, and its liability shall not replace the liability of the carriers who are effectively responsible for transporting the luggage.

12.11 Luggage that is not claimed at the time when the ship or any other means of transport arrives shall remain at the port at the Travellers' expense and at their own risk.

12.12 Any delay in delivering the luggage that inconveniences the Traveller may only give rise to the payment of a compensation amount that cannot exceed 20% of the amount that would be payable in the event of the loss of the luggage stowed in the hold under the terms of Article 12.2. CDP reserves a period of 3 (three) months to look for lost luggage.

12.13 Unless a specific written contractual agreement is in place, ground or air transport, Transfers, water sports and scuba diving from the deck, services included in the Pre-and Post-Cruise Services, Excursions and/or Extensions, excursions on land, including, where applicable, the booking of hotels and restaurants and guided tours when booked from the ship with CDP and invoiced by the latter, are supplied by independent service providers who are neither representatives nor employees of the Organiser of the Cruise, the Carrier, the Vendor of the Package, and/or CDP. Travellers shall use these services at their own risk, and CDP shall only be involved as an intermediary, in its capacity as the Organiser of the Cruise, the Carrier, and/or the Vendor of the Package, and shall not assume or engage any liability for the services, regardless of whether such liability involves bodily harm or damage to property, cancellation, delay or a change of programme.

12.14 Any Traveller who takes part in outside activities as part of the Expedition Cruises agrees to take part in them in good faith and solely at their own risk. In this case, participation engages the liability of each participant, in terms of their physical fitness, their safety, their behaviour, and their comfort. Travellers' attendance at the information briefings provided on board is mandatory. The liability of CDP, its Managing Directors, Directors, officers, crew members, and expedition team members, and the activity leaders cannot be engaged in the event of loss or damage suffered while taking part in outside activities offered during Expedition Cruises under any circumstances.

13. Price reviews

13.1 The prices proposed by CDP are established in accordance with the economic conditions on the day when they are published. These economic conditions include, inter alia, the cost of transportation and fuel, the royalties and taxes relating to the services proposed (entry and/or exit duties in the countries visited, airport or port taxes, embarkation or disembarkation taxes, visa fees, and the cost of admission to tourist attractions), and the exchange rates used when setting the price of the programmes. CDP expressly reserves the right to review its prices. Any change in the cost of transportation and fuel, in taxes, royalties, in the euro and US dollar exchange rates, or special drawing rights and visa fees shall be fully reflected in the price of the trips, including travel agents' commissions, where applicable. Where the French Tourism Code applies, CDP also has the option to lower the Price pursuant to Article L. 211-12 of said Code, on the understanding that, in this case, no pricing review may occur less than 30 business days prior to the scheduled departure date.

13.2 Where the French Tourism Code applies, Travellers shall be informed of any increase in the Price via registered letter with acknowledgement of receipt – or via any other means as long as it enables the effective receipt of the correspondence to be proved – on the basis of a notice period of 30 (30) days prior to the departure date. When they receive this notice, the Passenger and/or the purchaser of the Ticket(s) may cancel their contract and receive an immediate refund of the amount paid by informing the Vendor in writing within a period of 7 (seven) days following receipt of the notice of the price increase.

Any daily surcharge (S) in the case of cruise services only shall be calculated as follows:

$S = [(change\ in\ the\ price\ of\ MDO \times X\ MDO\ daily\ consumption^{**}) / Capacity\ of\ the\ ship^{***}] \times Duration\ of\ cruising\ with\ MDO + [(change\ in\ the\ price\ of\ LNG \times X\ LNG\ daily\ consumption^{**} + change\ in\ the\ price\ of\ MDO \times X\ MDO\ daily\ consumption^{**}/k^{**}) / Capacity\ of\ the\ ship^{***}] \times Duration\ of\ cruising\ with\ LNG$
(*) : MDO : Gasoil 0,1 FOB Rotterdam barge in US\$
LNG for Northern Hemisphere cruises: TTF + 2.5 \$/mmbtu converted in Metric Tons with Low Calorific Value of LNG = 46 MJ/kg, where 2.5\$/MMBtu corresponds to the LNG terminal tolling cost + bunkering cost in Rotterdam area.

LNG for Southern Hemisphere cruises: Henry Hub + 7 \$/mmbtu converted in Metric Tons with Low Calorific Value of LNG = 46 MJ/kg, where 7\$/mmbtu corresponds to the liquefaction costs to the liquefaction plant + liquefaction cost + shipping cost + tolling cost + bunkering cost.
(**) : L'Austral, Le Boréal, Le Soléal and Le Lyrial: 20 tonnes; Le Ponant: 5.5 tonnes; PONANT EXPLORERS ships: 15 tonnes; Le Commandant-Charcot: LNG 36 tonnes, MDO 43 tonnes, k=72
(***) : L'Austral, Le Boréal, Le Soléal and Le Lyrial: 200 for Expedition Cruises and 244 for the other programmes; Le Ponant: 55; PONANT EXPLORERS ships: 172; Le Commandant-Charcot: 270 in Northern Hemisphere and 200 in Southern Hemisphere.

14. Travel Insurance

14.1 The sale of the Services by CDP does not include any kind of insurance.

14.2 CDP requests that all Travellers have comprehensive and adequate travel insurance in place prior to departing on any Trip, against the risks of cancellation, and in the event of assistance, repatriation, damage to and loss of their luggage, and medical expenses. A confirmation of that insurance must be provided to CDP prior to departure. The Travellers will be responsible for arranging such insurance themselves, at their cost. CDP proposes an insurance contract with extensive guarantees to be subscribed at the time when the Contract is Signed, please contact us for more information. If a Traveller does not have this comprehensive and adequate travel insurance, the Traveller accepts the liability and costs associated with medical expenses, a medicare or repatriation procedure. For some specific cruises, CDP could ask Travellers that do not have travel insurance to sign a waiver document.

15. After-sales

15.1 Any comment or claim relating to a trip or stay must be sent by registered letter with acknowledgement of receipt, clearly specifying the alleged incident and loss, to either Compagnie du Ponant - 408 avenue du Prado 13008 Marseille, if the Traveller signed their Contract directly with CDP, or to the travel agency that sold them the Services, within a period of one month following the date of their return, subject to the statute of limitations. CDP encourages passengers to fill in the satisfaction questionnaires delivered on board the ship at the end of the Cruise.

15.2 Once they have contacted the After-Sales Departments mentioned in Article 15.1, and failing a satisfactory reply within a period of 60 days, the Traveller may contact the French Tourism and Travel Mediator, whose details and contact methods are available on the following website: www.mtv.travel.

15.3 Any proceedings initiated by the Traveller against CDP in its capacity as the Organiser of the Cruise, and/or the Carrier must be initiated within a period of 1 (one) year for damage to property and of 2 (two) years for bodily harm, subject to the statute of limitations as from the date when the Traveller disembarked or should have disembarked.

15.4 The statute of limitations for any proceedings against CDP in its capacity as the vendor of a Package shall expire within the timeframe specified by Articles 2224 and 2226 of the French Civil Code.

16. Applicable law & Jurisdiction

16.1 This Contract is governed by French law.

16.2 Only the courts in the area of the Marseille District Court, France, have jurisdiction to hear any proceedings initiated against CDP, its employees, subsidiaries, or sub-contractors, even in the event that third parties are involved.

17. Excerpt from the French Tourism Code

The information contained in CDP's hard-copy brochures and on the company's website is the prior information provided to the Traveller and provided for by Article L. 211-9 of the French Tourism Code. However, in accordance with Article R. 211-5 of the French Tourism Code, Compagnie du Ponant expressly reserves the right to alter certain items prior to the signing of the Contract.

Excerpt from the French Tourism Code determining the conditions for performance of the activities relating to the organisation and sale of trips or stays:

Article R. 211-3: Subject to the exclusions provided for in the third and fourth sub-paragraphs of Article L. 211-7, any offer and sale of travel or accommodation services shall give rise to the delivery of appropriate documents that comply with the rules determined in this section.

In the event of the sale of airline travel tickets or tickets for travel on a regular shipping line, which does not include services relating to this transportation, the vendors shall deliver one or several passenger tickets for the entire trip to the purchaser, issued by the carrier or under their responsibility. In the event of on-request transportation, the name and the address of the carrier on behalf of whom the tickets are issued must be mentioned.

The separate invoicing of the various components of the same travel package shall not release the vendor from the obligations incumbent on them as a result of the regulatory provisions in this section.

Article R. 211-3-1: The exchange of pre-contractual information on the availability of contractual terms shall be in writing. This process may take place via e-mail under the validity and performance conditions provided for in Articles 1369-1 to 1369-11 of the French Civil Code. The vendor's name or company name and their address shall be mentioned, together with the number relating to their registration on the register provided for under Sub-Paragraph a) of Article L. 141-3, or, where applicable, their name, address and a number relating to their registration with the association or union mentioned in the second sub-paragraph of Article R. 211-2.

Article R. 211-4: The vendor or must disclose information on the price, dates, and the other components of the services provided at the time of the trip or the stay to the consumer prior to the signing of the contract; this information shall include:

- 1) The destination, the means, the characteristic features, and the categories of transport used; 2) The accommodation type, its location, its level of comfort and its main characteristic features, its accreditation and its tourism classification in accordance with the regulations or practices of the host country;
- 3) The catering services provided;
- 4) A description of the itinerary where a tour is involved;
- 5) The administrative and health formalities to be performed by French nationals or by nationals of another EU Member State, or of a State that is party to the European Economic Area Agreement, specifically in the event that the crossing of borders is involved, together with the timeframe for performing those formalities;
- 6) The tours, excursions, and other services included in the fixed-price, or that may be available in exchange for a price supplement;
- 7) The minimum or maximum size of the group that will enable the trip or stay to go ahead, as well as the cut-off date for informing the consumer in the event that the trip or stay is cancelled, if the trip or stay going ahead is dependent on a minimum number of participants; that date cannot be set at less than twenty-one days prior to the departure date;
- 8) The amount or the percentage of the price payable as an advance on signing of the contract, as well as the timetable for payment of the balance;
- 9) The terms and conditions for price reviews, as provided for by the contract, pursuant to Article R. 211-8;
- 10) The contractual cancellation terms and conditions; 11) The cancellation terms and conditions set out in Articles R. 211-9, R. 211-10, and R. 211-8;
- 12) The information relating to optional subscription to an insurance policy covering the consequences of certain cancellation events, or to an assistance policy covering certain specific risks, including repatriation expenses in the event of an accident or illness;
- 13) Where the contract includes air transport services, the information for each leg of the flight, as provided for in Articles R. 211-15 to R. 211-18.

Article R. 211-5: The prior information provided to the consumer shall commit the vendor, unless the vendor specifically has the right to alter certain aspects of that information. In that case, the vendor must clearly specify the extent of that alteration, and which aspects it covers.

In any event, any alterations made to the prior information must be disclosed to the consumer prior to the signing of the contract.

Article R. 211-6: The contract entered into by the vendor and the purchaser must be in writing, and drawn up in two copies, one of which shall be given to the purchaser, and signed by both parties. Where the contract is entered into via electronic means, Articles 1369-1 to 1369-11 of the French Civil Code shall apply. The contract must include the following clauses:

- 1) the name and address of the vendor, their guarantor and their insurance company, together with the name and address of the organiser;
- 2) the trip destination or destinations, and the various periods and their dates in the event of a segmented trip;
- 3) the means of transport used, and their characteristic features and categories, and the departure and return dates and locations;
- 4) the accommodation type, its location, comfort level and main characteristic features, and its tourism classification pursuant to the regulations or practices of the host country;
- 5) the catering services provided;
- 6) the itinerary where a tour is involved;
- 7) the tours, excursions or other services included in the total price of the trip or stay;
- 8) the total price of the services invoiced, together with an indication of any potential review of that invoice pursuant to the provisions of Article R. 211-8;
- 9) an indication, where necessary, of the royalties or taxes relating to certain services such as landing disembarkation or embarkation taxes at ports and airports, and hotel taxes when they are not included in the price of the service or services provided;
- 10) the timetable and procedures for payment of the price; the final payment made by the purchaser cannot be less than 30% of the price of the trip or stay, and must be made at the time when the documents enabling the trip or stay to take place are delivered;
- 11) the special terms and conditions requested by the purchaser and accepted by the vendor;
- 12) the procedures according to which the purchaser may lodge a claim against the vendor on the grounds of their failure to execute, or their poor execution of the contract; this claim must be made as soon as possible, via any means that enables an acknowledgement of receipt by the vendor to be obtained (fax, e-mail, or registered letter with acknowledgement of receipt), and, where applicable, mentioned in writing to the organiser of the trip and to the service provider concerned;
- 13) the cut-off date for informing the purchaser in the event that the trip or stay is cancelled by the vendor if the trip or stay going ahead is dependent on a minimum number of participants, in accordance with the provisions of Sub-Paragraph 7) of Article R. 211-4;
- 14) the contractual cancellation terms and conditions;
- 15) the cancellation conditions provided for in Articles R. 211-9, R. 211-10, and R. 211-11;
- 16) further information regarding the risks covered, and the amount of the cover provided by the insurance policy covering the consequences of the vendor's professional third-party liability;
- 17) information regarding the insurance policy covering the consequences of certain cancellation cases subscribed by the purchaser (policy number and name of the insurance company), together with the information regarding the assistance policy covering certain specific risks, including repatriation expenses in the event of an accident or illness; in this case, the vendor must give the purchaser a document specifying the risks covered and the risks excluded, at the very least;
- 18) the cut-off date for informing the vendor in the event that the purchaser transfers the contract;
- 19) an undertaking to provide the following information to the purchaser, at least 10 days prior to their scheduled departure date:
 - a) the name, address, and telephone number of the vendor's local representative, or else, the names, addresses, and telephone numbers of local organisations likely to assist the consumer in the event of a problem, or else the telephone number enabling emergency contact to be made with the vendor;
 - b) in the event of trips and stays abroad involving minors, a telephone number and an address that enables direct contact with the child or the person in situ responsible for their stay to be established;
- 20) the clause governing the cancellation and refund, free of charge, of the amounts paid by the purchaser in the event of non-compliance with the information obligation provided for in Sub-Paragraph 13) of Article R. 211-4;
- 21) the undertaking to inform the purchaser of the departure and arrival times in good time prior to the beginning of the trip or the state.

Article R. 211-7: The purchaser may transfer their contract for the trip or stay to a transferee who meets the same conditions as them, as long as the contract has not taken effect. Unless the transferor benefits from a more favourable clause, they are required to inform the vendor of their decision via any means that enables an acknowledgement of receipt to be obtained (fax, e-mail, or registered letter with acknowledgement of receipt) at least seven days prior to the beginning of the trip. This deadline shall be extended to 15 days where it involves a cruise. This transfer shall not be subject to prior authorisation by the vendor under any circumstances.

Article R. 211-8: Where the contract includes an express price review option, within the limits provided for in Article L. 211-12, it must mention the specific calculation procedures for the price changes, in the case of both increases and decreases, and specifically the amount of the transportation expenses and related taxes, the currency or currencies that may have an impact on the price of the trip or the stay, the portion of the price to which the change applies, and the exchange rate for the currency or currencies used as a benchmark when determining the price shown in the contract.

Article R. 211-9: Where the vendor finds themselves required to alter one of the key aspects of the contract prior to the purchaser's departure, such as by significantly increasing the price, and where they ignore the information obligation mentioned in Sub-Paragraph 13) of Article R. 211-4, the purchaser may take the following measures, without prejudice to any appeals for compensation for the loss that they may suffer, and once they have been informed by the vendor via any means that enables an acknowledgement of receipt to be obtained (fax, e-mail, or registered letter with acknowledgement of receipt, etc.):

- either cancel the contract and obtain immediate repayment of the amounts paid with no penalty;
- or accept the change or the substitute trip proposed by the vendor; in that case, an amendment to the contract specifying the alterations made shall then be signed by the parties; any price decrease shall be deducted from the amounts that may remain payable by the purchaser, and if the payment already made by the latter exceeds the price of the altered service, the excess amount must be returned to them prior to their departure date.

Article R. 211-10: In the event provided for in Article L. 211-14, where the vendor cancels the trip or the stay prior to the purchaser's departure, they must inform the purchaser via any means that enables an acknowledgement of receipt to be obtained (fax, e-mail, or registered letter with acknowledgement of receipt, etc.); the purchaser shall then obtain immediate repayment of the amounts paid from the vendor without any penalty, without prejudice to any claims for compensation for any loss that they may have suffered; in this case, the purchaser shall receive a compensation amount that is at least equal to the penalty that they would have paid if they had been responsible for the cancellation on this date. The provisions of this article shall not prevent the reaching of an amicable agreement with a view to the purchaser accepting a replacement trip or stay offered by the vendor under any circumstances.

Article R. 211-11: Where the vendor finds themselves unable to provide a major portion of the services provided for in the agreement, and which account for a significant percentage of the price paid by the purchaser after the latter's departure, the vendor must immediately take the following measures, without prejudice to the claims for compensation for any losses that may have been suffered:

- either offer services as a replacement for the services provided for, and potentially bear any additional cost, and, if the services accepted by the purchaser are of a lower quality, the vendor must refund the price difference to them as soon as they return;
- or, if they cannot offer any replacement service, or if that service is refused by the purchaser on valid grounds, provide the purchaser with transportation tickets enabling them to return to their place of departure under conditions that may be considered as equivalent, or to another place agreed by both parties, at no additional cost. The provisions of this article shall apply in the event of non-compliance with the obligation provided for in Sub-Paragraph 13) of Article R. 211-4.

Article R. 211-12: The provisions of Articles R. 211-3 to R. 211-11 must be included in the brochures and the travel contracts offered by the persons mentioned in Article L. 211-1.

Article R. 211-13: The purchaser can no longer claim the benefit of the clause provided for under Sub-Paragraph 20) of Article R. 211-61 once the service has been provided.

Particular Terms and Conditions of Sale

1 - The rates of our cruises are per person and include the following:

- All meals while on board the ship (from dinner on the day of embarkation to breakfast on the day of disembarkation)
- Captain's welcome cocktail and gala dinner
- "Open Bar" (pouring wines, house champagne, alcohol except premium brands...list available upon request)
- Evening entertainment and events
- Room service 24h (special selection)
- Highly qualified bilingual French/English expedition team on all cruises identified by "Expedition" logo
- English speaking lecturer on selected sailings identified by "lecturer on board" logo
- English speaking golf escort on selected sailings identified by "golf cruise" logo
- English speaking dive master on selected sailings identified by "dive on board" logo
- Water sports activities (except scuba diving) using the ship's equipment, when permitted by local authorities and confirmed by ship Master according to safety and sea conditions onsite
- Park entry fees into protected areas
- Free and unlimited Internet WiFi access on board

1-1 Our "Hotel, flights", cruise and transfers" program rates are per person and also include:

• Ushuaia/Talcahuano cruise:

- 1-night stay in a 4*-star hotel in Buenos Aires (rooms available from late morning), dinner including beverage package, breakfast and transfer to the airport
- Flight Buenos Aires / Ushuaia
- Lunch in Ushuaia and transfer to the port in time for embarkation
- On disembarkation day, transfer to the airport of Concepción, flight Concepción /Santiago (Chile)
- In case of the Traveller's opposition, prior to the Signing of the Contract, to the Hotel, Flights & Transfers Service included in the Fixed-rate Package, a penalty fee of 30% of the Service amount excluding taxes will be charged to the Traveller.
- Complimentary boot rental (except for guarantee deposit)
- Complimentary polar parka for you to keep (children sizes not available)
- * All flights indicated and included in the cruise package are in economy class.

1-2 Our "Cruise, Flights" and Transfers" programme rates are per person and also include:

• Talcahuano/Ushuaia cruise¹⁾:

- On embarkation day, flight Santiago (Chile) /Concepción, transfer to the port of Talcahuano.
- On disembarkation day, direct transfer from the ship to the airport. Flight Ushuaia/Buenos Aires
- (1) Complimentary boot rental (except for guarantee deposit)
- (1) Complimentary polar parka for you to keep (no children sizes available)

• Guayaquil/Talcahuano and Callao /Talcahuano cruises:

- On disembarkation day, transfer to the airport of Concepción, flight Concepción /Santiago (Chile)
- In case of the Traveller's opposition, prior to the Signing of the Contract, to the Flights & Transfers Service included in the Fixed-rate Package, a penalty fee of 30% of the Service amount excluding taxes will be charged to the Traveller.

¹⁾Those flights are being studied and are subject to change until the flight plan is confirmed and this up to 2 months prior to each cruise. All flights indicated and included in the cruise package are in economy class.

2 - Our cruise rates do not include:

- The optional excursion "Tierra del Fuego National Park" on embarkation days in Ushuaia. This excursion must be prebooked and paid at least 3 months prior to departure.
- Any ground services before and/or after the cruise other than the ones mentioned in each "Cruise, Hotel, Flights & Transfers" package and for which details are available upon request. Don't hesitate to contact your travel agent or consult www.ponant.com
- The optional pre and post cruise programs, overlands and excursions presented in the brochure and on www.ponant.com
- Visa expenses (which may include additional administrative charges imposed by the authorities of a country) and/or immigration reciprocity taxes if applicable.
- Gratuities to onboard crew, local guides and drivers
- Luggage handling
- Optional Spa package to be booked prior your departure
- Beverages other than the ones mentioned
- Laundry services, hair salon and à la carte Spa treatments
- Personal expenses, on board medical consultations and drug prescriptions
- Cancellation/luggage/assistance/repatriation/medical insurance(s)
- Dives when authorized by local authorities and feasible with ship equipment and Zodiacs®. Rates: €70 per standard dive; €80 per dive when local equipment or staff must be used, €80 for a "discover scuba dive" course, on some cruises a dive package might be on offer. In order to participate to diving sessions, guests must have with them a medical certificate less than 1-year-old and their up to date dive book.

3 - Ground services

Ground services in the port of departure, transfers to the ship, including, as applicable, hotel room and restaurant bookings or guided tours, are performed by independent suppliers who are not employees of Compagnie du Ponant. In this respect, Compagnie du Ponant acts only as an agent and shall not be held liable for said services or for the acts or omissions of sub-contractors or other contractors. The passenger agrees that Compagnie du Ponant acts as agent and/or trustee for any person including ground and maritime agents and subcontractors, who provide any service forming, or in connection with, any part of the cruise.

Our Cruise and Flights package programs are made in connection with Compagnie du Ponant selected regular or private charter flights. Final timings and schedule of the day by day program will be communicated with the cruise ticket. All our programs are based on economy class air and according to number of seats available. If the class is not available anymore, we will suggest, depending on the availability, extra seats with a supplement.

On International flights, check-in luggage is limited to 23kg/50lbs and 8kg/11 to 17lbs per person for carry-on luggage (besides airlines frequent flyer advantages). On regular domestic or intercontinental flights, check-in luggage limits are between 15 and 20 kg/33 to 44lbs and 5 to 8kg/11lbs per person for carry-on. On Compagnie du Ponant Private charter flights, check-in luggage is limited to 23 kg/50lbs and 5kg/11lbs maximum per person as carry-on. We thank you for taking these restrictions into account. Airline carriers charge for extra weight and sometimes refuse, for strict security reasons, to check-in overweight and oversized luggage. Compagnie du Ponant and the airline carriers waive all liability for luggage with extra weight that is refused at the check-in.

3-1 Services included in "Cruise, flights and Transfers" programmes and "Hotel, flights, cruise and transfers" programmes

These programmes include ground services before and/or after the cruise as described in documents available 15 months prior departure of each cruise and available on www.ponant.com. However, the complete details will only be made available once the flight times have been confirmed (approximately 2 months prior to departure).

3-2 Ground activities included during expedition cruises itself

By choosing an expedition cruise, passengers agree to follow the rules of good conduct presented by the expedition team during the cruise. We remind you that being properly equipped is essential (clothing, sunglasses, etc.) and we recommend bringing binoculars to enable you to observe the wildlife comfortably and respectfully during your excursions and shore visits.

3-3 Pre and post-cruise programs and pre bookable tours

Pre and Post-cruise programs (as detailed on www.ponant.com), pre bookable tours and shore excursions are performed by independent suppliers who are not employees of Compagnie du Ponant. In this respect, Compagnie du Ponant acts only as an agent and shall not be held liable for said services or for the acts or omissions of sub-contractors or other contractors. The passenger agrees that Compagnie du Ponant acts as agent and/or trustee for any person including ground and maritime agents and subcontractors, who provide any service forming, or in connection with, any part of the cruise.

Hotel accommodations are based on 4 and 5-star rated hotels. Official check-in time is 4pm, check-out time is 11am unless early check-in or late check-out supplement are paid.

Travellers are advised to check all the information with the authorities concerned prior to the departure date. CDP advises Travellers to consult the country factsheets relating to the chosen destinations. CDP specifically draws Travellers' attention to the fact that the information provided may change up until the departure date, and they are advised to consult that information up until the time of departure. CDP invites Travellers to adjust their behaviour to the visited country, to exercise vigilance and to avoid carrying valuable objects during their travel.

3-4 Shore excursions

Unless otherwise noted, shore excursions are sold and charged on board and are ruled by general conditions that apply to the contract signed with the local tour operator and the relevant national regulations. The passenger agrees that CDP acts as agent and/or trustee for any person including ground and maritime agents and subcontractors, who provide any service in connection with any part of the cruise.

Excursions can involve activities that may not suit persons with disabilities. Prices are only given as an indication and may change. Before departure, you will receive a tour program detailing the excursions on offer with the latest rates. Five months before cruise departure, shore excursions can also be viewed on www.ponant.com. Shore excursions are currently only bookable onboard. In the event of an excursion being cancelled due to a technical reason, shortage of participants or a case of force majeure, the client will not be charged and will not be eligible for any compensation. Please note that you will not be reimbursed for excursions if you cancel after registration. Any meals offered during excursions are simple and should not be compared to the standards on board the ship.

3-5 Shore excursions pre-reservations

On Yachting cruises, excursions and excursion packages can be pre-reserved starting 2 months prior to the cruise. If your cruise is eligible you will be notified by email and you can contact us for the pre-reservations. You can pre-reserve 1 shore excursion per day or per half day call and this up to 7 days prior to cruise departure. Your tour selection will be automatically charged onboard and your tour tickets delivered to your cabin. You may cancel your pre-reservations up to 48h prior to the tour departure. After that, you will be charged 100% of tour ticket.

All tours are subject to minimum and maximum participation. PONANT thanks you in advance for your understanding should we have to cancel a tour due to lack of participation or if the maximum number of participants has been reached.

Design your trip with PONANT



PONANT now gives you the option of customising your cruise and assists you with the entire process of designing your trip as soon as your booking has been made. We can design the trip that best suits your personality and wishes.

PONANT is your unique contact for the best possible travel experience:

- Your **cruise** and the various **shore excursions**
- Your **flights**, with a choice between different airlines and classes (with some offering special prices for our PONANT guests)
- Your **transfers** before/after your cruise between airport and embarkation/disembarkation port (private bespoke transfers are also possible)
- Your **pre- and post-cruise programmes** to extend your trip with total peace of mind.

Your budget is fully controlled thanks to our attractive prices; You receive only one invoice and your travel documents summarise all the information. For your safety and your comfort, you may wish to subscribe to our exclusive PONANT **insurance policy**.





Easy and convenient, for your comfort and peace of mind!

*For more information on our services,
contact our PONANT cruise advisers or your travel agency.*

INFORMATION & RESERVATIONS

UK: 0808 23 43 802 | Belgium: +32 (0)2 647 37 05
Switzerland: 0800 552 741 | Rest of the world: +33 4 91 16 16 27
Asian countries: reservations.apac@ponant.com
reservation@ponant.com

FOLLOW US ON SOCIAL MEDIA

 facebook.com/cruises.ponant  Instagram: @ponantcruises
 pinterest.com/ponantcruises  Youtube: PonantCruises
 Twitter: @ponant_cruises

RELEASE DATE: JUNE 2019



408 Avenue du Prado - 13008 Marseille - France

www.ponant.com

Licence 013060005

